

# MCR-SL-HT-PT 100-I - Head-mounted transducer



2864516

<https://www.phoenixcontact.com/us/products/2864516>

Please be informed that the data shown in this PDF document is generated from our online catalog. Please find the complete data in the user documentation. Our general terms of use for downloads are valid.



Measurement and control temperature transducer, for resistance thermometers, thermocouples, resistance-type sensors, and voltage sensors. For Pt 100 resistance temperature detectors.

## Your advantages

- Freely programmable via MCR/PI-CONF-WIN
- For installation in connecting head, form B
- Two-wire transmitter for Pt 100 resistance thermometers

## Commercial data

Item number	2864516
Packing unit	1 pc
Note	Made to order (non-returnable)
Sales key	C401
Product key	DK1142
GTIN	4017918893217
Weight per piece (including packing)	81.025 g
Weight per piece (excluding packing)	81.025 g
Customs tariff number	85437090
Country of origin	DE

2864516

<https://www.phoenixcontact.com/us/products/2864516>

## Technical data

### Product properties

Product type	Temperature transmitter
Configuration	Using MCR-PI-CONF-WIN configuration software package

### System properties

#### Functionality

Configuration	Using MCR-PI-CONF-WIN configuration software package
---------------	--

### Electrical properties

Switch-on delay	4 s
Step response (10-90%)	< 2 s
Transmission error resistance thermometer	0.2 K

#### Supply

Designation	Loop-powered
Supply voltage range	10 V DC ... 35 V DC
Max. current consumption	< 3.5 mA

### Input data

#### Signal

Input signal	Temperature
--------------	-------------

#### Measurement

Configurable/programmable	Yes, programmable
Sensor types (RTD) that can be used	Pt 100, minimum measurement range 10 K
Temperature measuring range: Pt 100	-200 °C ... 850 °C (freely adjustable)
Connection technology	2-, 3-, 4-conductor

### Output data

#### Frequency:

Configurable/programmable	no
---------------------------	----

#### Signal: Current output

Configurable/programmable	Yes
Current output signal	4 mA ... 20 mA 20 mA ... 4 mA
Output current with wire break	≤ 3.6 mA or ≥ 21 mA (adjustable)
Output current with short-circuit	≤ 3.6 mA or ≥ 21 mA (adjustable)
Output current range with overrange/underrange	≤ 20.5 mA / ≥ 3.8 mA (linear increase/decrease)
Output current limit	≤ 23 mA
Load/output load current output	max (V <sub>supply</sub> - 10 V) / 0.023 A (current output)

## Connection data

Connection method	Screw connection
Stripping length	8 mm
Screw thread	M3
Conductor cross-section rigid	0.2 mm <sup>2</sup> ... 1.75 mm <sup>2</sup>
Conductor cross-section flexible	0.2 mm <sup>2</sup> ... 1.75 mm <sup>2</sup>
Conductor cross-section AWG	24 ... 15

## Material specifications

Color	green (RAL 6021)
Housing material	PC

## Environmental and real-life conditions

### Ambient conditions

Degree of protection	IP00 IP54 (Installed in the connection head)
Ambient temperature (operation)	-40 °C ... 85 °C

## Approvals

### CE

Certificate	CE-compliant
-------------	--------------

### UL, USA/Canada

Identification	Class I, Div. 2, Groups A, B, C, D
----------------	------------------------------------

## EMC data

Noise immunity	EN 61326-1 (IEC 61326) and NAMUR NE 21
----------------	--

### Noise emission

Standards/regulations	EN 61326-1 (IEC 61326) and NAMUR NE 21
-----------------------	--

## Mounting

Assembly note	Connection head according to DIN 43729 form B
Mounting position	any

# MCR-SL-HT-PT 100-I - Head-mounted transducer

2864516

<https://www.phoenixcontact.com/us/products/2864516>



## Drawings

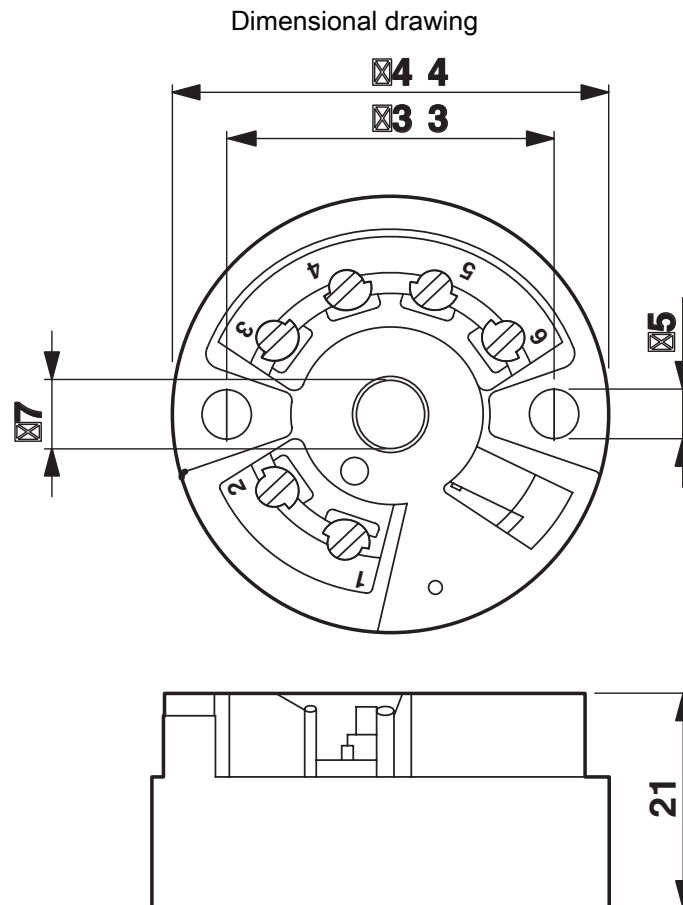

# MCR-SL-HT-PT 100-I - Head-mounted transducer

2864516

<https://www.phoenixcontact.com/us/products/2864516>



## Connection diagram

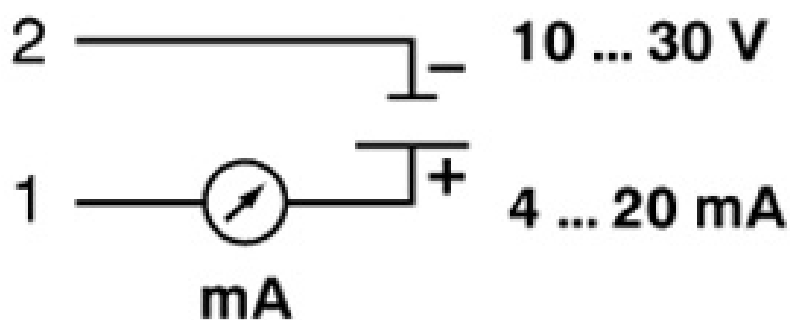
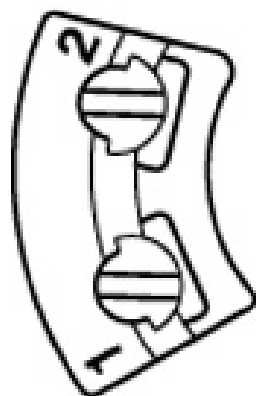

# MCR-SL-HT-PT 100-I - Head-mounted transducer



2864516

<https://www.phoenixcontact.com/us/products/2864516>

Circuit diagram

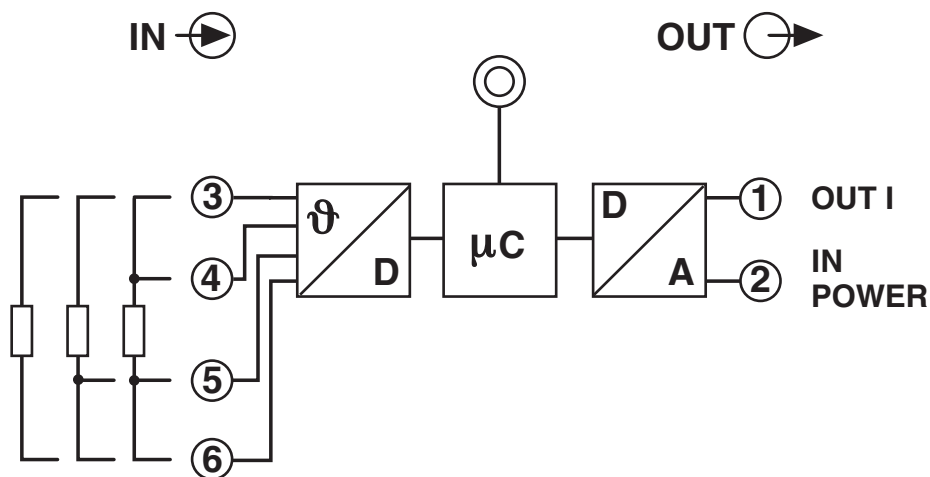

Block diagram

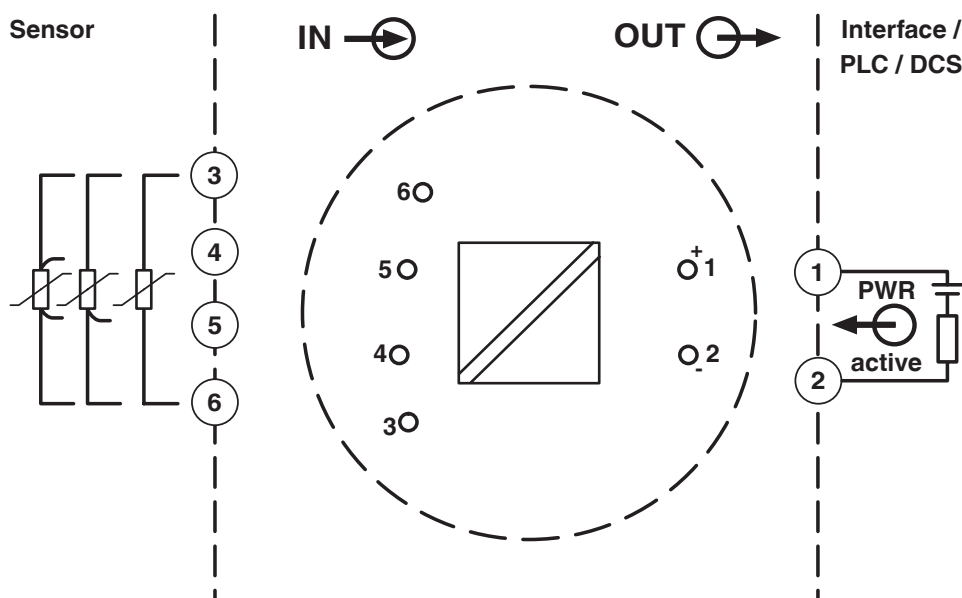

Block diagram MCR-SL-HT-PT 100-I

# MCR-SL-HT-PT 100-I - Head-mounted transducer



2864516

<https://www.phoenixcontact.com/us/products/2864516>

## Classifications

### UNSPSC

UNSPSC 21.0	41112105
-------------	----------

# MCR-SL-HT-PT 100-I - Head-mounted transducer



2864516

<https://www.phoenixcontact.com/us/products/2864516>

## Environmental product compliance

### EU RoHS

Fulfills EU RoHS substance requirements	Yes, No exemptions
---	--------------------

### China RoHS

Environment friendly use period (EFUP)	EFUP-E
	No hazardous substances above the limits

### EU REACH SVHC

REACH candidate substance (CAS No.)	No substance above 0.1 wt%
-------------------------------------	----------------------------

Phoenix Contact 2026 © - all rights reserved  
<https://www.phoenixcontact.com>

Phoenix Contact USA  
586 Fulling Mill Road  
Middletown, PA 17057, United States  
(+717) 944-1300  
[info@phoenixcon.com](mailto:info@phoenixcon.com)