

# HC-HS 6-ESTS-12 - Contact insert



1674574

<https://www.phoenixcontact.com/us/products/1674574>

Please be informed that the data shown in this PDF document is generated from our online catalog. Please find the complete data in the user documentation. Our general terms of use for downloads are valid.

HEAVYCON male insert, HS6 series, screw connection, numbering from 7-12



The figure shows version HC-HS 6-ESTS

## Commercial data

Item number	1674574
Packing unit	1 pc
Note	Made to order (non-returnable)
Sales key	BF61
Product key	AF7ABI
GTIN	4017918144685
Weight per piece (including packing)	99.3 g
Weight per piece (excluding packing)	95.83 g
Customs tariff number	85366990
Country of origin	DE

# HC-HS 6-ESTS-12 - Contact insert



1674574

<https://www.phoenixcontact.com/us/products/1674574>

## Technical data

### Mounting

Assembly note	Connectors may be operated only when there is no load/voltage.
---------------	--

### Product properties

Product type	Contact insert with a fixed no. of positions
Series	HC-HS
Type	B16 B32
Number of positions	6
Connection profile	6+PE
Contact numbering	7 - 12

### Insulation characteristics

Overvoltage category	III
Degree of pollution	3

### Dimensions

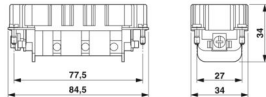
Dimensional drawing	
Width	34 mm
Height	34 mm
Length	84.5 mm
Drill hole distance, horizontal	77.5 mm

### Connection data

#### Connection technology

Connection technology	Screw connection
Connection in acc. with standard	IEC / EN

#### Conductor connection

Conductor cross-section	0.5 mm <sup>2</sup> ... 6 mm <sup>2</sup>
Connection cross section AWG	20 ... 10
Tightening torque	1.2 Nm
Stripping length of the individual wire	10 mm

### Electrical properties

Rated voltage (III/3)	500 V
Rated surge voltage	6 kV
Rated current	35 A

# HC-HS 6-ESTS-12 - Contact insert



1674574

<https://www.phoenixcontact.com/us/products/1674574>

## Mechanical properties

### Mechanical data

Insertion/withdrawal cycles	≥ 500
-----------------------------	-------

## Material specifications

Flammability rating according to UL 94	V0
Contact material	Copper alloy
Contact surface material	Ag
Contact carrier material	PA

## Environmental and real-life conditions

### Ambient conditions

Ambient temperature (operation)	-40 °C ... 125 °C (including heating up of contacts)
---------------------------------	--

## Standards and regulations

Constructional and testing regulations	DIN VDE 0627/86
	DIN VDE 0110/02.79
	DIN VDE 0110-1/04.97
	IEC 60664-1, DIN IEC 60512
Tests	DIN VDE 0627/86
	DIN VDE 0110/02.79
	DIN VDE 0110-1/04.97
	IEC 60664-1, DIN IEC 60512

# HC-HS 6-ESTS-12 - Contact insert

1674574

<https://www.phoenixcontact.com/us/products/1674574>

## Drawings

Dimensional drawing

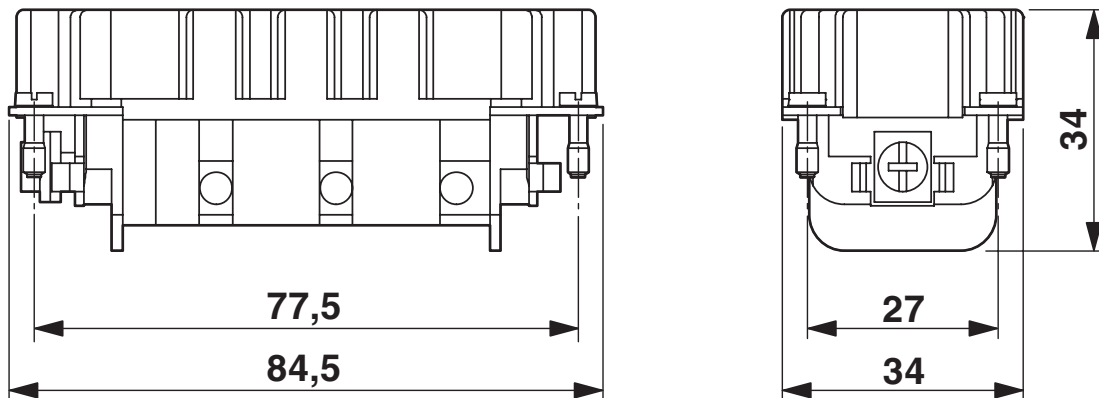

## Male insert

Dimensional drawing

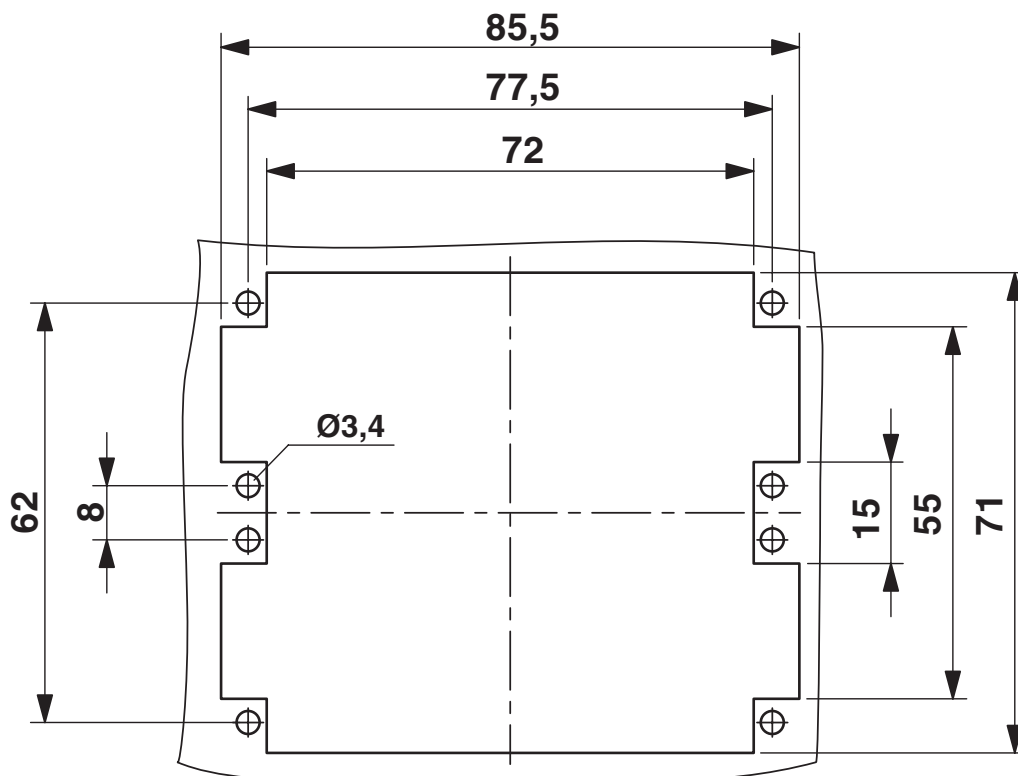

## Mounting cutout

# HC-HS 6-ESTS-12 - Contact insert

1674574

<https://www.phoenixcontact.com/us/products/1674574>

Schematic diagram

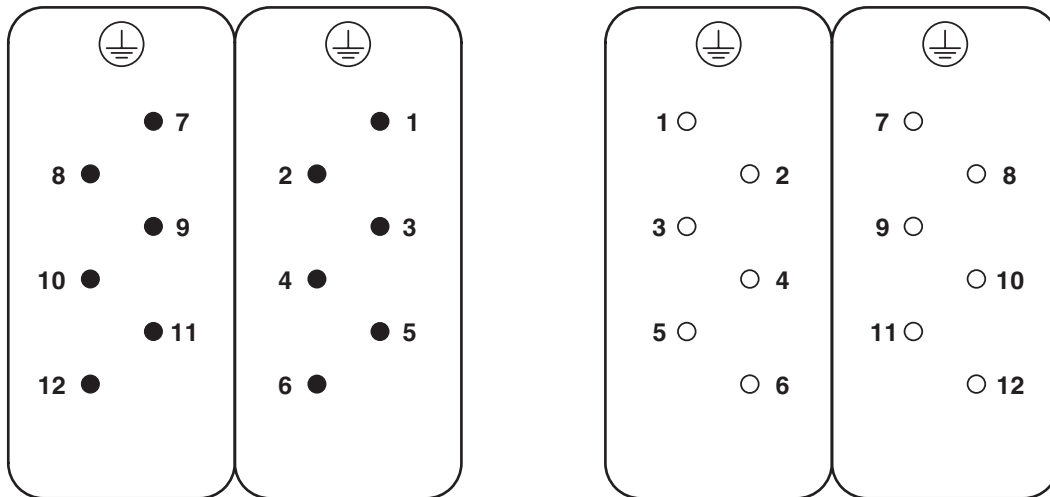

Connector pin assignment, connection side

Diagram

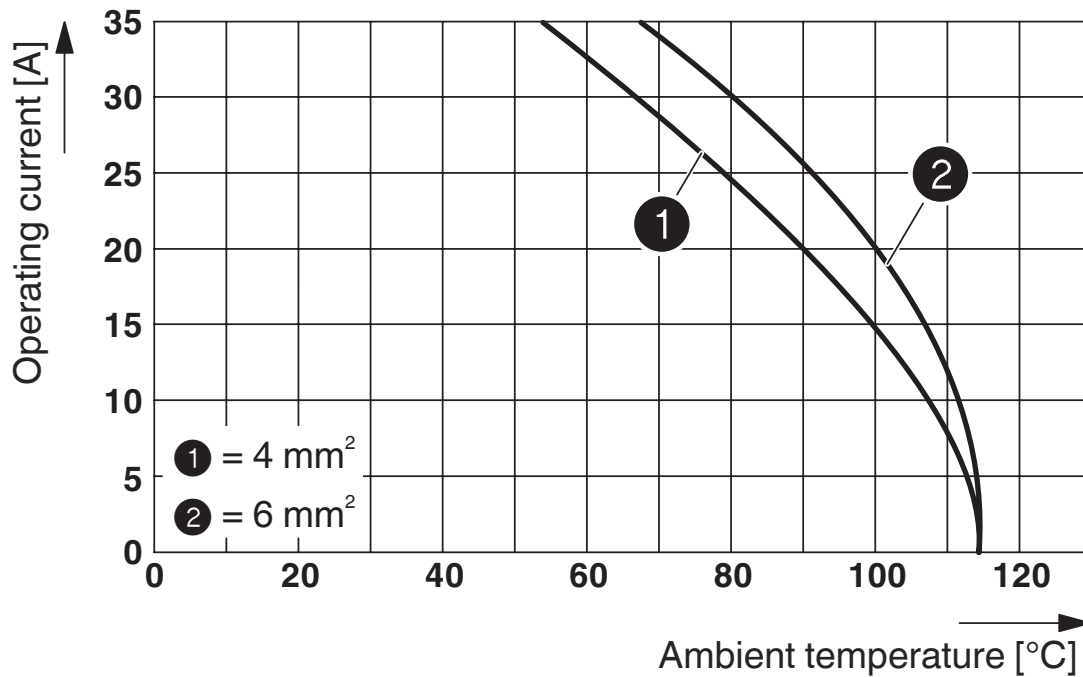

Derating diagram: HC-HS...S series

# HC-HS 6-ESTS-12 - Contact insert



1674574

<https://www.phoenixcontact.com/us/products/1674574>

## Classifications

### ECLASS

ECLASS-13.0	27440205
ECLASS-15.0	27440205

# HC-HS 6-ESTS-12 - Contact insert



1674574

<https://www.phoenixcontact.com/us/products/1674574>

## Environmental product compliance

### China RoHS

Environment friendly use period (EFUP)	EFUP-50
	An article-related China RoHS declaration table can be found in the download area for the respective article under "Manufacturer declaration". For all articles with EFUP-E, no China RoHS declaration table issued and required.

### EU REACH SVHC

REACH candidate substance (CAS No.)	No substance above 0.1 wt%
-------------------------------------	----------------------------

Phoenix Contact 2026 © - all rights reserved  
<https://www.phoenixcontact.com>

Phoenix Contact USA  
586 Fulling Mill Road  
Middletown, PA 17057, United States  
(+717) 944-1300  
[info@phoenixcon.com](mailto:info@phoenixcon.com)