

# EV-T2M3S-3AC32A-1,5M6,0E00 - Infrastructure charging socket



1627229

<https://www.phoenixcontact.com/us/products/1627229>

Please be informed that the data shown in this PDF document is generated from our online catalog. Please find the complete data in the user documentation. Our general terms of use for downloads are valid.



CHARX connect, Type 2, Infrastructure charging socket, 32 A , 480 V AC, Single-core wires connected at one end, length: 1.5 m, Front and rear mounting, for charging electric vehicles (EV) with alternating current (AC), PHOENIX CONTACT logo, IEC 62196-2, NOTE This product version does not include a locking actuator.

## Product description

Infrastructure charging socket for charging electric vehicles (EV) with alternating current (AC), compatible with type 2 Infrastructure Plugs, for installation at charging stations for E-Mobility (EVSE)

## Your advantages

- Complete product range
- Uniform, space-saving installation space
- Available with your logo on request - for consistent branding of your charging station
- Integrated interlock during charging
- Manual emergency release of the locking actuator
- Developed and produced in accordance with the IATF 16949 automotive standard and ISO 9001

## Commercial data

Item number	1627229
Packing unit	1 pc
Minimum order quantity	1 pc
Product key	XWBADC
GTIN	4055626313061
Weight per piece (including packing)	845 g
Weight per piece (excluding packing)	774 g
Country of origin	PL

# EV-T2M3S-3AC32A-1,5M6,0E00 - Infrastructure charging socket



1627229

<https://www.phoenixcontact.com/us/products/1627229>

## Technical data

### Notes

General	NOTE This product version does not include a locking actuator.
General	Make sure that the Infrastructure Plug is locked into the Infrastructure Socket Outlet during the charging process according to IEC 61851-1. We recommend using our locking actuators (1624129, 1622317). If another type of locking is selected, we recommend sealing the mounting surface (1621465), see also accessories.

### Product properties

Product type	Infrastructure charging socket
Product family	CHARX connect
Charging standard	Type 2
Charging mode	Mode 3, Case B
Affixed logo	PHOENIX CONTACT logo
Customer variations	On request

### Electrical properties

Type of signal transmission	Pulse width modulation
Note on the connection method	Crimp connection, cannot be disconnected

#### Charging power and current (AC charging, 3-phase)

Type of charging current	AC 3-phase
Charging current	32 A AC (3-phase)
Charging power	26.6 kW (3-phase)
Charging power rating	22 kW (32 A, 3-phase)
Rated voltage	480 V

#### Pin assignment (Power contacts)

Number	5 (L1, L2, L3, N, PE)
Rated voltage	480 V AC
Rated current	32 A

#### Pin assignment (Signal contacts)

Number	2 (CP, PP)
Rated voltage	30 V AC
Rated current	2 A

#### Locking actuator

Locking actuator	without locking actuator
------------------	--------------------------

### Cable/line

Cable length	1.5 m
--------------	-------

# EV-T2M3S-3AC32A-1,5M6,0E00 - Infrastructure charging socket



1627229

<https://www.phoenixcontact.com/us/products/1627229>

Cable type	Single-core wires connected at one end
Cable structure	5x 6.0 mm <sup>2</sup> + 2x 0.5 mm <sup>2</sup>

## Mechanical properties

### Mechanical data

Insertion/withdrawal cycles	> 10000
Insertion force	< 100 N
Withdrawal force	< 100 N

## Environmental and real-life conditions

### Ambient conditions

Degree of protection (Infrastructure charging socket)	IP44 (plugged in)
Degree of protection (Protective cover)	IP54 (see accessories)
Ambient temperature (operation)	-30 °C ... 50 °C
Ambient temperature (storage/transport)	-40 °C ... 80 °C
Altitude	5000 m (above sea level)

## Standards and regulations

### Standards

Standards/regulations	IEC 62196-2
-----------------------	-------------

## Mounting

Mounting type Infrastructure charging socket	Front and rear mounting (0 to 90 degree frontal inclination possible)
Mounting type Protective cover	front (available separately)
Mounting hole diameter	7.00 mm (ø)

# EV-T2M3S-3AC32A-1,5M6,0E00 - Infrastructure charging socket

1627229

<https://www.phoenixcontact.com/us/products/1627229>

## Drawings

Dimensional drawing



Hole image

# EV-T2M3S-3AC32A-1,5M6,0E00 - Infrastructure charging socket

1627229

<https://www.phoenixcontact.com/us/products/1627229>

Dimensional drawing

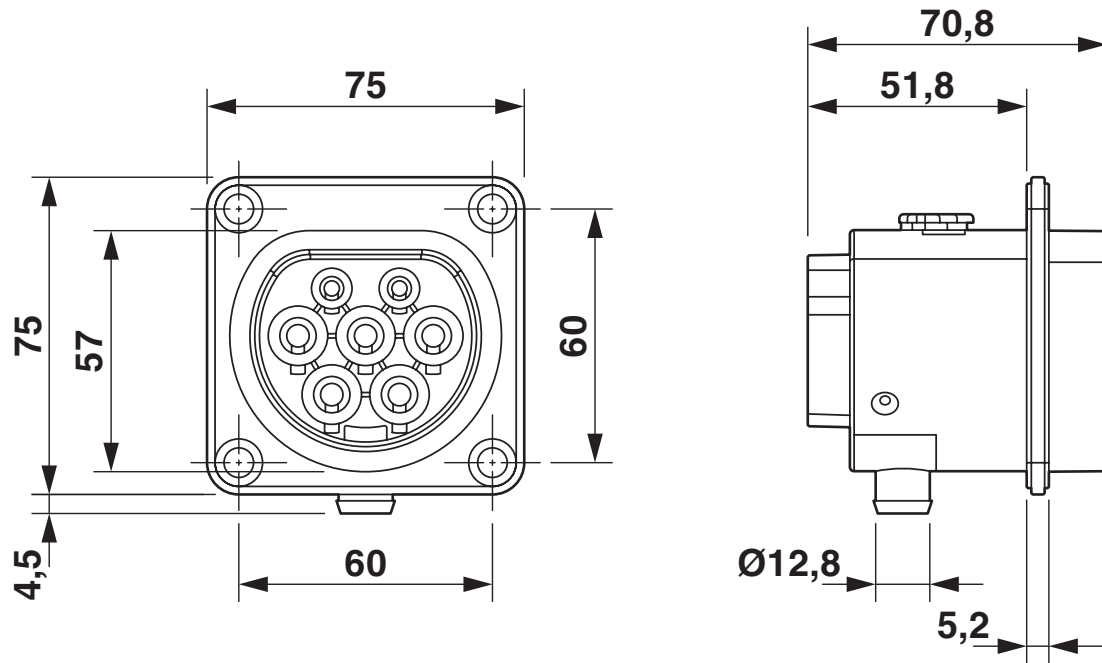

Dimensional drawing

Connection diagram

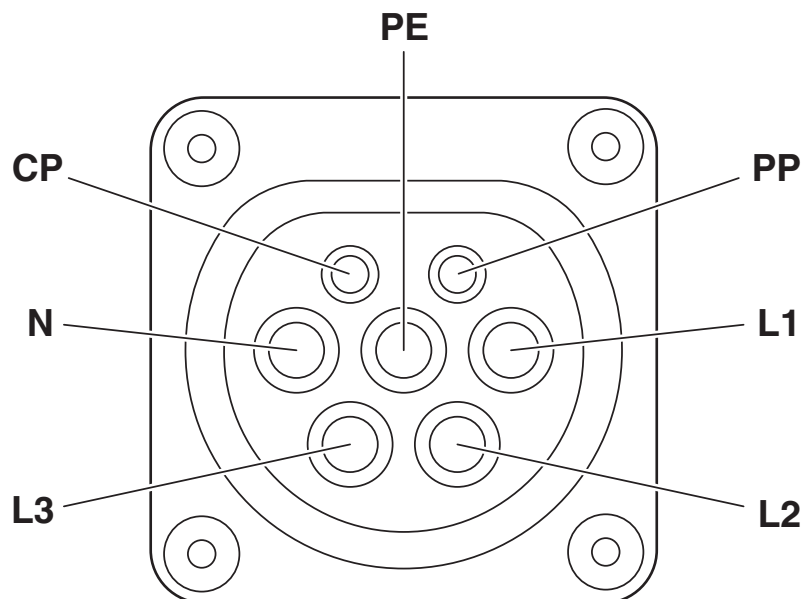

Pin assignment of infrastructure charging socket

# EV-T2M3S-3AC32A-1,5M6,0E00 - Infrastructure charging socket

1627229

<https://www.phoenixcontact.com/us/products/1627229>

Schematic diagram

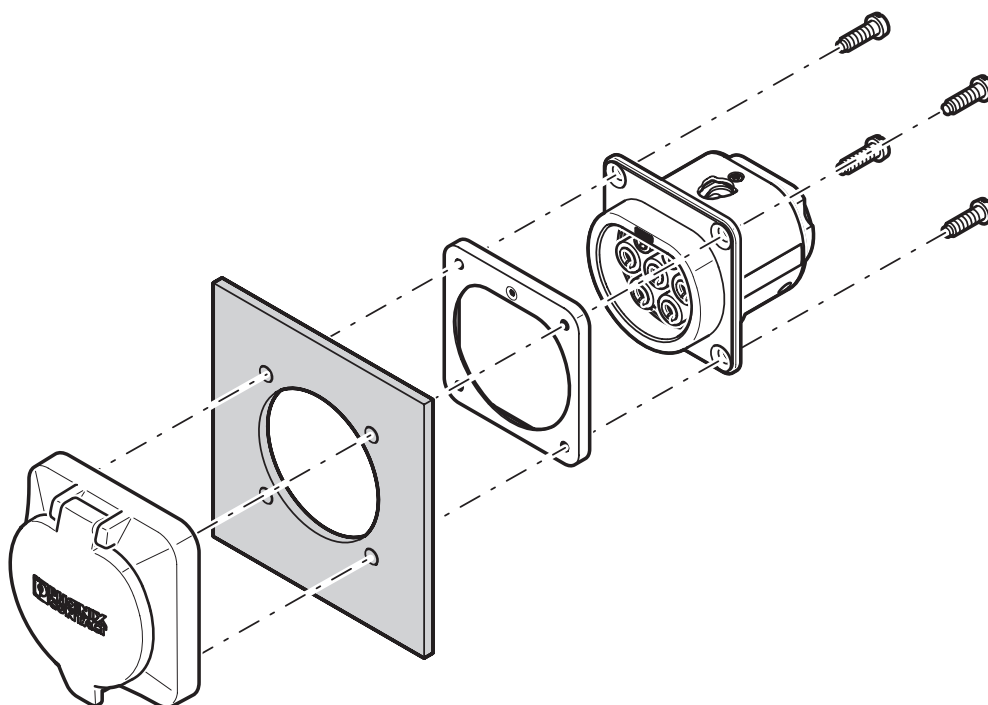

## Rear mounting with rear protective cover screw connection

The screw connection for a protective cover from the accessories range (EV-T2SC) only supports rear mounting. The panel thickness must not exceed 5 mm. The sealing frame that is slid on from the rear must contact the housing panel flush with the flat side and must completely surround the infrastructure socket outlet.

# EV-T2M3S-3AC32A-1,5M6,0E00 - Infrastructure charging socket

1627229

<https://www.phoenixcontact.com/us/products/1627229>

Schematic diagram

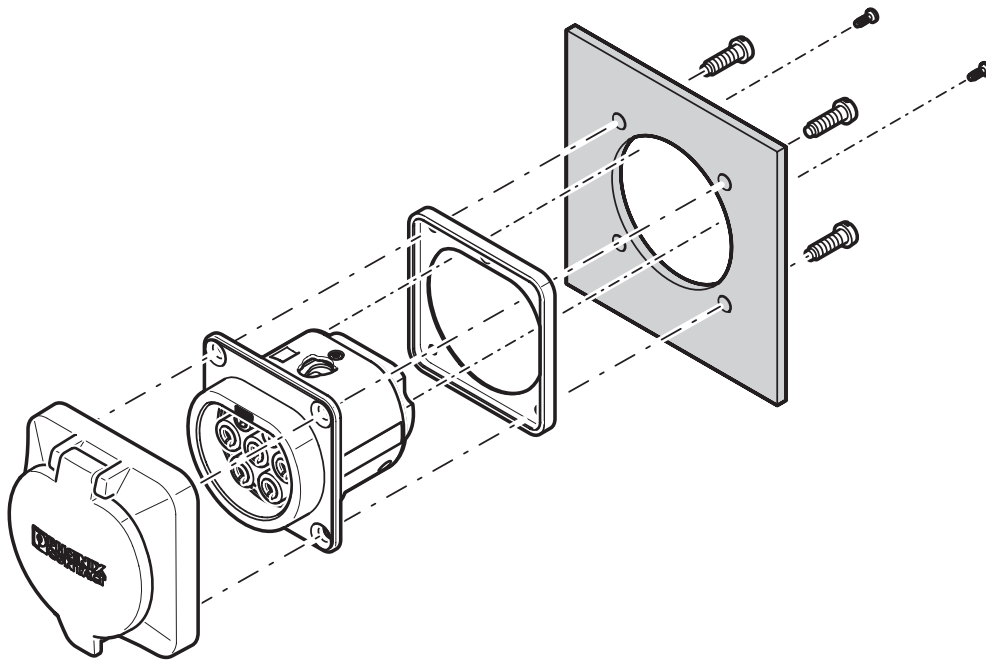

Front mounting with rear protective cover screw connection

Front mounting is only possible when the locking actuator is removed.

The screw connection for a protective cover from the accessories range (EV-T2SC) only supports rear mounting. The panel thickness must not exceed 10 mm. The sealing frame that is slid on from the front must contact the housing panel flush with the flat side and must completely surround the infrastructure socket outlet.

# EV-T2M3S-3AC32A-1,5M6,0E00 - Infrastructure charging socket

1627229

<https://www.phoenixcontact.com/us/products/1627229>

Schematic diagram

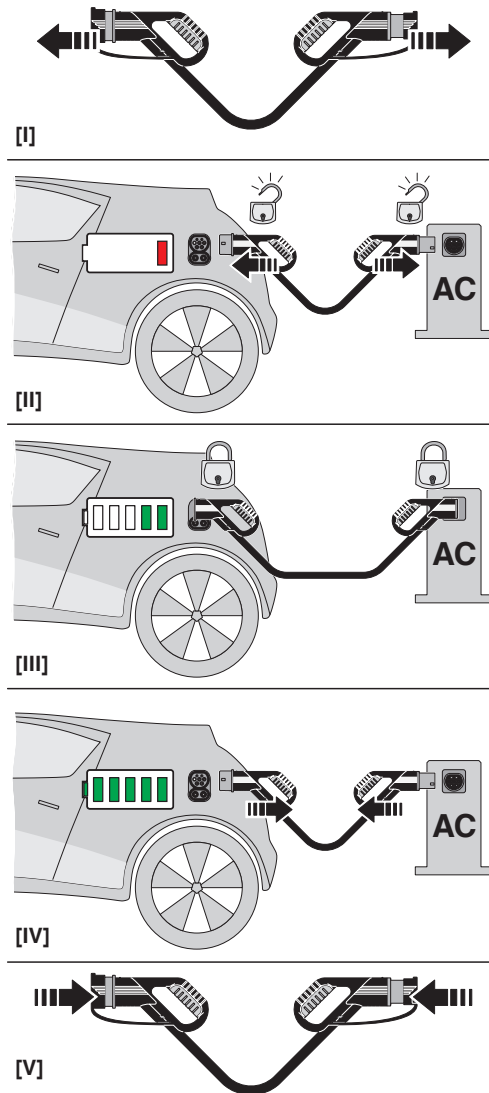

Operating instructions

# EV-T2M3S-3AC32A-1,5M6,0E00 - Infrastructure charging socket

1627229

<https://www.phoenixcontact.com/us/products/1627229>

Schematic diagram

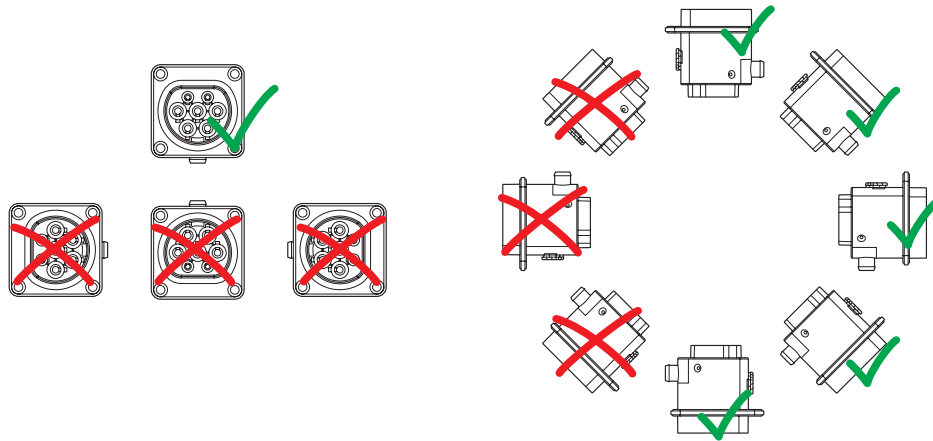

Installation positions

Schematic diagram

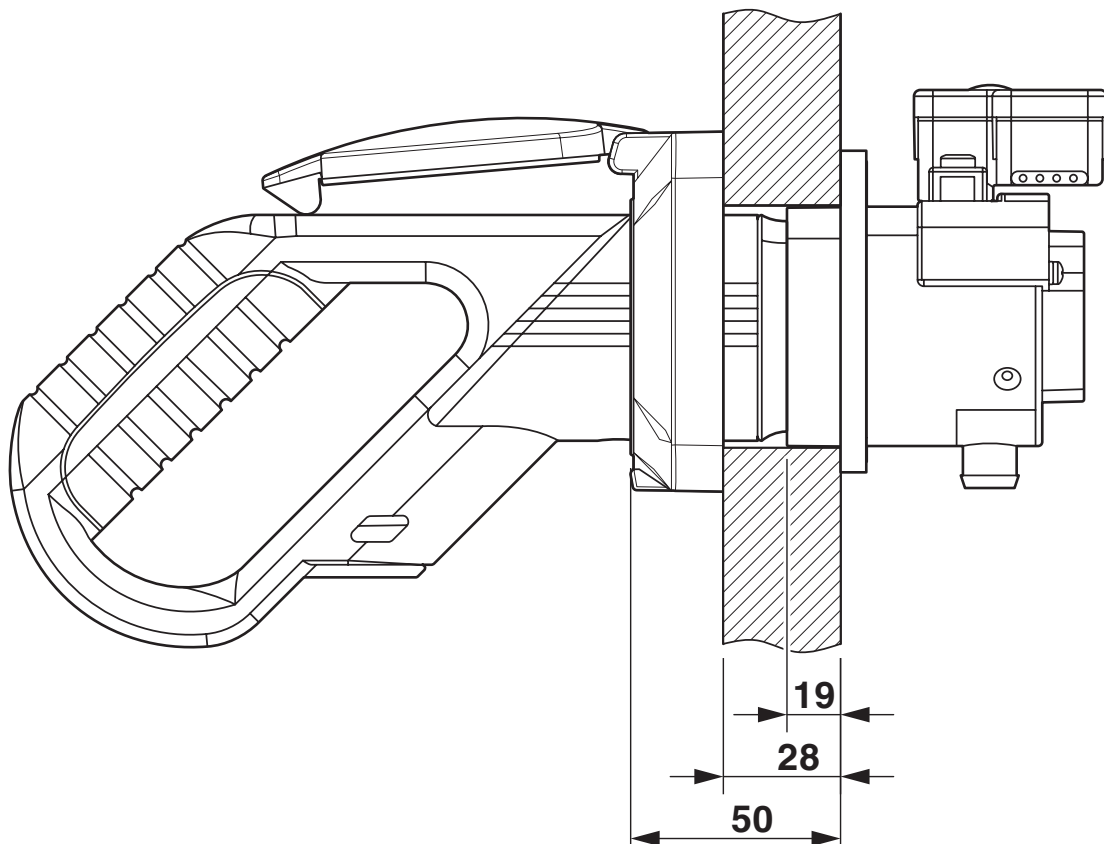

Panel thickness for rear mounting (max. 50 mm, with Phoenix Contact protective cover, max. 22 mm)

# EV-T2M3S-3AC32A-1,5M6,0E00 - Infrastructure charging socket

1627229

<https://www.phoenixcontact.com/us/products/1627229>

Schematic diagram

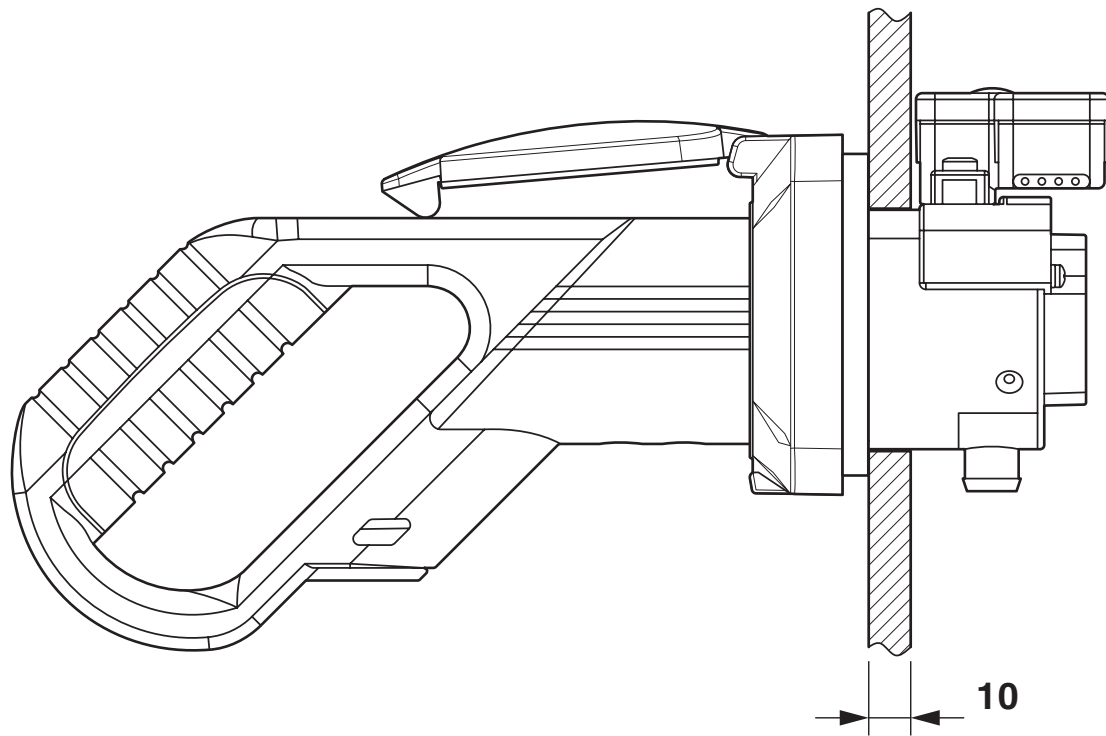

Panel thickness for front mounting (in mm)

# EV-T2M3S-3AC32A-1,5M6,0E00 - Infrastructure charging socket



1627229

<https://www.phoenixcontact.com/us/products/1627229>

## Classifications

### UNSPSC

UNSPSC 21.0	39121522
-------------	----------

# EV-T2M3S-3AC32A-1,5M6,0E00 - Infrastructure charging socket



1627229

<https://www.phoenixcontact.com/us/products/1627229>

## Environmental product compliance

### EU RoHS

Fulfills EU RoHS substance requirements	Not applicable, No electrical and electronic equipment (EEE), cannot be used in EEE
---	---

### EU REACH SVHC

REACH candidate substance (CAS No.)	Lead(CAS: 7439-92-1)
-------------------------------------	----------------------

Phoenix Contact 2026 © - all rights reserved  
<https://www.phoenixcontact.com>

Phoenix Contact USA  
586 Fulling Mill Road  
Middletown, PA 17057, United States  
(+717) 944-1300  
[info@phoenixcon.com](mailto:info@phoenixcon.com)