

# EV-T2M3S-E-LOCK12V - Locking



1624129

<https://www.phoenixcontact.com/us/products/1624129>

Please be informed that the data shown in this PDF document is generated from our online catalog. Please find the complete data in the user documentation. Our general terms of use for downloads are valid.

CHARX connect modular, Type 2, GB/T, Locking, Accessories, Single-core wires connected at one end, length: 0.5 m, locking actuator: 12 V, 4-pos., for attachment to infrastructure charging sockets, IEC 61851-1



## Product description

Locking actuator with 12 V power supply for infrastructure charging sockets

## Your advantages

- Integrated interlock during charging
- Manual emergency release of the locking actuator
- Developed and produced in accordance with the IATF 16949 automotive standard and ISO 9001
- Uniform, space-saving installation space

## Commercial data

Item number	1624129
Packing unit	1 pc
Minimum order quantity	1 pc
Sales key	EM01
Product key	XWBFAC
GTIN	4055626239880
Weight per piece (including packing)	152 g
Weight per piece (excluding packing)	95 g
Customs tariff number	85011099
Country of origin	DE

# EV-T2M3S-E-LOCK12V - Locking



1624129

<https://www.phoenixcontact.com/us/products/1624129>

## Technical data

### Product properties

Product type	Locking actuator
Product family	CHARX connect modular
Type	Accessories
Charging standard	Type 2
	GB/T
Charging mode	Mode 2, 3, 4

### Electrical properties

#### Locking actuator

Locking actuator	12 V, 4-pos.
	Position can be freely selected
Possible power supply range at the motor	9 V ... 16 V
Maximum voltage for locking detection	30 V
Typical motor current for locking	0.2 A
Reverse current of the motor	max. 1 A
Max. dwell time with reverse current	1000 ms
Recommended adaptation time	600 ms
Pause time after entry or exit path	3 s
Service life insertion cycles	> 10000 load cycles
Lock recognition	available
Mechanical emergency release	available
Ambient temperature (operation)	-30 °C ... 50 °C

### Material specifications

Color (Locking)	black (9005)
-----------------	--------------

### Cable/line

Cable length	0.5 m
Cable type	Single-core wires connected at one end
Cable structure	4 x 0.5 mm <sup>2</sup>
Single wire, material	PVC
Single wire, color	BU/RD
	BU/GN
	BU/YE
	BU/BN
External cable diameter	1.60 mm ±0.20 mm
Cable resistance	≤ 37.1 Ω/m

### Environmental and real-life conditions

#### Ambient conditions

# EV-T2M3S-E-LOCK12V - Locking



1624129

<https://www.phoenixcontact.com/us/products/1624129>

Ambient temperature (operation)	-30 °C ... 50 °C
Ambient temperature (storage/transport)	-40 °C ... 80 °C
Altitude	5000 m (above sea level)

## Standards and regulations

### Standards

Standards/regulations	IEC 61851-1
-----------------------	-------------

# EV-T2M3S-E-LOCK12V - Locking

1624129

<https://www.phoenixcontact.com/us/products/1624129>

## Drawings

Schematic diagram

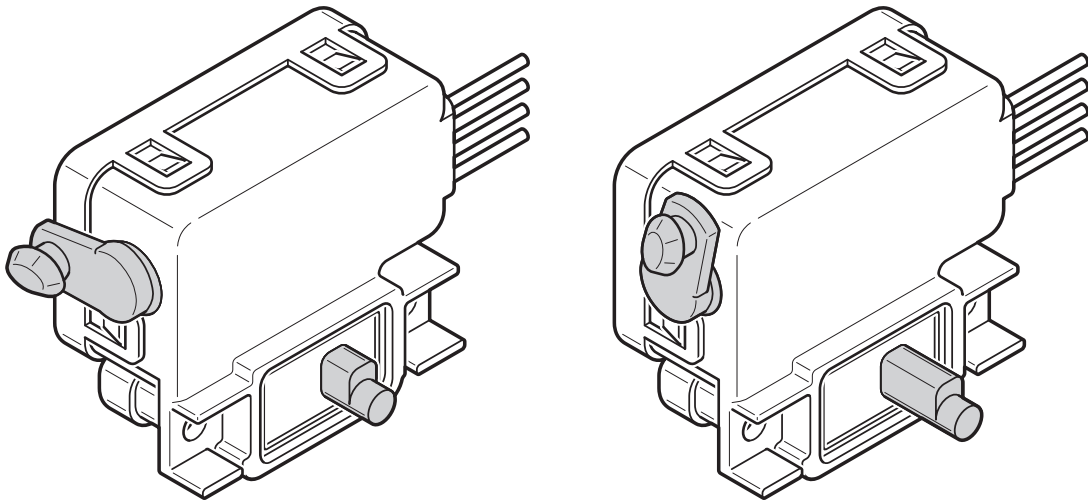

Lever positions for emergency release

Schematic diagram

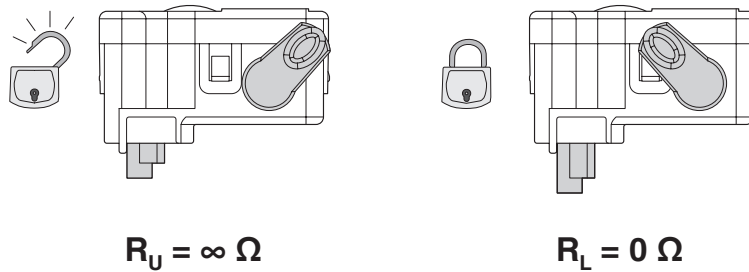

Lever positions for emergency release

# EV-T2M3S-E-LOCK12V - Locking

1624129

<https://www.phoenixcontact.com/us/products/1624129>

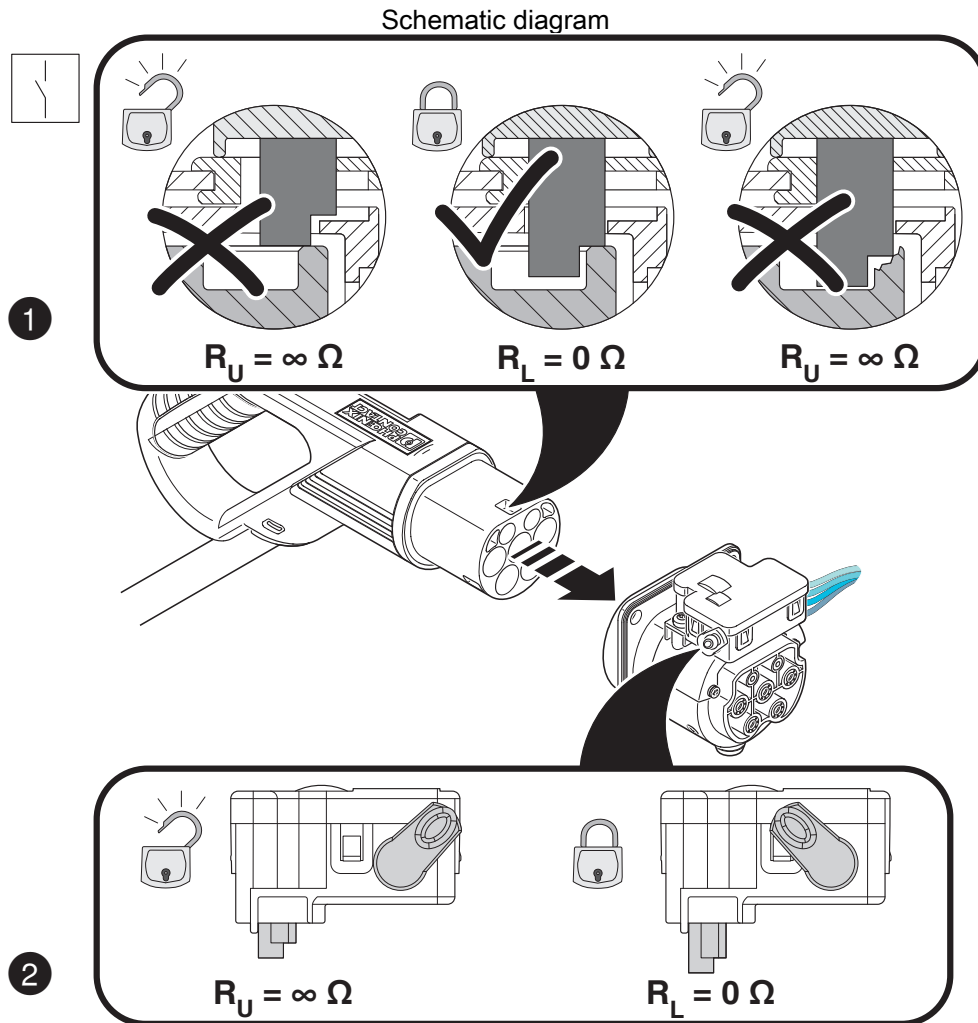

Detection of the Infrastructure Plug

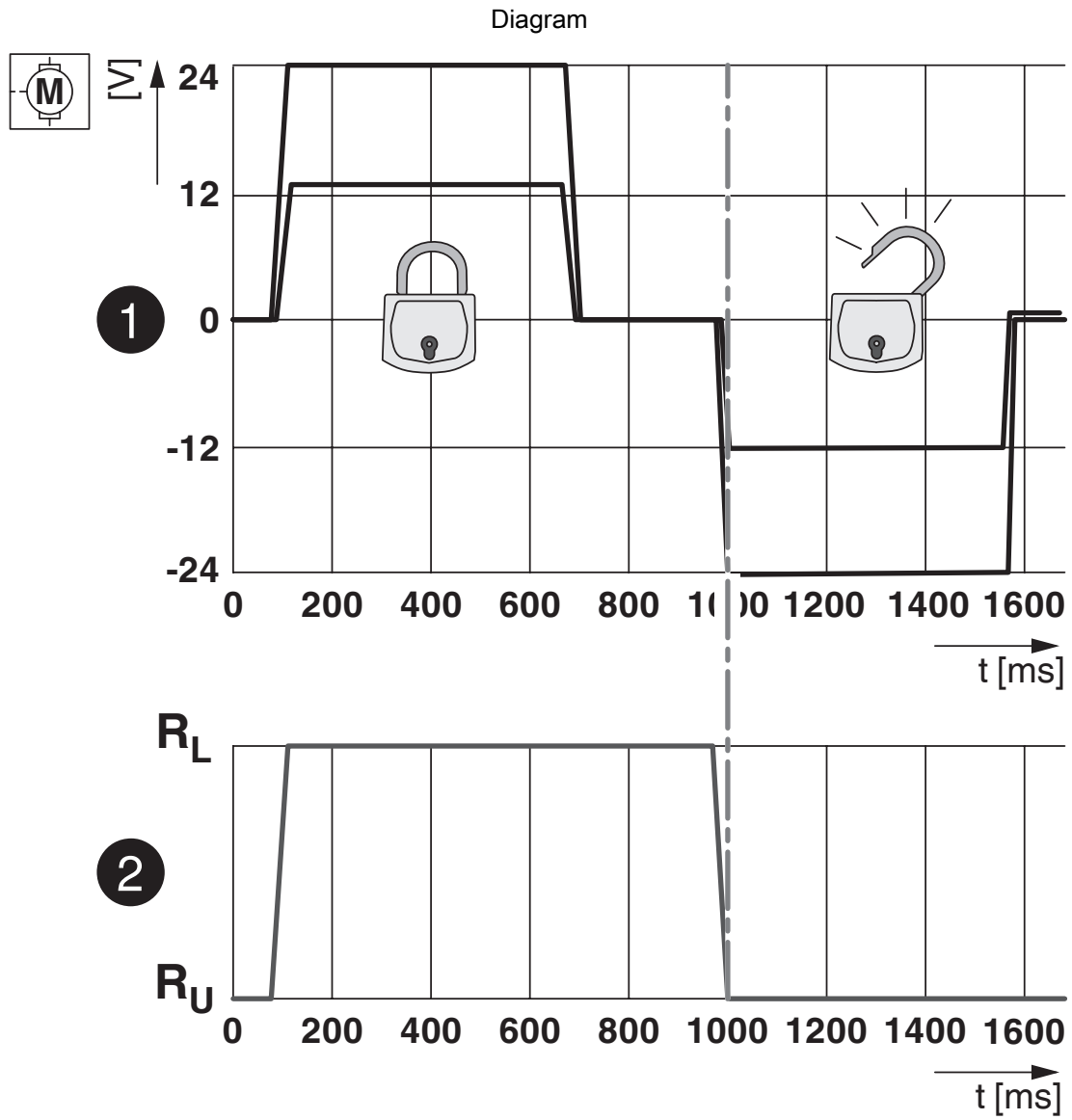

Locking states of the locking actuator

# EV-T2M3S-E-LOCK12V - Locking

1624129

<https://www.phoenixcontact.com/us/products/1624129>



Block diagram

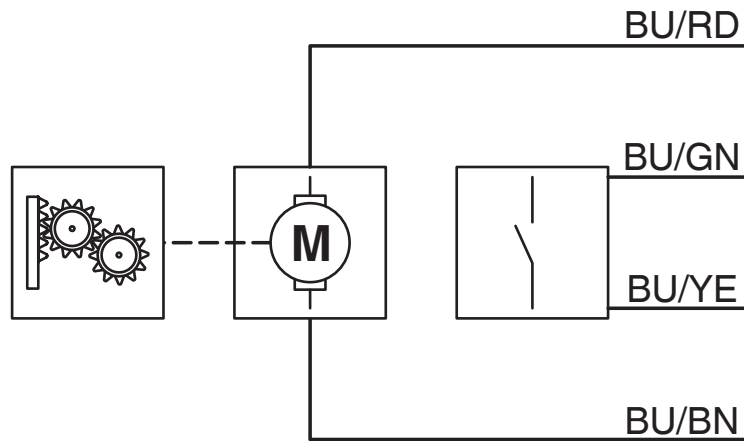

Block diagram of the locking actuator

# EV-T2M3S-E-LOCK12V - Locking



1624129

<https://www.phoenixcontact.com/us/products/1624129>

## Classifications

### ECLASS

ECLASS-13.0	27144792
ECLASS-15.0	27144792

### ETIM

ETIM 10.0	EC002884
-----------	----------

### UNSPSC

UNSPSC 21.0	39121500
-------------	----------

# EV-T2M3S-E-LOCK12V - Locking



1624129

<https://www.phoenixcontact.com/us/products/1624129>

## Environmental product compliance

### EU RoHS

Fulfills EU RoHS substance requirements	Not applicable, No electrical and electronic equipment (EEE), cannot be used in EEE
---	---

### EU REACH SVHC

REACH candidate substance (CAS No.)	Lead(CAS: 7439-92-1)
SCIP	c86cccb9-5c52-42c7-9d6e-afffab27783a

Phoenix Contact 2026 © - all rights reserved

<https://www.phoenixcontact.com>

Phoenix Contact USA  
586 Fulling Mill Road  
Middletown, PA 17057, United States  
(+717) 944-1300  
[info@phoenixcon.com](mailto:info@phoenixcon.com)