

# EV-T2SOC-PA - Protective cover



1549875

<https://www.phoenixcontact.com/us/products/1549875>

Please be informed that the data shown in this PDF document is generated from our online catalog. Please find the complete data in the user documentation. Our general terms of use for downloads are valid.



CHARX connect modular, Type 2, Protective cover, Premium, Accessories, square, Front mounting, M5 thread, with self-locking mechanism, with LED (common anode connection), for attachment to infrastructure charging sockets, Embossed PHOENIX CONTACT logo, IEC 62196-2

## Product description

Self-closing protective cover for infrastructure charging socket

## Commercial data

Item number	1549875
Packing unit	1 pc
Minimum order quantity	1 pc
Sales key	EM01
Product key	XWBFCLC
GTIN	4067923025905
Weight per piece (including packing)	144.6 g
Weight per piece (excluding packing)	142 g
Customs tariff number	39269097
Country of origin	PL

# EV-T2SOC-PA - Protective cover



1549875

<https://www.phoenixcontact.com/us/products/1549875>

## Technical data

### Product properties

Product type	Protective cover for Socket Outlet
Product family	CHARX connect modular
Type	Gen 2 Premium Accessories
Design	with self-locking mechanism with LED (common anode connection)
Compatibility	compatible with all CHARX connect infrastructure charging sockets compatible with CHARX connect modular shutters
Charging standard	Type 2
Charging mode	Mode 3, Case B
Design (Protective cover)	square
Affixed logo	Embossed PHOENIX CONTACT logo
Customer variations	On request

### Dimensions

#### Protective cover

Dimensional drawing	
Width	84.9 mm
Height	93.7 mm
Depth	30.5 mm

#### Bore dimensions

Dimensional drawing	
Width	60 mm
Height	60 mm

### Material specifications

Color (Protective cover)	black (9005)
Material (Protective cover)	Plastic

# EV-T2SOC-PA - Protective cover



1549875

<https://www.phoenixcontact.com/us/products/1549875>

## Mechanical properties

Type of cover movement	Self-locking
------------------------	--------------

## Environmental and real-life conditions

### Ambient conditions

Degree of protection (Protective cover)	IP54
	IK08
Ambient temperature (operation)	-30 °C ... 50 °C
Ambient temperature (storage/transport)	-40 °C ... 80 °C
Altitude	5000 m (above sea level)

## Standards and regulations

Standards/specifications	IEC 62196-2
Note	Compliant with AFIR - EU 2025/656

## Mounting

Mounting type Protective cover	Front mounting (rear screw connection, the associated infrastructure charging socket can be attached from the rear or from the front)
Fixing screws	M5 thread

# EV-T2SOC-PA - Protective cover

1549875

<https://www.phoenixcontact.com/us/products/1549875>

## Drawings

Dimensional drawing

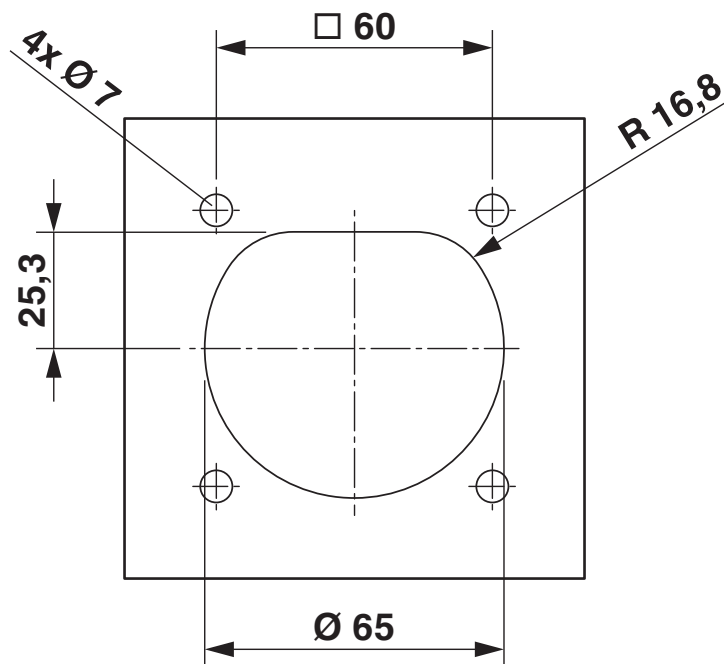

Dimensional drawing

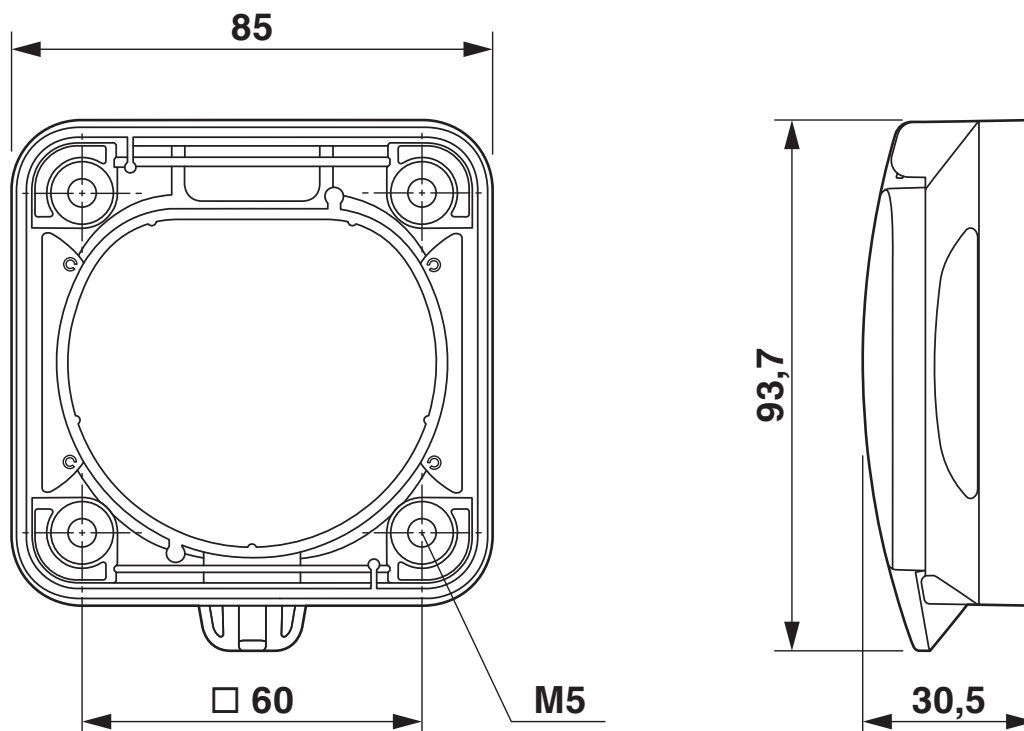

# EV-T2SOC-PA - Protective cover

1549875

<https://www.phoenixcontact.com/us/products/1549875>

Schematic diagram

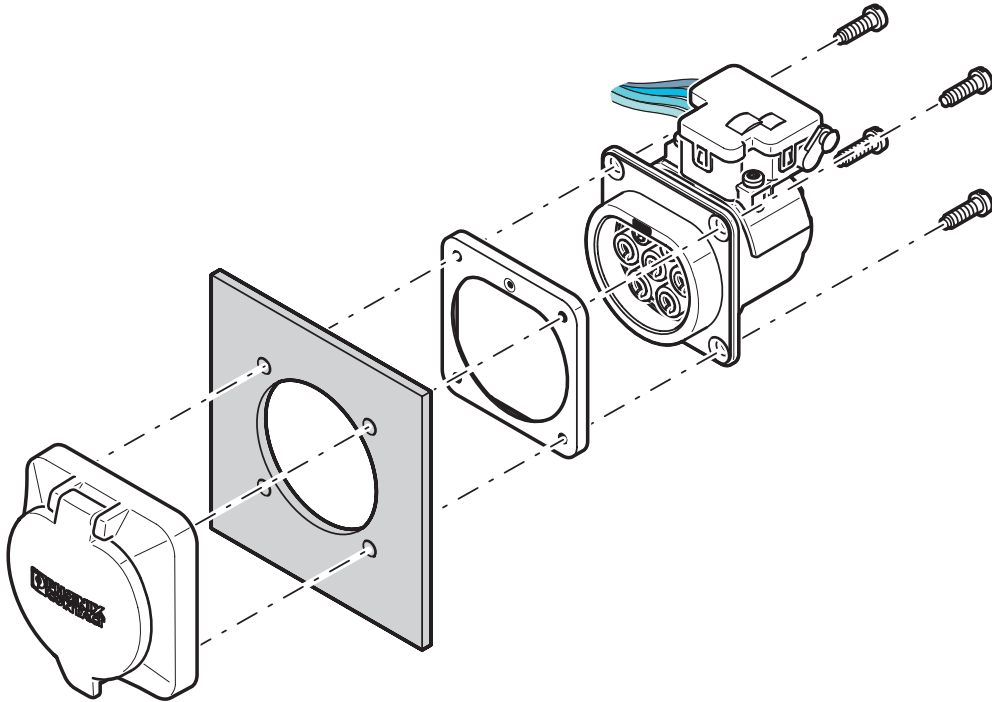

## Rear mounting with rear protective cover screw connection

The screw connection for a protective cover from the accessories range (EV-T2SC) only supports rear mounting. The panel thickness must not exceed 5 mm. The sealing frame that is slid on from the rear must contact the housing panel flush with the flat side and must completely surround the infrastructure socket outlet.

# EV-T2SOC-PA - Protective cover

1549875

<https://www.phoenixcontact.com/us/products/1549875>

Schematic diagram

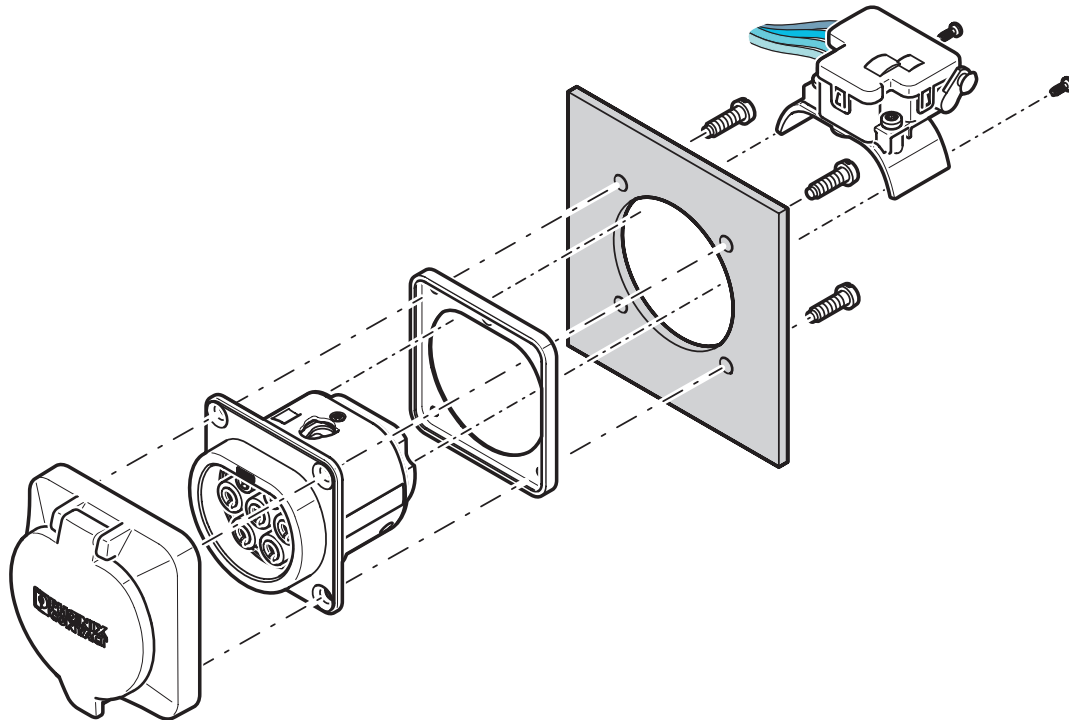

## Front mounting with rear protective cover screw connection

Front mounting is only possible when the locking actuator is removed. We recommend using an infrastructure socket outlet without pre-assembled locking actuator (EV-T2M3SE-...E0..., e.g., 1621729).

The screw connection for a protective cover from the accessories range (EV-T2SC) only supports rear mounting. The panel thickness must not exceed 10 mm. The sealing frame that is slid on from the front must contact the housing panel flush with the flat side and must completely surround the infrastructure socket outlet.

# EV-T2SOC-PA - Protective cover



1549875

<https://www.phoenixcontact.com/us/products/1549875>

## Classifications

### ECLASS

ECLASS-13.0	27144792
ECLASS-15.0	27144792

### ETIM

ETIM 10.0	EC002884
-----------	----------

# EV-T2SOC-PA - Protective cover



1549875

<https://www.phoenixcontact.com/us/products/1549875>

## Environmental product compliance

### EU RoHS

Fulfills EU RoHS substance requirements	Not applicable, No electrical and electronic equipment (EEE), cannot be used in EEE
---	---

### EU REACH SVHC

REACH candidate substance (CAS No.)	Lead(CAS: 7439-92-1)
SCIP	5c600c8d-5748-4163-b7d5-98e6638e36a3

### EF3.1 Climate Change

CO2e kg	5.047 kg CO2e
---------	---------------

Phoenix Contact 2026 © - all rights reserved  
<https://www.phoenixcontact.com>

Phoenix Contact USA  
586 Fulling Mill Road  
Middletown, PA 17057, United States  
(+717) 944-1300  
[info@phoenixcon.com](mailto:info@phoenixcon.com)