

# HC-STA-D15-BWS-EL-AL - Housing

1424362

<https://www.phoenixcontact.com/us/products/1424362>

Please be informed that the data shown in this PDF document is generated from our online catalog. Please find the complete data in the user documentation. Our general terms of use for downloads are valid.



Panel mounting base D15, with single locking latch, material: Die-cast aluminum, salt water resistant, height: 26 mm, cable gland: none, Standard

## Commercial data

Item number	1424362
Packing unit	1 pc
Minimum order quantity	1 pc
Sales key	BF56
Product key	AF7APE
GTIN	4055626371047
Weight per piece (including packing)	66.1 g
Weight per piece (excluding packing)	60 g
Customs tariff number	85389099
Country of origin	CN

# HC-STA-D15-BWS-EL-AL - Housing

1424362

<https://www.phoenixcontact.com/us/products/1424362>

## Technical data

### Notes

General	For contact inserts HC-D15, A10
---------	---------------------------------

### Product properties

Product type	Housing with locking latch
Housing type	Panel mounting base
Product family	HC-STA-D
Application	Standard
Type	D15
Pg screw connection	none

### Dimensions

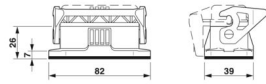
Dimensional drawing	
Width	39 mm
Height	26 mm
Length	82 mm
Hole diameter	3.3 mm

### Installation dimensions

Width of the assembly cutout	24 mm
Length of the assembly cutout	58 mm

### Material specifications

Flammability rating according to UL 94	V0 (Interlock)
Seal material	NBR, conductive NBR, conductive
Housing material	Die-cast aluminum, salt water resistant
Housing surface material	uncoated
Locking latch material	PA

### Mechanical properties

#### Mechanical data

Locking type	Latch
--------------	-------

### Connection data

Tightening torque	0.5 Nm ... 0.8 Nm (For M3 mounting screws on the panel-mount base)
-------------------	--

# HC-STA-D15-BWS-EL-AL - Housing



1424362

<https://www.phoenixcontact.com/us/products/1424362>

## Environmental and real-life conditions

### Ambient conditions

Degree of protection	IP66
	IP67
Impact strength	IK08
Ambient temperature (operation)	-40 °C ... 125 °C

# HC-STA-D15-BWS-EL-AL - Housing



1424362

<https://www.phoenixcontact.com/us/products/1424362>

## Drawings

Dimensional drawing

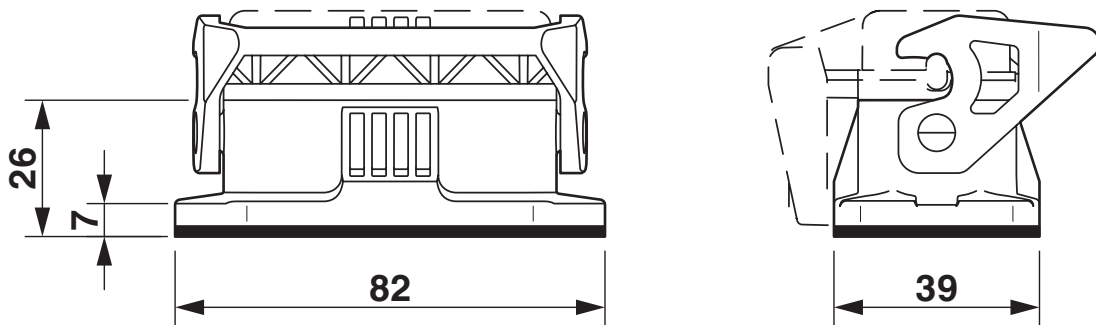

Dimensional drawing

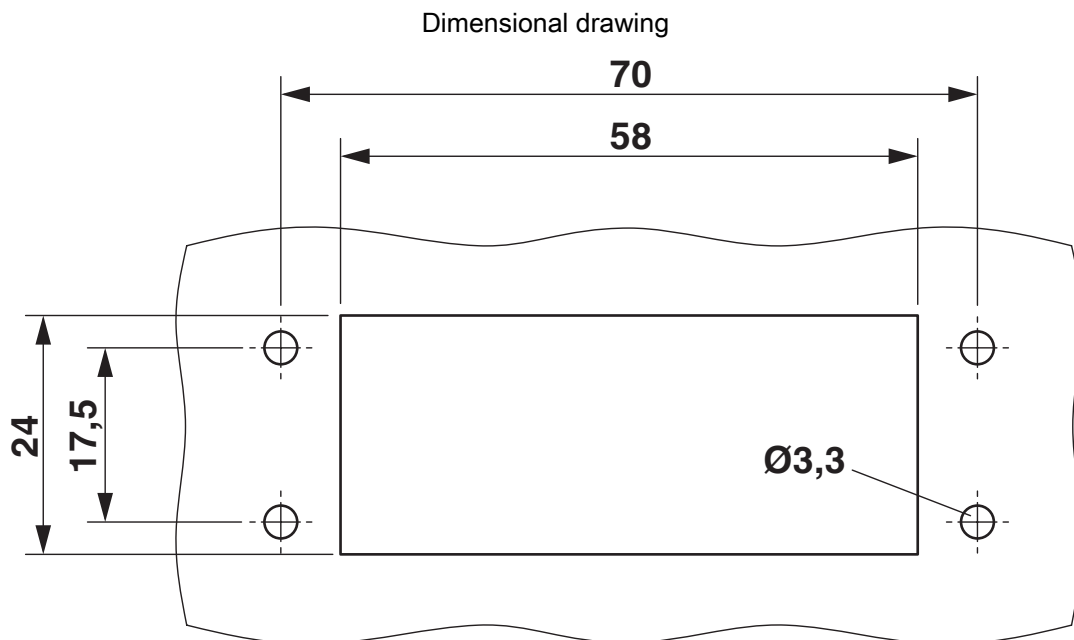

Mounting cutout

# HC-STA-D15-BWS-EL-AL - Housing



1424362

<https://www.phoenixcontact.com/us/products/1424362>

## Approvals

To download certificates, visit the product detail page: <https://www.phoenixcontact.com/us/products/1424362>

**DNV**

Approval ID: TAE000037S



**cUL Recognized**

Approval ID: E255026



**UL Recognized**

Approval ID: E255026

# HC-STA-D15-BWS-EL-AL - Housing



1424362

<https://www.phoenixcontact.com/us/products/1424362>

## Classifications

### ECLASS

ECLASS-13.0	27440202
ECLASS-15.0	27440202

### ETIM

ETIM 10.0	EC000437
-----------	----------

### UNSPSC

UNSPSC 21.0	31261500
-------------	----------

# HC-STA-D15-BWS-EL-AL - Housing



1424362

<https://www.phoenixcontact.com/us/products/1424362>

## Environmental product compliance

### EU RoHS

Fulfills EU RoHS substance requirements	Yes, No exemptions
---	--------------------

### China RoHS

Environment friendly use period (EFUP)	EFUP-E
	No hazardous substances above the limits

### EU REACH SVHC

REACH candidate substance (CAS No.)	No substance above 0.1 wt%
-------------------------------------	----------------------------

Phoenix Contact 2026 © - all rights reserved  
<https://www.phoenixcontact.com>

Phoenix Contact USA  
586 Fulling Mill Road  
Middletown, PA 17057, United States  
(+717) 944-1300  
[info@phoenixcon.com](mailto:info@phoenixcon.com)