

H4X:C5FF:UCFM:AC - Housing



1415793

<https://www.phoenixcontact.com/us/products/1415793>

Please be informed that the data shown in this PDF document is generated from our online catalog. Please find the complete data in the user documentation. Our general terms of use for downloads are valid.



HEAVYPORT B24 panel mounting base, with single locking latch, with plastic protective cover, with stainless steel front plate connections, 1x RJ45 CAT5e (female/female), 1x USB Type A/A (female/cable), 1x 120 V AC outlet

Your advantages

- Good shielding in the event of electromagnetic interference

Commercial data

| | |
|--------------------------------------|---------------|
| Item number | 1415793 |
| Packing unit | 1 pc |
| Minimum order quantity | 1 pc |
| Sales key | BF69 |
| Product key | AF7EGX |
| GTIN | 4055626805894 |
| Weight per piece (including packing) | 22.22 g |
| Weight per piece (excluding packing) | 22.22 g |
| Country of origin | US |

Technical data

Product properties

| | |
|------------------|-----------------------|
| Product type | Stackable housing set |
| Housing type | Panel mounting base |
| Application | Standard |
| Type | B24 |
| Protective cover | yes |

Electrical properties

| | |
|-----------------------|---|
| Rated voltage (III/3) | max. 125 V AC (AC outlet, UL, CSA rating) |
| Rated current | max. 1.5 A DC (RJ45) |
| | 15 A (AC outlet, UL, CSA rating) |

Connection data

| | |
|-------------------|--------------|
| Tightening torque | 1.5 ... 2 Nm |
|-------------------|--------------|

Dimensions

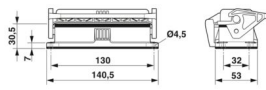
| | |
|---------------------|--|
| Dimensional drawing |  |
| Width | 53 mm |
| Height | 30.5 mm |
| Length | 140.5 mm |

Installation dimensions

| | |
|-------------------------------|--------|
| Width of the assembly cutout | 35 mm |
| Length of the assembly cutout | 113 mm |

Material specifications

| | |
|----------------------------|---|
| Material | Stainless steel (Front plate) |
| Seal material | NBR, conductive |
| | NBR, conductive |
| Housing material | Die-cast aluminum, salt water resistant |
| Housing surface material | uncoated |
| Material, protective cover | PA |
| Locking latch material | Polyamide |

Connector

| | |
|-----------------------|---|
| Contact insert design | with 1x RJ45 Cat 5E Ethernet Socket/socket, snap-in slot locking |
| | with 2x USB Type A/A 2.0 10 ft. cable with male USB Type A 2.0 end |
| | with 1x 120 V AC outlet Terminal 6.35 mm. AC outlet requires slip-on sleeves: Item No. 3240539 or 3240536 |

H4X:C5FF:UCFM:AC - Housing



1415793

<https://www.phoenixcontact.com/us/products/1415793>

Environmental and real-life conditions

Ambient conditions

| | |
|---------------------------------|-----------------------------|
| Degree of protection | IP66 |
| | IP67 |
| Impact strength | IK08 |
| Ambient temperature (operation) | -40 °C ... 125 °C (Housing) |

Standards and regulations

| | |
|--------------------------|------------------------|
| Standards/specifications | AC Outlet UL, cUL, CSA |
|--------------------------|------------------------|

H4X:C5FF:UCFM:AC - Housing



1415793

<https://www.phoenixcontact.com/us/products/1415793>

Drawings

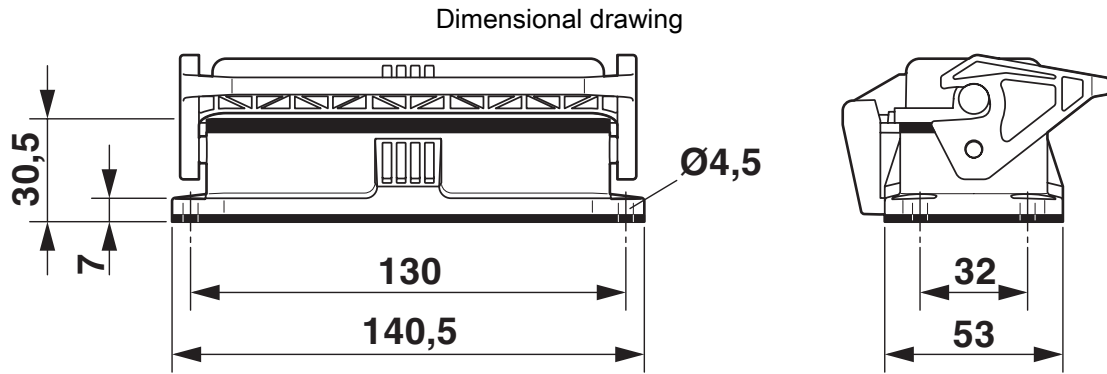

Dimensional drawing



Mounting cutout

H4X:C5FF:UCFM:AC - Housing



1415793

<https://www.phoenixcontact.com/us/products/1415793>

Classifications

ECLASS

| | |
|-------------|----------|
| ECLASS-15.0 | 27440113 |
| ECLASS-13.0 | 27440113 |

ETIM

| | |
|----------|----------|
| ETIM 9.0 | EC002636 |
|----------|----------|

1415793

<https://www.phoenixcontact.com/us/products/1415793>

Environmental product compliance

China RoHS

| | |
|--|---|
| Environment friendly use period (EFUP) | EFUP-50 |
| | An article-related China RoHS declaration table can be found in the download area for the respective article under "Manufacturer declaration". For all articles with EFUP-E, no China RoHS declaration table issued and required. |

EU REACH SVHC

| | |
|-------------------------------------|----------------------------|
| REACH candidate substance (CAS No.) | No substance above 0.1 wt% |
|-------------------------------------|----------------------------|

Phoenix Contact 2026 © - all rights reserved
<https://www.phoenixcontact.com>

Phoenix Contact USA
586 Fulling Mill Road
Middletown, PA 17057, United States
(+717) 944-1300
info@phoenixcon.com