

HC-HPR-B10-BFH-EMR-BK - Housing



1411083

<https://www.phoenixcontact.com/us/products/1411083>

Please be informed that the data shown in this PDF document is generated from our online catalog. Please find the complete data in the user documentation. Our general terms of use for downloads are valid.



HEAVYCON B10 panel mounting base, HPR series, for screw locking, for increased environmental and EMC requirements

Your advantages

- Vibration and shock: IEC 61373/EN 50155, category 1, class 1B

Commercial data

Item number	1411083
Packing unit	1 pc
Minimum order quantity	1 pc
Sales key	BF60
Product key	AF7AAI
GTIN	4046356921541
Weight per piece (including packing)	157.7 g
Weight per piece (excluding packing)	157.7 g
Customs tariff number	85389099
Country of origin	CN

HC-HPR-B10-BFH-EMR-BK - Housing



1411083

<https://www.phoenixcontact.com/us/products/1411083>

Technical data

Notes

General	For contact inserts HC-B10, BB18, DD42, M, K8/24
---------	--

Product properties

Product type	Housing with screw locking
Housing type	Panel mounting base
Product family	HC-HPR-B
Series	HPR-B10
Application	Railway applications
Type	B10
Protective cover	no
Pg screw connection	none

Connection data

Tightening torque	4 Nm (Locking screw)
-------------------	----------------------

Dimensions

Dimensional drawing	
Width	58 mm
Height	20 mm
Length	145 mm
Drill hole distance, horizontal	83 mm
Drill hole distance, vertical	32 mm
Hole diameter	6.5 mm

Installation dimensions

Width of the assembly cutout	35 mm
Length of the assembly cutout	60 mm

Material specifications

Seal material	NBR
Housing material	Die-cast aluminum
Housing surface material	Powder-coated, black
Locking latch material	Stainless steel
Material of locking screw	Stainless steel

Environmental and real-life conditions

Ambient conditions

HC-HPR-B10-BFH-EMR-BK - Housing



1411083

<https://www.phoenixcontact.com/us/products/1411083>

Degree of protection	IP66
	IP68 (0.5 bar / 24 h)
	IP69 (ISO 20653:2013-02)
Impact strength	IK09
Ambient temperature (operation)	-40 °C ... 125 °C

Mechanical properties

Mechanical data

Locking type	Nut
--------------	-----

HC-HPR-B10-BFH-EMR-BK - Housing



1411083

<https://www.phoenixcontact.com/us/products/1411083>

Drawings

Dimensional drawing

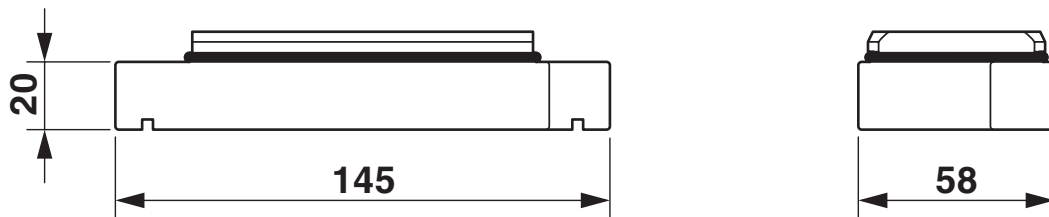

Dimensional drawing

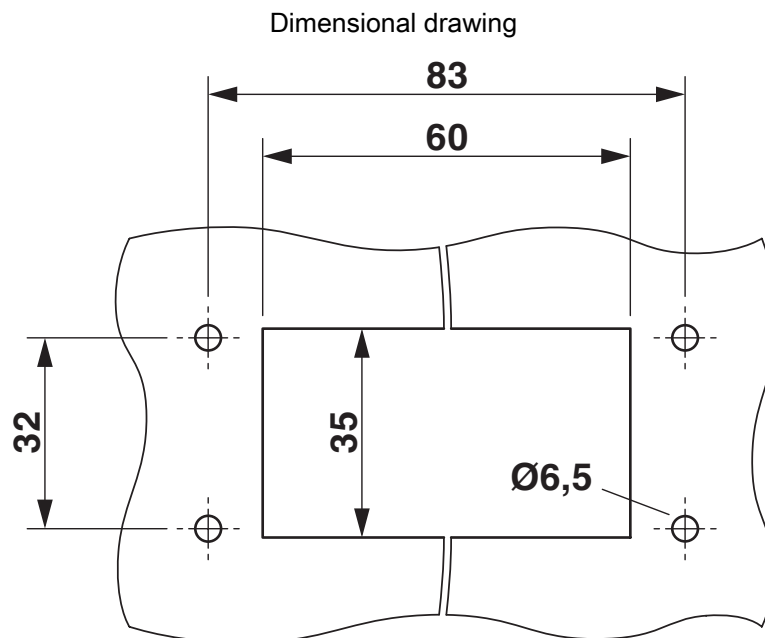

Mounting cutout

HC-HPR-B10-BFH-EMR-BK - Housing



1411083

<https://www.phoenixcontact.com/us/products/1411083>

Approvals

🔗 To download certificates, visit the product detail page: <https://www.phoenixcontact.com/us/products/1411083>

DNV

Approval ID: TAE000037S



EAC

Approval ID: RU C-DE.AI30.B.01102

1411083

<https://www.phoenixcontact.com/us/products/1411083>

Classifications

ECLASS

ECLASS-13.0	27440202
ECLASS-15.0	27440202

ETIM

ETIM 10.0	EC000437
-----------	----------

UNSPSC

UNSPSC 21.0	31261500
-------------	----------

HC-HPR-B10-BFH-EMR-BK - Housing



1411083

<https://www.phoenixcontact.com/us/products/1411083>

Environmental product compliance

EU RoHS

Fulfills EU RoHS substance requirements	Yes, No exemptions
---	--------------------

China RoHS

Environment friendly use period (EFUP)	EFUP-E
	No hazardous substances above the limits

EU REACH SVHC

REACH candidate substance (CAS No.)	No substance above 0.1 wt%
-------------------------------------	----------------------------

Phoenix Contact 2026 © - all rights reserved
<https://www.phoenixcontact.com>

Phoenix Contact USA
586 Fulling Mill Road
Middletown, PA 17057, United States
(+717) 944-1300
info@phoenixcon.com