

HC-B 16-TFL-76/O1STM32(G+S) - Housing



1402229

<https://www.phoenixcontact.com/us/products/1402229>

Please be informed that the data shown in this PDF document is generated from our online catalog. Please find the complete data in the user documentation. Our general terms of use for downloads are valid.



HEAVYCON sleeve housing B16, for single locking latch, height 76 mm, without support 2xM32, straight conductor exit

Commercial data

Item number	1402229
Packing unit	10 pc
Minimum order quantity	10 pc
Product key	AF7AAC
GTIN	4046356589253
Weight per piece (including packing)	273.8 g
Weight per piece (excluding packing)	273.8 g
Country of origin	DE

HC-B 16-TFL-76/O1STM32(G+S) - Housing



1402229

<https://www.phoenixcontact.com/us/products/1402229>

Technical data

Product properties

Product type	Housing with locking latch
Type	B16
Type of the screw connection	2x M32
Cable outlet	straight

Material specifications

Housing material	Die-cast aluminum
Housing surface material	Powder-coated, gray

Mechanical properties

Mechanical data

Type of the screw connection	2x M32
------------------------------	--------

Environmental and real-life conditions

Ambient conditions

Degree of protection	IP65
Ambient temperature (operation)	-40 °C ... 125 °C

HC-B 16-TFL-76/O1STM32(G+S) - Housing

1402229

<https://www.phoenixcontact.com/us/products/1402229>



Drawings

Dimensional drawing

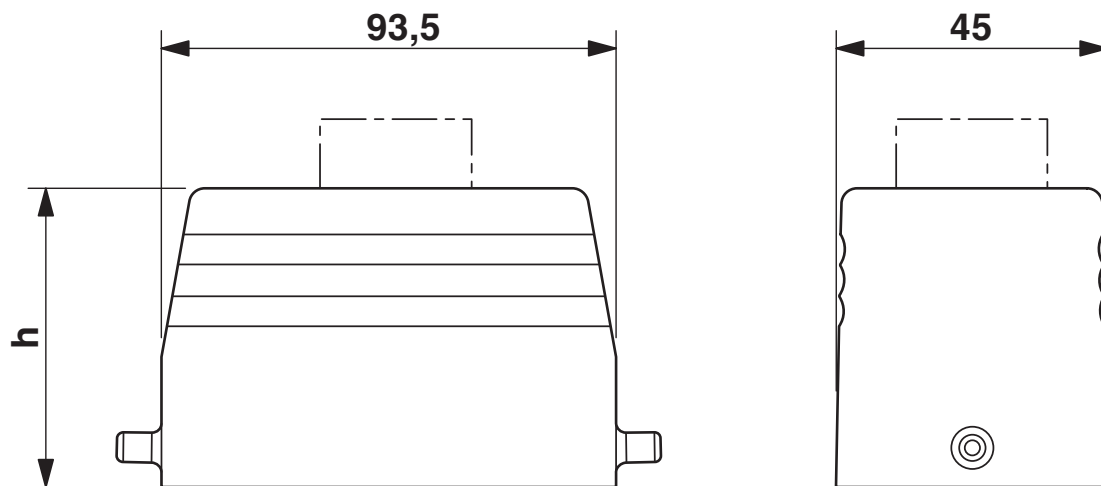

HC-B 16-TFL-76/O1STM32(G+S) - Housing



1402229

<https://www.phoenixcontact.com/us/products/1402229>

Classifications

ECLASS

ECLASS-13.0	27440202
ECLASS-15.0	27440202

HC-B 16-TFL-76/O1STM32(G+S) - Housing



1402229

<https://www.phoenixcontact.com/us/products/1402229>

Environmental product compliance

EU RoHS

Fulfills EU RoHS substance requirements	Yes, No exemptions
---	--------------------

EU REACH SVHC

REACH candidate substance (CAS No.)	No substance above 0.1 wt%
-------------------------------------	----------------------------

Phoenix Contact 2026 © - all rights reserved

<https://www.phoenixcontact.com>

Phoenix Contact USA
586 Fulling Mill Road
Middletown, PA 17057, United States
(+717) 944-1300
info@phoenixcon.com