

# ICS20-F90V-9005 - Connection plate



1287437

<https://www.phoenixcontact.com/us/products/1287437>

Please be informed that the data shown in this PDF document is generated from our online catalog. Please find the complete data in the user documentation. Our general terms of use for downloads are valid.

DIN rail housing, ICS filler, with vents, width: 20 mm, height: 7.25 mm, depth: 89.8 mm, color: black (similar RAL 9005)



## Your advantages

- Flexible use, thanks to the modular system and unique modularity in the connection technology
- Standardized connections such as RJ45, USB, D-SUB and antenna sockets as components that can be integrated
- Optimal space utilization, as well as adaptability of design, colors, and printing
- Customized processing for any customer-specific connection technology
- Easy and fast push-in mounting of assembled printed-circuit boards, thanks to stable guide rails

## Commercial data

|                                      |                                |
|--------------------------------------|--------------------------------|
| Item number                          | 1287437                        |
| Packing unit                         | 10 pc                          |
| Minimum order quantity               | 10 pc                          |
| Note                                 | Made to order (non-returnable) |
| Sales key                            | AC09                           |
| Product key                          | ACHAEE                         |
| GTIN                                 | 4063151513672                  |
| Weight per piece (including packing) | 3.83 g                         |
| Weight per piece (excluding packing) | 3.65 g                         |
| Customs tariff number                | 84879090                       |
| Country of origin                    | PL                             |

# ICS20-F90V-9005 - Connection plate

1287437

<https://www.phoenixcontact.com/us/products/1287437>

## Technical data

### Notes

|               |   |
|---------------|---|
| Assembly note | Please observe the application note in the download area. |
|---------------|---|

### Product properties

|                              |                  |
|------------------------------|------------------|
| Product type                 | Connection plate |
| Housing type                 | DIN rail housing |
| Housing series               | ICS              |
| Product family               | ICS20            |
| Ventilation openings present | yes              |

### Dimensions

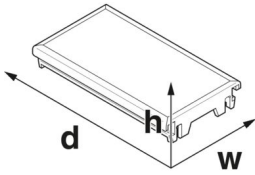
|                     |   |
|---------------------|---|
| Dimensional drawing |  |
| Width               | 20 mm   |
| Height              | 7.25 mm   |
| Depth               | 89.8 mm   |

### PCB design

|               |                   |
|---------------|-------------------|
| PCB thickness | 1.4 mm ... 1.8 mm |
|---------------|-------------------|

### Material specifications

|  |                  |
|--|------------------|
| Color (Housing)                        | black (RAL 9005) |
| Material Housing                       | PA               |
| Flammability rating according to UL 94 | V0               |
| CTI according to IEC 60112             | 600              |

### Environmental and real-life conditions

#### Vibration test

|                        |                             |
|------------------------|-----------------------------|
| Specification          | IEC 60068-2-6:2007-12       |
| Frequency              | 10 - 150 - 10 Hz            |
| Sweep speed            | 1 octave/min                |
| Amplitude              | 0.15 mm (10 Hz ... 58.1 Hz) |
| Acceleration           | 2g (58.1 Hz ... 150 Hz)     |
| Test duration per axis | 2.5 h                       |
| Test directions        | X-, Y- and Z-axis           |

#### Glow-wire test

|               |                        |
|---------------|------------------------|
| Specification | IEC 60695-2-11:2014-02 |
|---------------|------------------------|

# ICS20-F90V-9005 - Connection plate



1287437

<https://www.phoenixcontact.com/us/products/1287437>

|                  |        |
|------------------|--------|
| Temperature      | 850 °C |
| Time of exposure | 30 s   |

## Thermal stability / ball thrust test

|               |                        |
|---------------|------------------------|
| Specification | IEC 60695-10-2:2014-02 |
| Temperature   | 125 °C                 |
| Test duration | 1 h                    |
| Force         | 20 N                   |

## Mechanical strength / tumbling barrel

|                |                        |
|----------------|------------------------|
| Specification  | IEC 60068-2-31:2008-05 |
| Height of fall | 50 cm                  |
| Frequency      | 50                     |

## Shocks

|                                |                                   |
|--------------------------------|-----------------------------------|
| Specification                  | IEC 60068-2-27:2008-02            |
| Pulse shape                    | Half-sine                         |
| Acceleration                   | 15g                               |
| Shock duration                 | 11 ms                             |
| Number of shocks per direction | 3                                 |
| Test directions                | X-, Y- and Z-axis (pos. and neg.) |

## Test for substances that would hinder coating with paint or varnish

|               |                    |
|---------------|--------------------|
| Specification | VDMA 24364:2018-05 |
| Result        | Test passed        |

## Ambient conditions

|   |  |
|---|--|
| Max. IP code to attain                  | IP20   |
| Ambient temperature (operation)         | -40 °C ... 105 °C (depending on power dissipation) |
| Ambient temperature (storage/transport) | -40 °C ... 55 °C                                   |
| Ambient temperature (assembly)          | -5 °C ... 100 °C                                   |
| Relative humidity (storage/transport)   | 80 %   |

## PCB data

|                       |                   |
|-----------------------|-------------------|
| Number of PCB holders | 2                 |
| Type of PCB mount     | Slot              |
| Thickness of the PCB  | 1.4 mm ... 1.8 mm |

## Mounting

|               |      |
|---------------|------|
| Mounting type | Slot |
|---------------|------|

## Packaging specifications

|                      |                |
|----------------------|----------------|
| Outer packaging type | Resealable bag |
|----------------------|----------------|

# ICS20-F90V-9005 - Connection plate



1287437

<https://www.phoenixcontact.com/us/products/1287437>

## Drawings

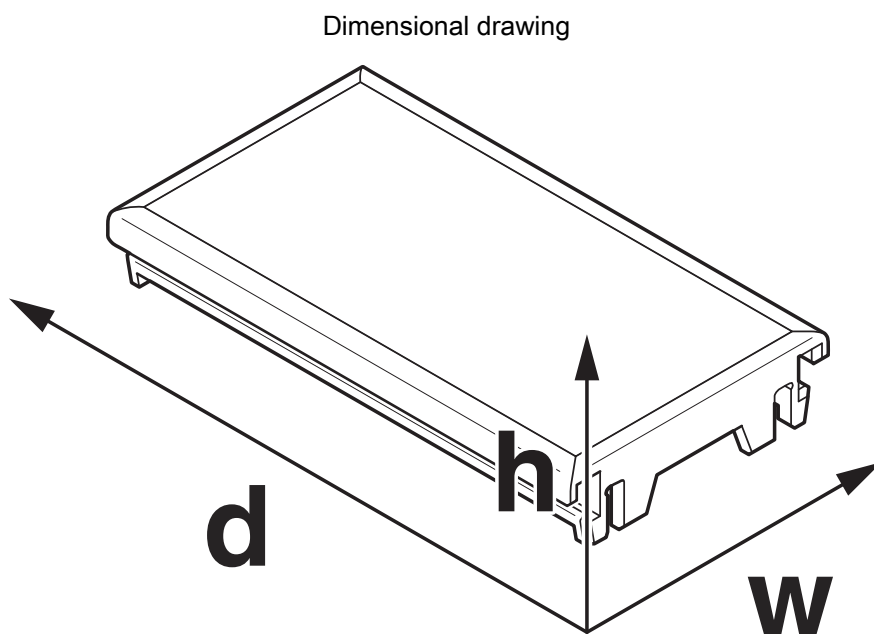

Schematic figure for illustrating the item dimensions. The figure is not of the desired product. For further details, refer to the product drawings in the "Downloads" tab.

# ICS20-F90V-9005 - Connection plate



1287437

<https://www.phoenixcontact.com/us/products/1287437>

## Classifications

### ECLASS

|             |          |
|-------------|----------|
| ECLASS-13.0 | 27190605 |
| ECLASS-15.0 | 27190605 |

### ETIM

|          |          |
|----------|----------|
| ETIM 9.0 | EC002779 |
|----------|----------|

### UNSPSC

|             |          |
|-------------|----------|
| UNSPSC 21.0 | 31261500 |
|-------------|----------|

# ICS20-F90V-9005 - Connection plate



1287437

<https://www.phoenixcontact.com/us/products/1287437>

## Environmental product compliance

### EU RoHS

|   |                    |
|---|--------------------|
| Fulfills EU RoHS substance requirements | Yes, No exemptions |
|---|--------------------|

### China RoHS

|  |  |
|--|--|
| Environment friendly use period (EFUP) | EFUP-E                                   |
|  | No hazardous substances above the limits |

### EU REACH SVHC

|                                     |                            |
|-------------------------------------|----------------------------|
| REACH candidate substance (CAS No.) | No substance above 0.1 wt% |
|-------------------------------------|----------------------------|

### EF3.1 Climate Change

|         |              |
|---------|--------------|
| CO2e kg | 0.05 kg CO2e |
|---------|--------------|

Phoenix Contact 2026 © - all rights reserved  
<https://www.phoenixcontact.com>

Phoenix Contact USA  
586 Fulling Mill Road  
Middletown, PA 17057, United States  
(+717) 944-1300  
[info@phoenixcon.com](mailto:info@phoenixcon.com)