

RC-09P1NC20000X - Contact insert



1240623

<https://www.phoenixcontact.com/us/products/1240623>

Please be informed that the data shown in this PDF document is generated from our online catalog. Please find the complete data in the user documentation. Our general terms of use for downloads are valid.



Contact insert, M23, number of positions: 8+1, contact connection type: Pin, Solder-in connection, series: RC, TU, Item is lead-free in accordance with RoHS II without Exemption 6c (Pb < 0.1 %)

The figure shows the 6-pos.
product version

Commercial data

Item number	1240623
Packing unit	10 pc
Minimum order quantity	10 pc
Product key	ABRAFU
GTIN	4063151426637
Weight per piece (including packing)	13.24 g
Weight per piece (excluding packing)	7.62 g
Country of origin	DE

RC-09P1NC20000X - Contact insert



1240623

<https://www.phoenixcontact.com/us/products/1240623>

Technical data

Product properties

Product type	Contact insert
Series	RC
	TU
Application	Signal
Number of positions	9
Connection profile	8+1
Coding	N
Thread type	M23

Electrical properties

Contact: Contact group 1

Contact diameter	2 mm
Nominal current I_N	20 A
Nominal voltage U_N	48 V AC
	74 V DC
Overvoltage category	III
Degree of pollution	3
Rated surge voltage	1.5 kV

Contact: Contact group 2

Contact diameter	1 mm
Nominal current I_N	8 A
Nominal voltage U_N	48 V AC
	74 V DC

Connection data

Connection method	Solder-in connection
-------------------	----------------------

Connector

Direction of rotation	Standard
-----------------------	----------

Mechanical properties

Mechanical data

Insertion/withdrawal cycles	50
-----------------------------	----

RC-09P1NC20000X - Contact insert



1240623

<https://www.phoenixcontact.com/us/products/1240623>

Drawings

Dimensional drawing

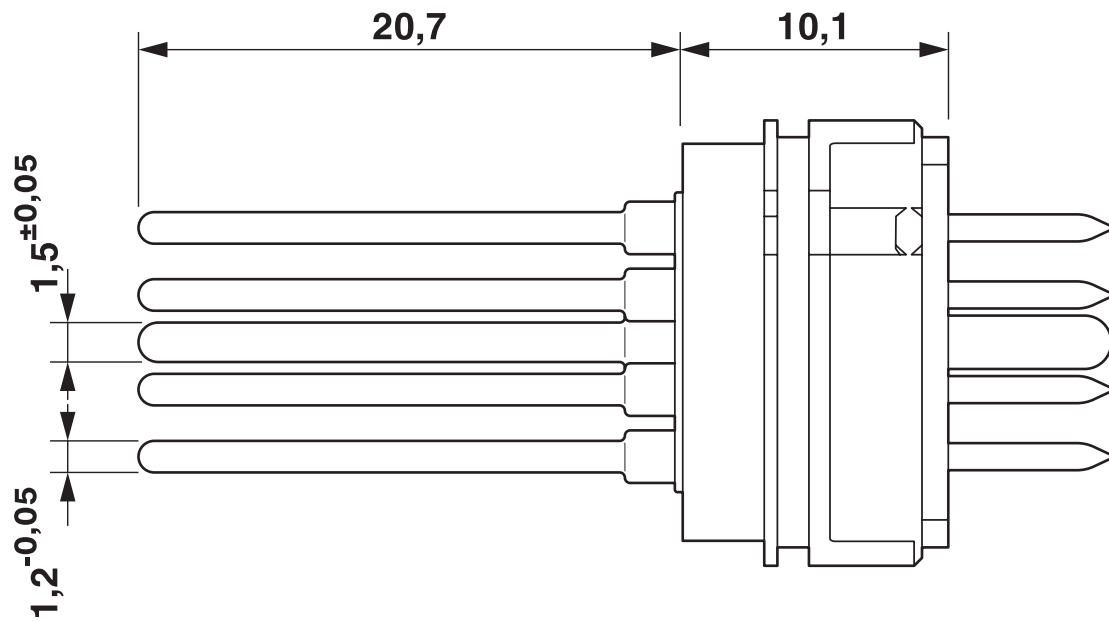

Dimensional drawing

RC-09P1NC20000X - Contact insert

1240623

<https://www.phoenixcontact.com/us/products/1240623>

Schematic diagram

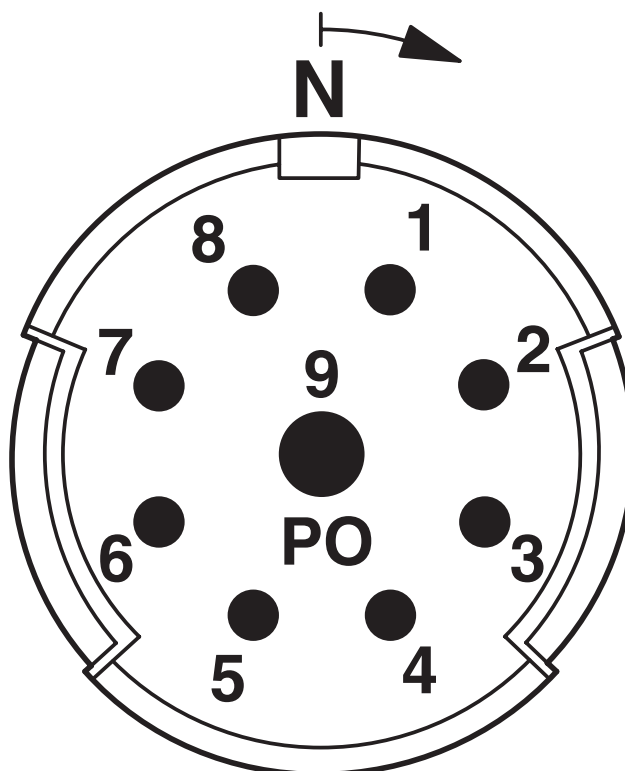

Connector pin assignment

RC-09P1NC20000X - Contact insert



1240623

<https://www.phoenixcontact.com/us/products/1240623>

Drilling plan/solder pad geometry

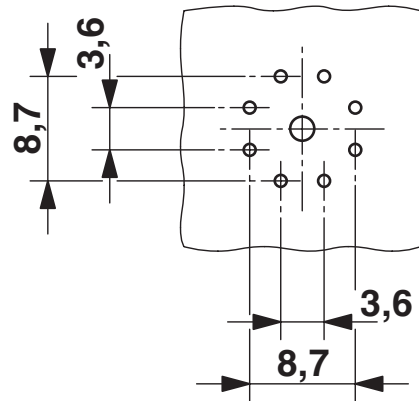

RC-09P1NC20000X - Contact insert



1240623

<https://www.phoenixcontact.com/us/products/1240623>

Classifications

ETIM

ETIM 9.0

EC003557

RC-09P1NC20000X - Contact insert



1240623

<https://www.phoenixcontact.com/us/products/1240623>

Environmental product compliance

EU RoHS

Fulfills EU RoHS substance requirements	Yes, No exemptions
---	--------------------

China RoHS

Environment friendly use period (EFUP)	EFUP-E
	No hazardous substances above the limits

EU REACH SVHC

REACH candidate substance (CAS No.)	No substance above 0.1 wt%
-------------------------------------	----------------------------

Phoenix Contact 2026 © - all rights reserved
<https://www.phoenixcontact.com>

Phoenix Contact USA
586 Fulling Mill Road
Middletown, PA 17057, United States
(+717) 944-1300
info@phoenixcon.com