

# NEARFI PD 2A ETH R - Inductive coupler



1234225

<https://www.phoenixcontact.com/us/products/1234225>

Please be informed that the data shown in this PDF document is generated from our online catalog. Please find the complete data in the user documentation. Our general terms of use for downloads are valid.



NearFi remote, contactless power and real-time Ethernet coupler, 50 W (US), 100 Mbps, range  $\leq 10$  mm, M12 screw connection, IP65, can be combined with NEARFI PD 2A ETH B. Incompatible with NEARFI 2200 (new)

## Product description

With the robust NEARFI-PD... NearFi couplers, you can transmit power (24 V DC / 2 A) and real-time Ethernet data (100 Mbps, full duplex) without contact across a distance in the centimeter range. Furthermore, the specially developed NearFi technology enables latency-free and protocol-independent Ethernet communication. At the same time, the limited wireless range of just a few centimeters also ensures security and permits parallel applications in the tightest of spaces. You can therefore replace wear-sensitive and maintenance-intensive connections and reduce downtimes in your systems.

## Your advantages

- Contactless - and therefore no wear and no maintenance
- High power in a compact housing
- Protocol-independent, latency-free Ethernet real-time communication with 100 Mbps (full duplex)
- All-round visible diagnostics with light ring on the housing
- High degree of mounting freedom with flexible proximity options
- Plug and Play - as easy as a plug
- Degree of protection IP65

## Commercial data

Item number	1234225
Packing unit	1 pc
Minimum order quantity	1 pc
Sales key	DN26
Product key	DNC691
GTIN	4063151337278
Weight per piece (including packing)	583.5 g
Weight per piece (excluding packing)	535 g
Customs tariff number	85176200
Country of origin	DE

# NEARFI PD 2A ETH R - Inductive coupler



1234225

<https://www.phoenixcontact.com/us/products/1234225>

## Technical data

### Product properties

Product type	Inductive coupler
Product family	NearFi
Application	Ethernet Power
MTTF	115 Years (SN 29500 standard, temperature 25°C, operating cycle 21%) 60 Years (SN 29500 standard, temperature 40°C, operating cycle 34.25%) 27 Years (SN 29500 standard, temperature 40°C, operating cycle 100%)

### Insulation characteristics

Overvoltage category	II
Pollution degree	2

### Electrical properties

Maximum power dissipation for nominal condition	0 W
---	-----

### Supply

Protective circuit	Short-circuit/overload protection
--------------------	-----------------------------------

### Output data

Output voltage	24 V DC $\pm 5\%$
Output current	$\leq 2$ A (typical) 3.5 A (Peak, for 20 ms, with 5 mm spacing)

### Connection data

#### Supply

Connection method	M12 female, A-coded
-------------------	---------------------

### Interfaces

Data: Ethernet interface, 100Base-T(X) in accordance with IEEE 802.3

Transmission speed	100 Mbps
Connection method	M12 female, D-coded
Note on the connection method	Auto negotiation and autocrossing, fast startup (FSU, <500 ms) Typical bit error rate $\leq 10^{-12}$
No. of channels	1
Transmission length	100 m (shielded twisted pair)
Transmission medium	Copper
Protocols supported	Protocol transparent: PROFINET, PROFINET IRT, PROFIsafe, EtherCAT®, Modbus/TCP, Powerlink, TSN, etc.

# NEARFI PD 2A ETH R - Inductive coupler



1234225

<https://www.phoenixcontact.com/us/products/1234225>

## Inductive: Power transmission

Switch-on time	< 450 ms (ETH Full Duplex operating mode)
Range	min. 0 mm
	≤ 10 mm (at 55°C)
	≤ 12 mm (at 25 °C)
Center offset	± 5 mm
Wireless modules that can be connected	1 (Base coupler)
Frequency range	100 kHz ... 148.5 kHz (Power transmission)

## Wireless

Wireless modules that can be connected	1 (Base coupler)
Frequency	60 GHz
Frequency range	57 GHz ... 64 GHz (Data transmission)
Transmission power	< 10 mW (EIRP)
Delay time	≤ 1 μs (typical)

## Dimensions

Dimensional drawing	
Width	80 mm
Height	86 mm
Depth	39 mm

## Material specifications

Color (Housing)	black (RAL 9005)
Material (Enclosure)	PBT
	Die-cast zinc
Flammability rating according to UL 94	V0

## Cable/line

Other resistance	Resistant to welding splashes
	Resistant to salt spray in accordance with IEC 60068-2-11 (96 h in 5% salt spray)

## Mechanical tests

Vibration resistance in accordance with EN 60068-2-6/IEC 60068-2-6	Vibration (operation): 5 g per spatial direction, 10 Hz ... 150 Hz, amplitude ±0.34 mm
Shock in accordance with EN 60068-2-27/IEC 60068-2-27	Shock (operation): 30 g, 11 ms duration, half-sine shock pulse, three shocks per spatial direction

# NEARFI PD 2A ETH R - Inductive coupler



1234225

<https://www.phoenixcontact.com/us/products/1234225>

Continuous shock in accordance with EN 60068-2-27/IEC 60068-2-27	Continuous shock (operation): 10 g, 16 ms duration, half-sine shock pulse, 1,000 shocks per spatial direction
--	---

## Environmental and real-life conditions

### Ambient conditions

Degree of protection	IP65 (Manufacturer's declaration)
Impact strength	IK06
Ambient temperature (operation)	-20 °C ... 55 °C (observe derating)
Ambient temperature (storage/transport)	-40 °C ... 85 °C
Altitude	2000 m
Permissible humidity (operation)	10 % ... 95 %
Permissible humidity (storage/transport)	10 % ... 95 %
Air pressure (operation)	80 kPa ... 108 kPa (up to 2000 m above sea level)
Air pressure (storage/transport)	66 kPa ... 108 kPa (up to 3500 m above sea level)

## Approvals

### CE

Certificate	CE-compliant
-------------	--------------

### Wireless approval, Europe

Note	RED 2014/53/EU
------	----------------

### UL, USA

Identification	UL 61010 Recognized
	UL 61010-2-201, 2nd Edition
	UL 61010-1, 3rd Edition
Certificate	E238705

### UL, Canada

Identification	cUL 61010 Recognized
	CSA C22.2 NO. 61010-2-201:18, 2nd Edition
	CSA C22.2 NO. 61010-1, 3rd Edition
Certificate	E238705

### Wireless approval USA, FCC

Certificate	YG3PD2AETHR
-------------	-------------

### Wireless approval Japan, MIC

Identification	006-001059
----------------	------------

### KC approval for South Korea

Certificate	R-R-PCK-1234232
-------------	-----------------

### CC-Link IE TSN

Identification	Class A
----------------	---------

## EMC data

# NEARFI PD 2A ETH R - Inductive coupler



1234225

<https://www.phoenixcontact.com/us/products/1234225>

Electromagnetic compatibility	Conformance with EMC Directive 2014/30/EU
Electrostatic discharge	
Standards/regulations	EN 61000-4-2
Electrostatic discharge	
Contact discharge	± 4 kV (Test Level 2)
Discharge in air	± 8 kV (Test Level 3)
Comments	Criterion B
Electromagnetic HF field	
Standards/regulations	EN 61000-4-3
Electromagnetic HF field	
Frequency range	80 MHz ... 1 GHz (Test Level 3)
Field intensity	10 V/m
Comments	Criterion A
Fast transients (burst)	
Standards/regulations	EN 61000-4-4
Fast transients (burst)	
Input	± 2 kV (Test Level 3 - asymmetrical)
Output	± 2 kV (Test Level 3 - asymmetrical)
Signal	± 2 kV (Test Level 3 - asymmetrical)
Comments	Criterion B
Surge current load (surge)	
Standards/regulations	EN 61000-4-5
Surge current load (surge)	
Input	± 0.5 kV (Test Level 1 - symmetrical)
	± 1 kV (Test Level 2 - asymmetrical)
Output	± 1 kV (Test Level 2 - asymmetrical)
Signal	± 1 kV (Test Level 2 - asymmetrical)
Comments	Criterion B
Conducted interference	
Standards/regulations	EN 61000-4-6
Conducted interference	
Frequency range	0.15 MHz ... 80 MHz (Test Level 3 - asymmetrical)
Comments	Criterion A
Voltage	10 V (80% amplitude modulation with 1 kHz)
Emitted interference	
Standards/regulations	EN 55016-2-3
Comments	Class A, industrial applications

# NEARFI PD 2A ETH R - Inductive coupler



1234225

<https://www.phoenixcontact.com/us/products/1234225>

## Criteria

Criterion A	Normal operating behavior within the specified limits.
Criterion B	Temporary impairment to operational behavior that is corrected by the device itself.

## Standards and regulations

Free from substances that could impair the application of coating	VDMA 24364:2018-05
Other resistance	Resistant to welding splashes
	Resistant to salt spray in accordance with IEC 60068-2-11 (96 h in 5% salt spray)
Standards/regulations	EN 60204-1 (PELV)
Standard designation	Protective extra-low voltage

## Mounting

Mounting type	Panel mounting
Assembly note	Observe derating
Mounting position	any

# NEARFI PD 2A ETH R - Inductive coupler

1234225

<https://www.phoenixcontact.com/us/products/1234225>



## Drawings

Dimensional drawing

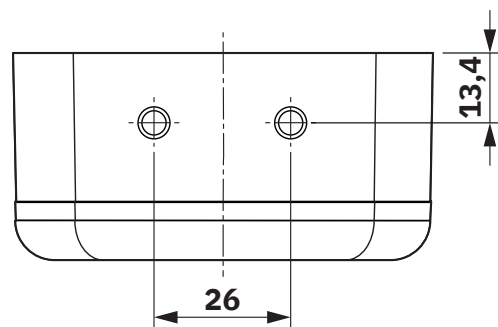
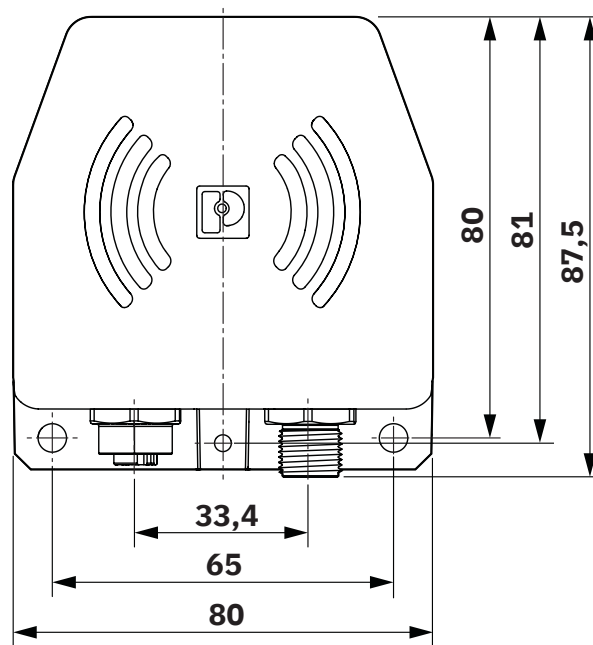
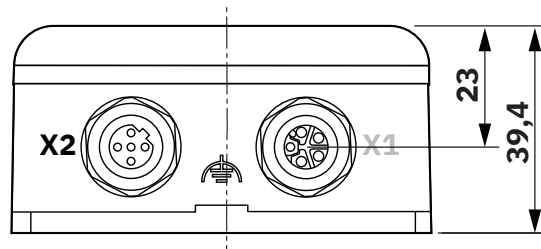

Dimensional drawing

# NEARFI PD 2A ETH R - Inductive coupler

1234225

<https://www.phoenixcontact.com/us/products/1234225>

## Schematic diagram

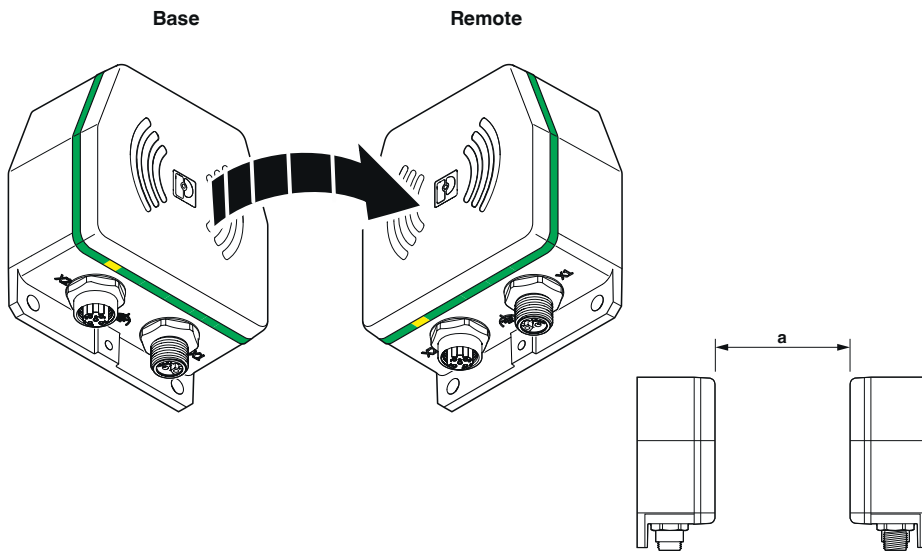

## Method of operation

### Schematic diagram

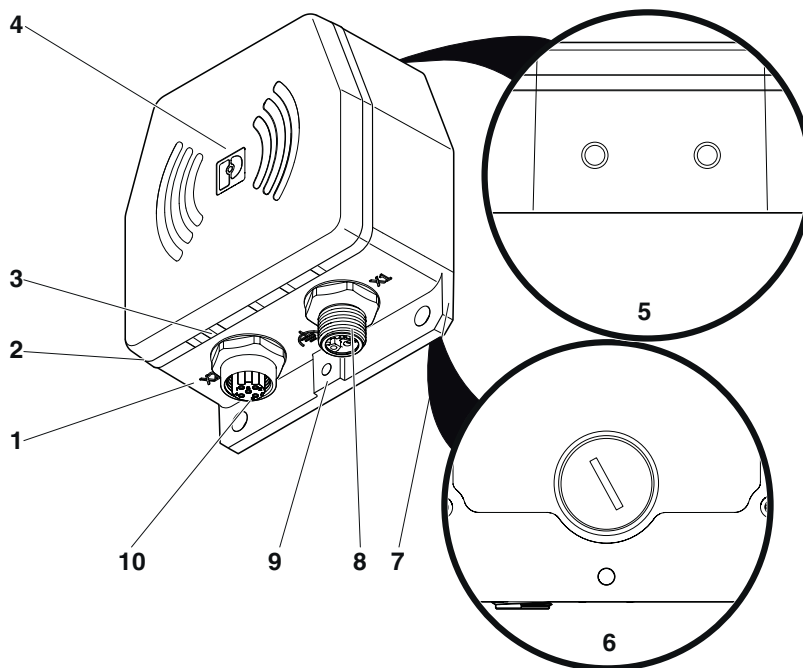

## Function elements

# NEARFI PD 2A ETH R - Inductive coupler

1234225

<https://www.phoenixcontact.com/us/products/1234225>

Schematic diagram

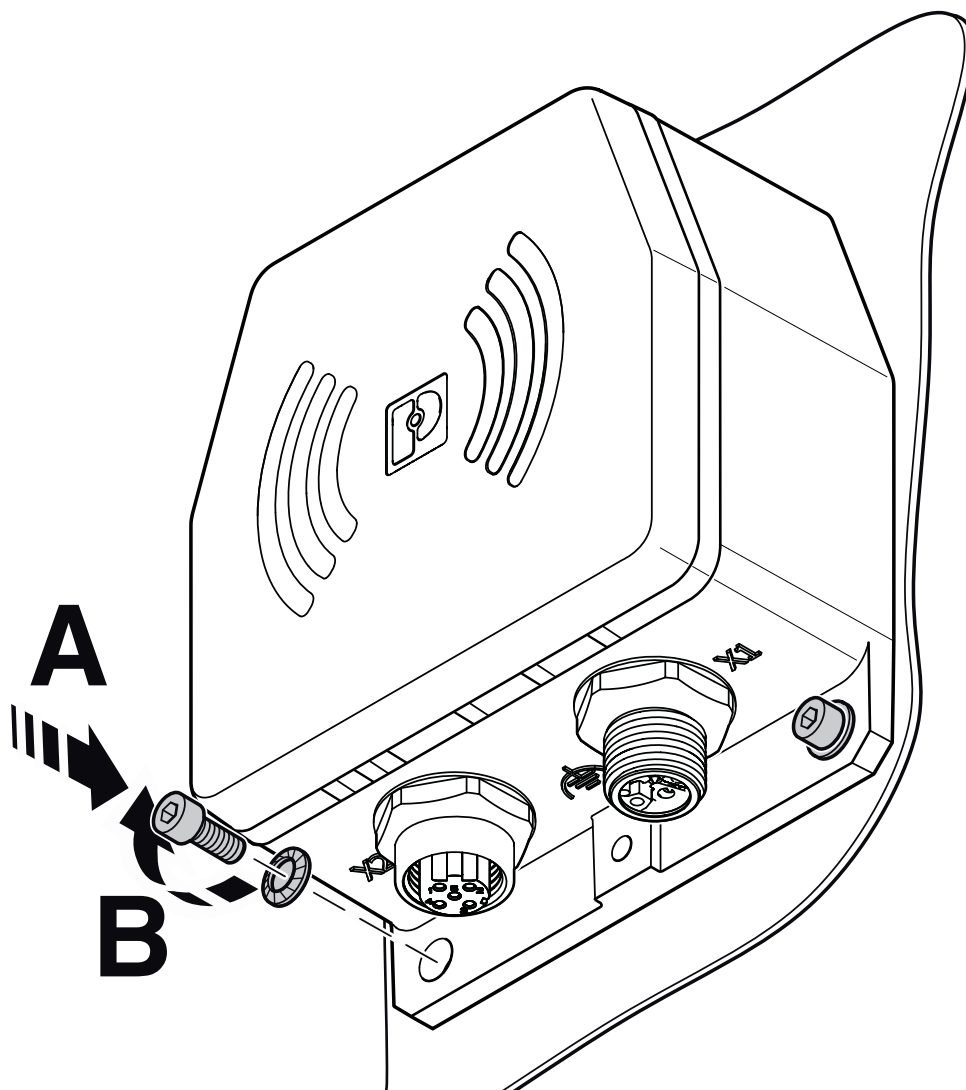

Mounting with two screws

# NEARFI PD 2A ETH R - Inductive coupler

1234225

<https://www.phoenixcontact.com/us/products/1234225>

Schematic diagram



Mounting with four screws

Schematic diagram

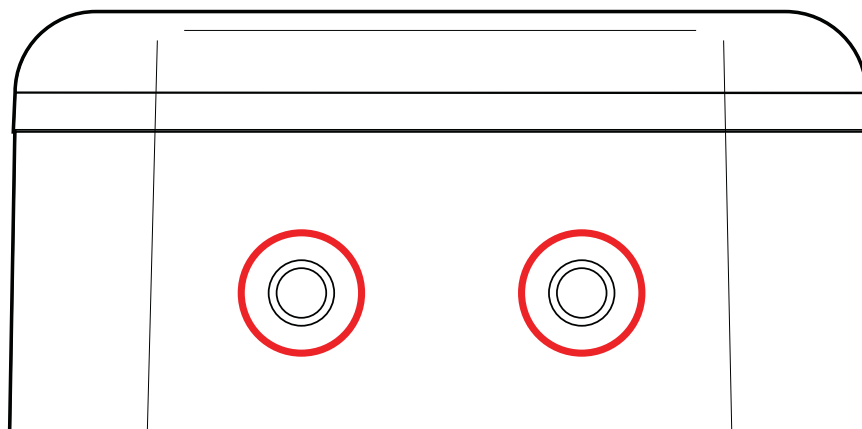

Mounting option

# NEARFI PD 2A ETH R - Inductive coupler

1234225

<https://www.phoenixcontact.com/us/products/1234225>

Schematic diagram

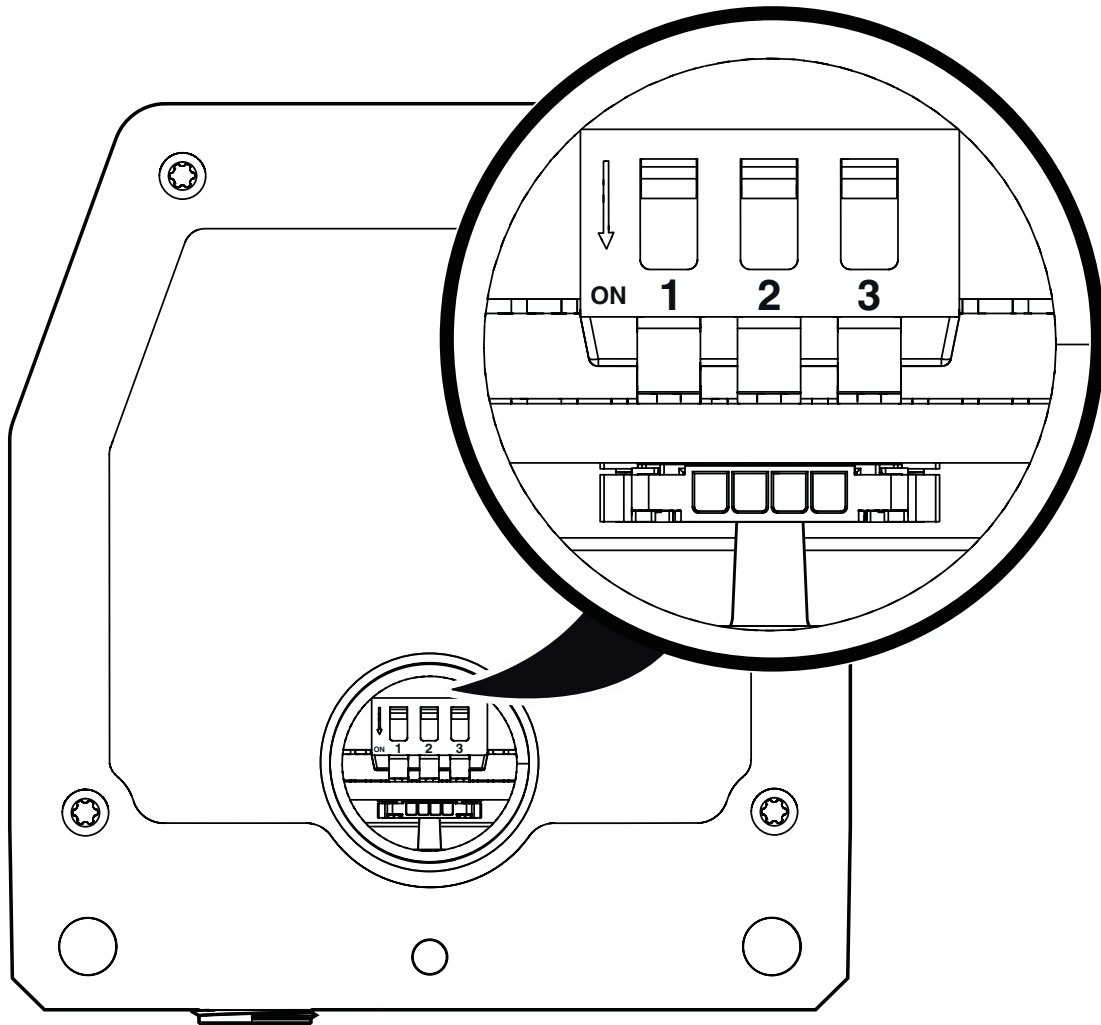

DIP switches

# NEARFI PD 2A ETH R - Inductive coupler

1234225

<https://www.phoenixcontact.com/us/products/1234225>

Schematic diagram

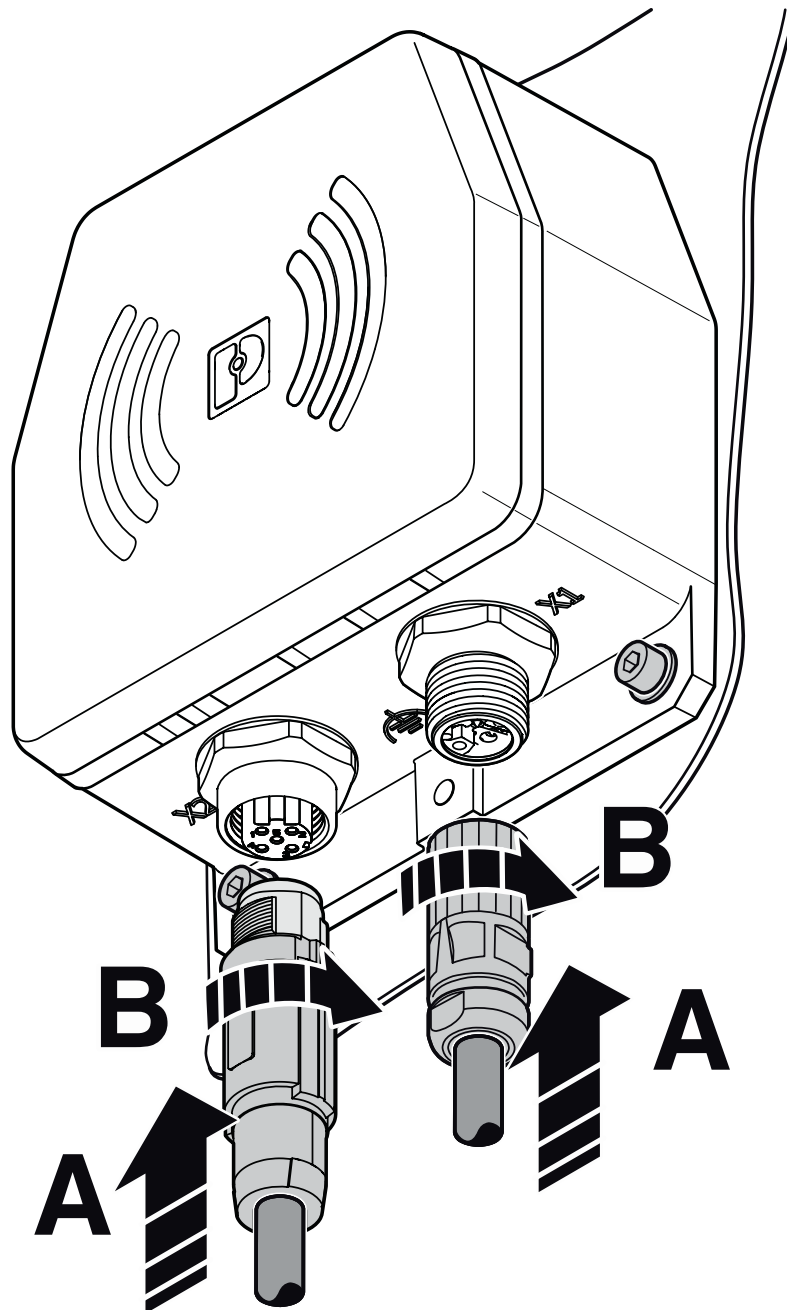

Connecting the cables

# NEARFI PD 2A ETH R - Inductive coupler

1234225

<https://www.phoenixcontact.com/us/products/1234225>

Schematic diagram

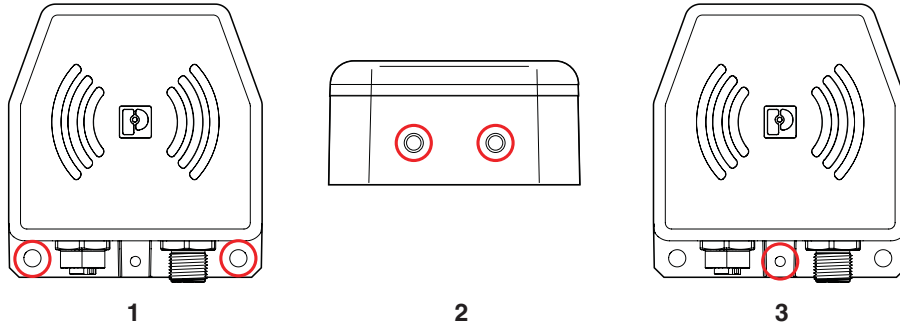

Options for functional grounding

Drilling plan/solder pad geometry

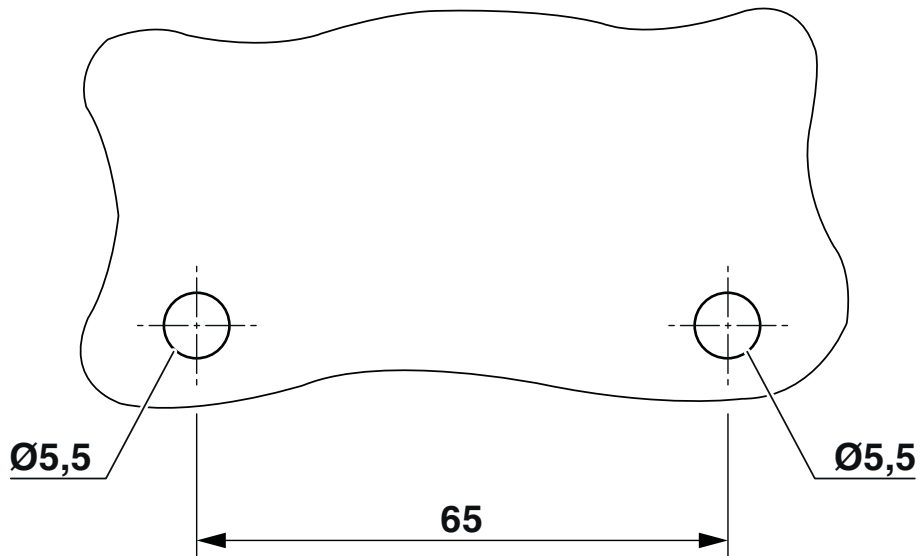

Drilling diagram

# NEARFI PD 2A ETH R - Inductive coupler



1234225

<https://www.phoenixcontact.com/us/products/1234225>

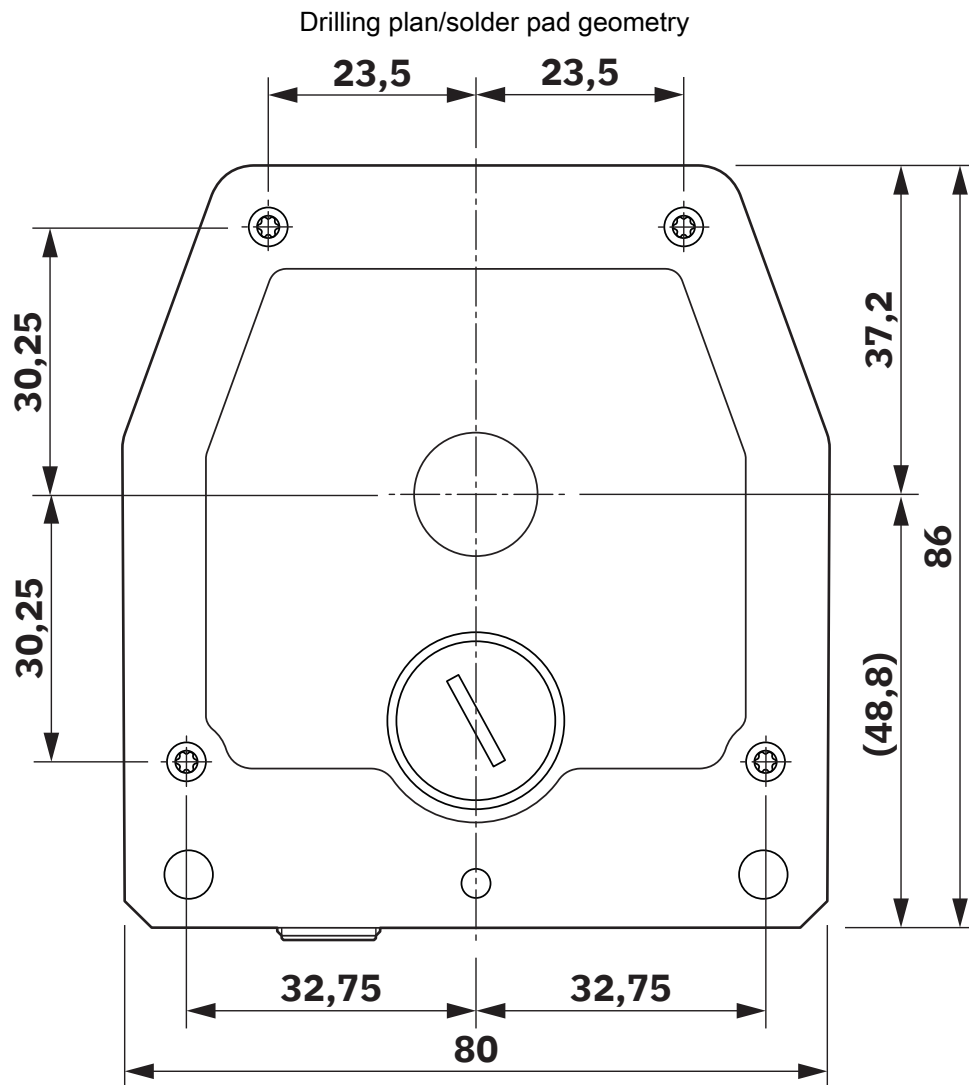

Centering template

# NEARFI PD 2A ETH R - Inductive coupler

1234225

<https://www.phoenixcontact.com/us/products/1234225>

Block diagram

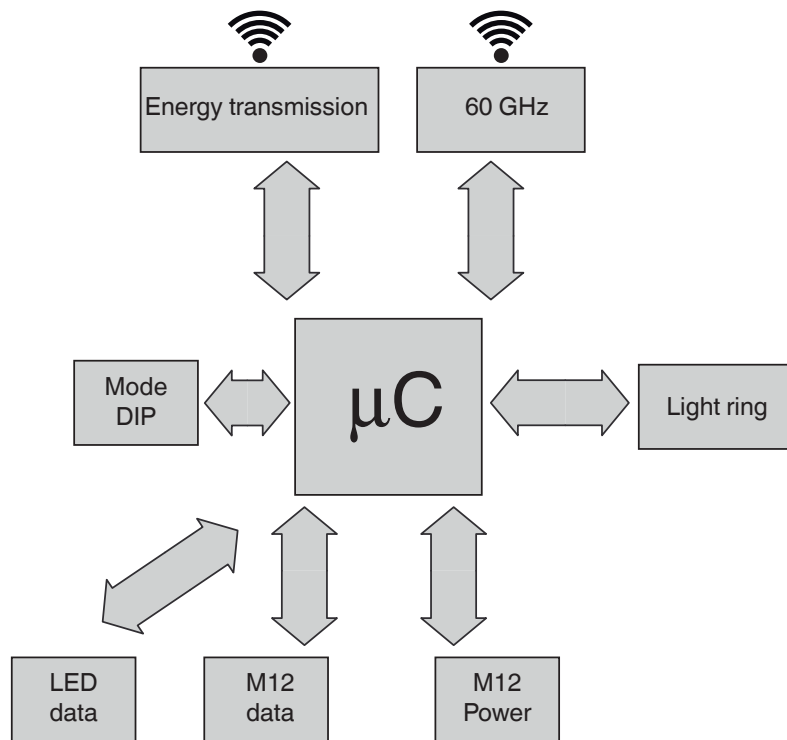

Basic circuit diagram

# NEARFI PD 2A ETH R - Inductive coupler



1234225

<https://www.phoenixcontact.com/us/products/1234225>

## Approvals

To download certificates, visit the product detail page: <https://www.phoenixcontact.com/us/products/1234225>



**MIC**

Approval ID: 006-001059



**cULus Recognized**

Approval ID: E238705

**FCC**

Approval ID: YG3PD2AETHR



**KC**

Approval ID: R-R-PCK-1234232

# NEARFI PD 2A ETH R - Inductive coupler



1234225

<https://www.phoenixcontact.com/us/products/1234225>

## Classifications

### ECLASS

ECLASS-13.0	27040701
ECLASS-15.0	19170417

### ETIM

ETIM 10.0	EC001467
-----------	----------

### UNSPSC

UNSPSC 21.0	39121000
-------------	----------

# NEARFI PD 2A ETH R - Inductive coupler



1234225

<https://www.phoenixcontact.com/us/products/1234225>

## Environmental product compliance

### EU RoHS

Fulfills EU RoHS substance requirements	Yes
Exemption	6(c)

### China RoHS

Environment friendly use period (EFUP)	EFUP-50
	An article-related China RoHS declaration table can be found in the download area for the respective article under "Manufacturer declaration". For all articles with EFUP-E, no China RoHS declaration table issued and required.

### EU REACH SVHC

REACH candidate substance (CAS No.)	Lead(CAS: 7439-92-1)
SCIP	0bc4976f-6d82-4dbe-9f02-2cb510a9e30a

Phoenix Contact 2026 © - all rights reserved

<https://www.phoenixcontact.com>

Phoenix Contact USA  
586 Fulling Mill Road  
Middletown, PA 17057, United States  
(+717) 944-1300  
[info@phoenixcon.com](mailto:info@phoenixcon.com)