

FL WLAN 4321 - Wireless set

1194423

<https://www.phoenixcontact.com/us/products/1194423>

Please be informed that the data shown in this PDF document is generated from our online catalog. Please find the complete data in the user documentation. Our general terms of use for downloads are valid.



Pre-configured point-to-point Ethernet bridge for U.S. and Canada with internal antennas for pole mounting. IP67, wireless Ethernet communication up to 300 Mbps, frequency: 5 GHz, 10/100/1000 Mbps RJ45, passive PoE (8 - 30 V DC) powered.

Commercial data

Item number	1194423
Packing unit	1 pc
Minimum order quantity	1 pc
Sales key	DN16
Product key	DNN2W3
GTIN	4063151249519
Weight per piece (including packing)	2,380 g
Weight per piece (excluding packing)	2,220 g
Customs tariff number	85176200
Country of origin	PL

Technical data

Notes

Note on application

Note on application	Only for industrial use
---------------------	-------------------------

Product properties

Product type	Wireless module
Type	Stand-alone

Wireless card

Number	1
Type	IEEE 802.11 b/g/n 5 GHz to 300 Mbps
Assembly note	Permanently installed

Electrical properties

Supply: Module electronics

Supply voltage	120 V AC (converted to 24 V DC via passive POE adapter (included))
Current consumption	417 mA (maximum (at 24 V))
Power consumption	11 W (maximum (at 24 V))

Interfaces

Antenna

Number	1
Connection method	permanently installed
Note on the connection method	Dual polarized: Horizontal and vertical
Gain	11 dBi

Functions

Security	256-bit AES-CCM Encryption
	WPA2
Wireless licenses	USA, Canada
Country support	USA
	Canada

Ethernet (RJ45)

Number of interfaces	1 (Passive PoE)
Connection method	RJ45
Note on the connection method	Auto negotiation and autocrossing
Transmission speed	10/100/1000 Mbps
Transmission physics	Copper
Number of interfaces	1 (Passive PoE)

FL WLAN 4321 - Wireless set

1194423

<https://www.phoenixcontact.com/us/products/1194423>

Wireless

Designation	Wireless LAN
Antenna connection method	(Internal)
Frequency band	5 GHz
Wireless standard	IEEE 802.11 (Wi-Fi Alliance) b (Wi-Fi 1) g (Wi-Fi 3) n (Wi-Fi 4)
Number of wireless interfaces	1 IEEE 802.11 b/g/n
Wireless modules that can be connected	1 (non-configurable, pre-paired)

Dimensions

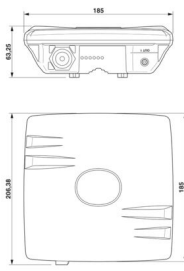
Dimensional drawing	
Width	185 mm
Height	63.5 mm
Depth	185 mm
Note on dimensions	Outside dimensions

Material specifications

Color	white
Housing material	Polystyrene

Environmental and real-life conditions

Ambient conditions

Degree of protection	IP67
Ambient temperature (operation)	-40 °C ... 75 °C
Ambient temperature (storage/transport)	-45 °C ... 85 °C
Permissible humidity (operation)	5 % ... 95 % (non-condensing)
Permissible humidity (storage/transport)	5 % ... 95 % (non-condensing)

EMC data

Emitted interference

Standards/regulations	FCC Part 15B
Test result	Class A

Emitted interference

FL WLAN 4321 - Wireless set



1194423

<https://www.phoenixcontact.com/us/products/1194423>

Standards/regulations	FCC Part 15C
-----------------------	--------------

Mounting

Mounting type	Mast mounting
Assembly note	Internal antenna

FL WLAN 4321 - Wireless set

1194423

<https://www.phoenixcontact.com/us/products/1194423>

Drawings

Dimensional drawing

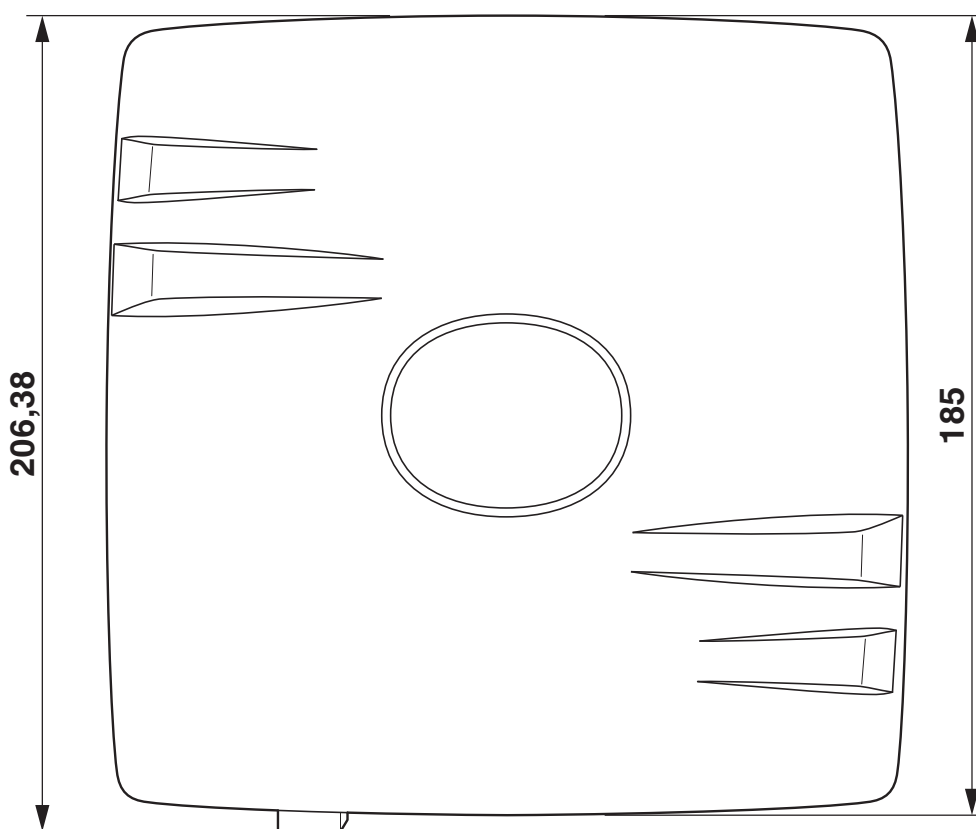
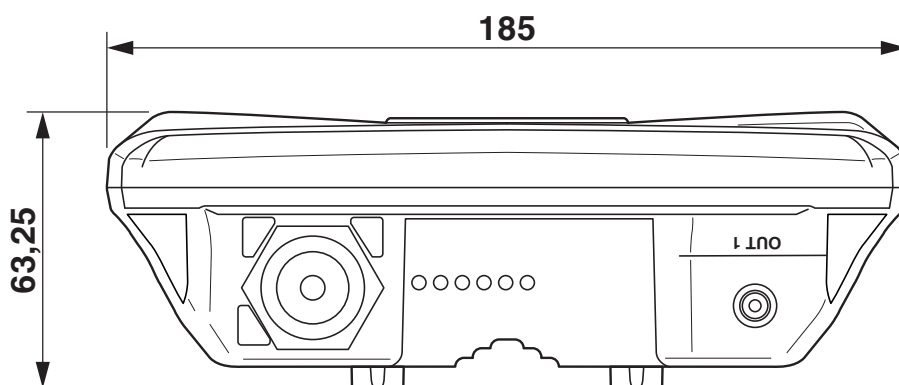

FL WLAN 4321 - Wireless set

1194423

<https://www.phoenixcontact.com/us/products/1194423>



Application drawing

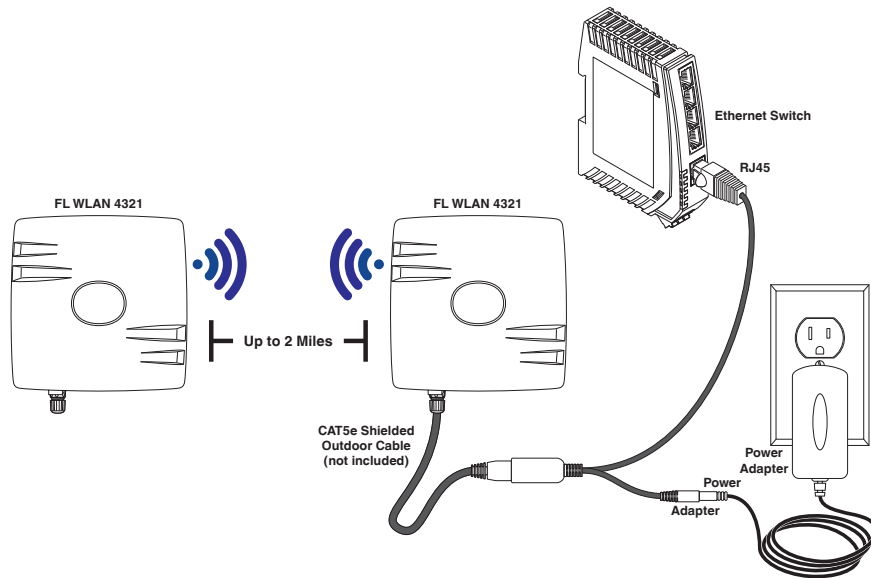

FL WLAN 4321 - Wireless set



1194423

<https://www.phoenixcontact.com/us/products/1194423>

Classifications

ECLASS

ECLASS-13.0

19170501

ETIM

ETIM 9.0

EC000816

FL WLAN 4321 - Wireless set



1194423

<https://www.phoenixcontact.com/us/products/1194423>

Environmental product compliance

EU RoHS

Fulfills EU RoHS substance requirements	Not applicable, No electrical and electronic equipment (EEE), cannot be used in EEE
---	---

EU REACH SVHC

REACH candidate substance (CAS No.)	No substance above 0.1 wt%
-------------------------------------	----------------------------

Phoenix Contact 2026 © - all rights reserved

<https://www.phoenixcontact.com>

Phoenix Contact USA
586 Fulling Mill Road
Middletown, PA 17057, United States
(+717) 944-1300
info@phoenixcon.com