

EO-CF/PT - Socket



0804038

<https://www.phoenixcontact.com/us/products/0804038>

Please be informed that the data shown in this PDF document is generated from our online catalog. Please find the complete data in the user documentation. Our general terms of use for downloads are valid.



Socket, Pin connector pattern type CF, connection method: Push-in spring connection, color: gray, nom. voltage: 250 V AC (50 Hz), nominal current: 16 A, for mounting on a DIN rail in the service interface or direct mounting, standards/specifications: VDE 0620-1, IEC 60884-1, Country marking: Germany

Commercial data

| | |
|--------------------------------------|---------------|
| Item number | 0804038 |
| Packing unit | 5 pc |
| Minimum order quantity | 5 pc |
| Sales key | BE76 |
| Product key | BE7621 |
| GTIN | 4055626225784 |
| Weight per piece (including packing) | 73.6 g |
| Weight per piece (excluding packing) | 61.922 g |
| Customs tariff number | 85366990 |
| Country of origin | PL |

Technical data

Notes

| | |
|--------------------|--|
| Notes on operation | This socket is not designed for applications with high loads (HL), such as chargers for electric vehicles and large radiant heaters. |
|--------------------|--|

General

| | |
|------|--|
| Note | The nominal current does not apply for fuse versions. In this case, the current is determined by the fuse. |
|------|--|

Product properties

| | |
|--------------|---------|
| Product type | Socket |
| Country ID | Germany |

Electrical properties

| | |
|---|-------|
| Maximum power dissipation for nominal condition | 1.8 W |
|---|-------|

Connection data

| | |
|---|--|
| Connection method | Push-in spring connection |
| Note | The electrical outlets with Push-in connection are not designed for through-wiring. Connect a maximum of one conductor to each terminal point. Multiple assignment of one terminal point is not permitted. |
| Stripping length | 10 mm |
| Internal cylindrical gage | A3 B3 |
| Conductor cross-section rigid | 0.2 mm ² ... 4 mm ² |
| Cross section AWG | 24 ... 12 (converted acc. to IEC) |
| Conductor cross-section flexible | 0.25 mm ² ... 2.5 mm ² |
| Conductor cross-section, flexible [AWG] | 24 ... 14 (converted acc. to IEC) |
| Conductor cross-section flexible (ferrule without plastic sleeve) | 0.25 mm ² ... 2.5 mm ² |
| Flexible conductor cross-section (ferrule with plastic sleeve) | 0.25 mm ² ... 2.5 mm ² |
| Conductor cross-section flexible (2 conductors with the same cross-section, with TWIN ferrule and plastic sleeve) | 0.25 mm ² ... 2.5 mm ² |
| Nominal current | 16 A |
| Nominal voltage | 250 V AC (50 Hz) |

Connection cross sections directly pluggable

| | |
|---|---|
| Conductor cross-section rigid | 0.5 mm ² ... 4 mm ² |
| Conductor cross-section flexible (ferrule without plastic sleeve) | 1 mm ² ... 2.5 mm ² |
| Flexible conductor cross-section (ferrule with plastic sleeve) | 1 mm ² ... 2.5 mm ² |

Signaling

| | |
|----------------|----|
| Status display | no |
|----------------|----|

Dimensions

EO-CF/PT - Socket

0804038

<https://www.phoenixcontact.com/us/products/0804038>

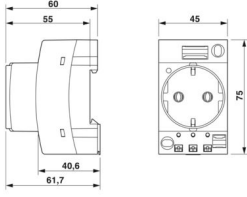
| Dimensional drawing |  |
|---------------------|--|
| Width | 45 mm |
| Height | 75 mm |
| Depth | 62.1 mm |
| Depth on NS 35/7,5 | 63 mm |
| Depth on NS 35/15 | 70.5 mm |
| Hole diameter | 4.4 mm |

Material specifications

| | |
|--|-----------------|
| Color | gray (RAL 7042) |
| Flammability rating according to UL 94 | V0 |
| Insulating material | PA |
| Contact material | CuZn38 |
| Static insulating material application in cold | -60 °C |
| Relative insulation material temperature index (Elec., UL 746 B) | 130 °C |
| Fire protection for rail vehicles (DIN EN 45545-2) R22 | HL 1 - HL 3 |
| Fire protection for rail vehicles (DIN EN 45545-2) R23 | HL 1 - HL 3 |
| Fire protection for rail vehicles (DIN EN 45545-2) R24 | HL 1 - HL 3 |
| Fire protection for rail vehicles (DIN EN 45545-2) R26 | HL 1 - HL 3 |
| Surface flammability NFPA 130 (ASTM E 162) | passed |
| Specific optical density of smoke NFPA 130 (ASTM E 662) | passed |
| Smoke gas toxicity NFPA 130 (SMP 800C) | passed |

Connector

| | |
|--------------|-------------------------------|
| Type of plug | Pin connector pattern type CF |
|--------------|-------------------------------|

Environmental and real-life conditions

Oscillation/broadband noise

| | |
|------------------------|--|
| Specification | DIN EN 50155 (VDE 0115-200):2022-06 |
| Spectrum | Long life test category 2, bogie-mounted |
| Frequency | $f_1 = 5 \text{ Hz}$ to $f_2 = 250 \text{ Hz}$ |
| ASD level | $6.12 \text{ (m/s}^2\text{)}^2\text{/Hz}$ |
| Acceleration | 3.12g |
| Test duration per axis | 5 h |
| Test directions | X-, Y- and Z-axis |
| Result | Test passed |

Shocks

EO-CF/PT - Socket



0804038

<https://www.phoenixcontact.com/us/products/0804038>

| | |
|--------------------------------|-------------------------------------|
| Specification | DIN EN 50155 (VDE 0115-200):2022-06 |
| Pulse shape | Half-sine |
| Acceleration | 30g |
| Shock duration | 18 ms |
| Number of shocks per direction | 3 |
| Test directions | X-, Y- and Z-axis (pos. and neg.) |
| Result | Test passed |

Ambient conditions

| | |
|--|--|
| Degree of protection | IP20 |
| Ambient temperature (operation) | -45 °C ... 70 °C (max. operating temperature range including self-heating, see derating curve) |
| Ambient temperature (storage/transport) | -45 °C ... 70 °C |
| Permissible humidity (storage/transport) | 30 % ... 70 % |
| Resistance against air humidity | 95 % ... 48 h |

Standards and regulations

Standards

| | |
|-----------------------|-------------|
| Standards/regulations | VDE 0620-1 |
| | IEC 60884-1 |

Mounting

| | |
|---------------|--|
| Mounting type | for mounting on a DIN rail in the service interface or direct mounting |
|---------------|--|

Drawings

Dimensional drawing

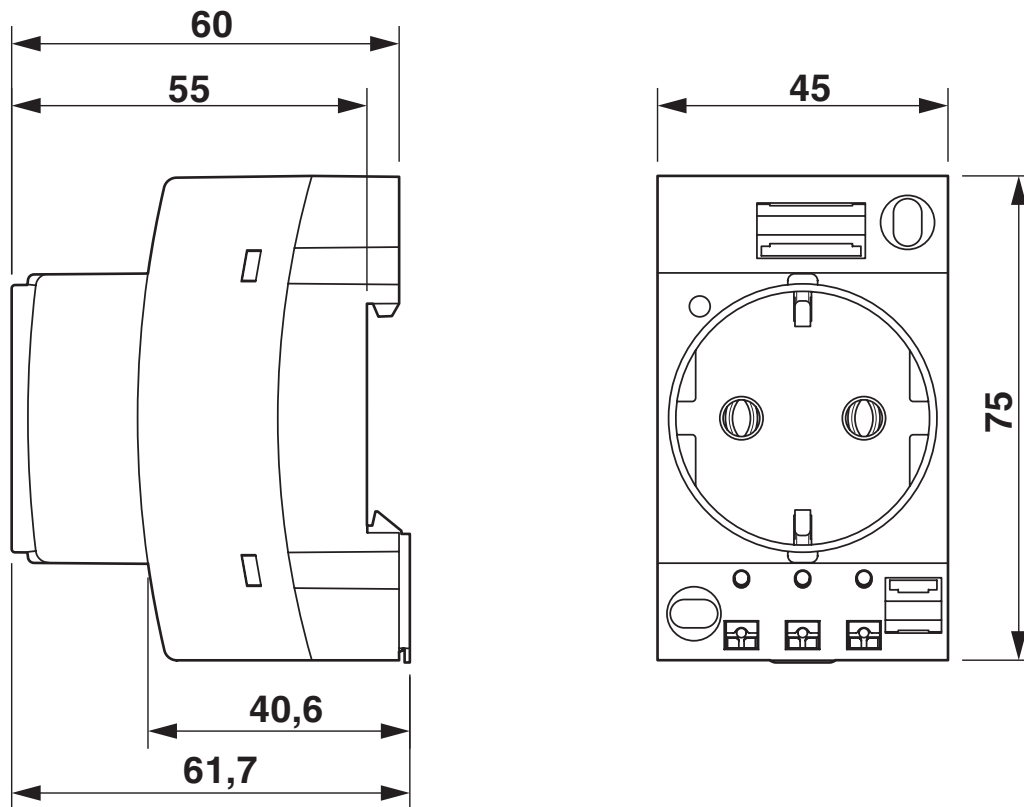

Diagram

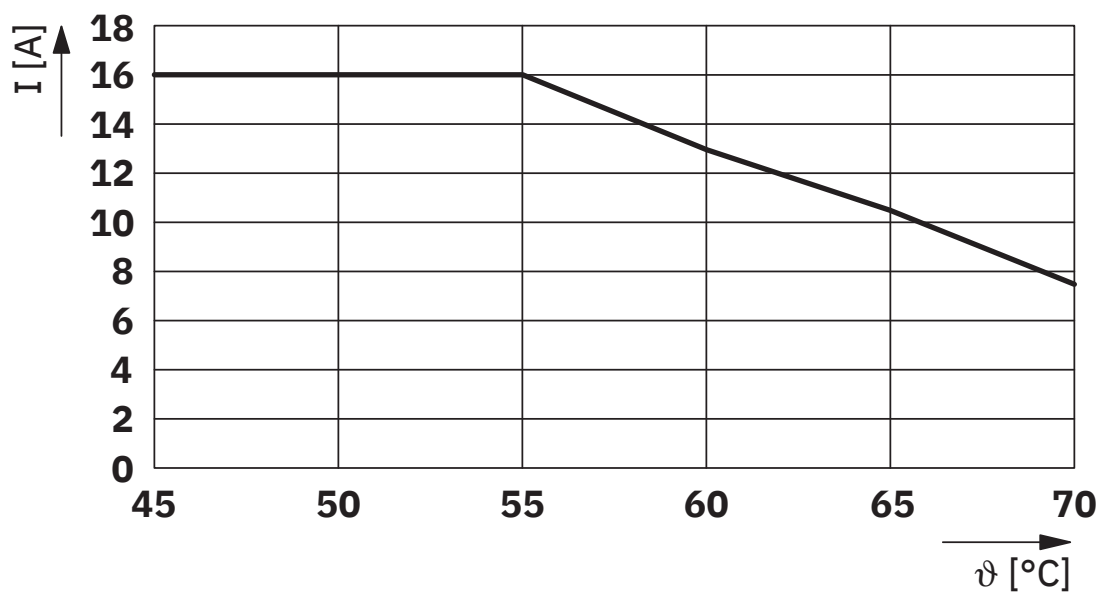

EO-CF/PT - Socket

0804038

<https://www.phoenixcontact.com/us/products/0804038>



Circuit diagram

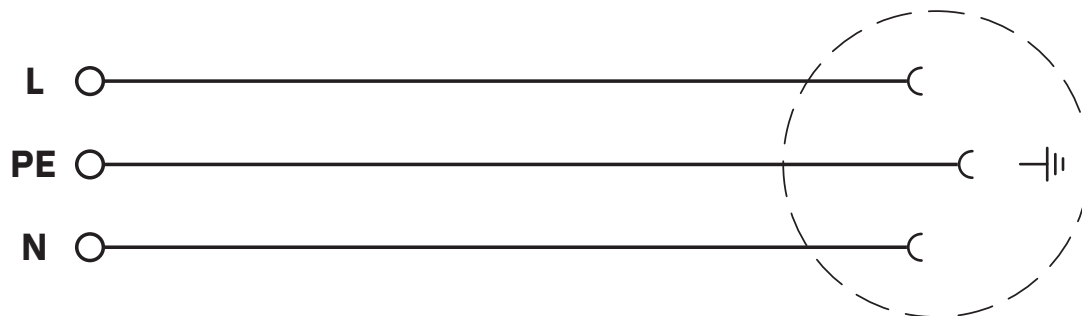

EO-CF/PT - Socket





0804038

<https://www.phoenixcontact.com/us/products/0804038>

Approvals

To download certificates, visit the product detail page: <https://www.phoenixcontact.com/us/products/0804038>

|  VDE Gutachten mit Fertigungsüberwachung Approval ID: 40047713 | | | | |
|---|-----------------------|-----------------------|-------------------|----------------------|
| | Nominal voltage U_N | Nominal current I_N | Cross section AWG | Cross section mm^2 |
| keine | | | | |
| | 250 V | 16 A | - | - |

|  EAC-RoHS Approval ID: RU D-DE.HB49.B.00025 | |
|--|--|
|--|--|

|  EAC Approval ID: KZ7500651131219505 | |
|---|--|
|---|--|

EO-CF/PT - Socket

0804038

<https://www.phoenixcontact.com/us/products/0804038>



Classifications

ECLASS

| | |
|-------------|----------|
| ECLASS-13.0 | 27142305 |
| ECLASS-15.0 | 27142305 |

ETIM

| | |
|-----------|----------|
| ETIM 10.0 | EC001663 |
|-----------|----------|

UNSPSC

| | |
|-------------|----------|
| UNSPSC 21.0 | 39121400 |
|-------------|----------|

EO-CF/PT - Socket



0804038

<https://www.phoenixcontact.com/us/products/0804038>

Environmental product compliance

EU RoHS

| | |
|---|--------------------|
| Fulfills EU RoHS substance requirements | Yes, No exemptions |
|---|--------------------|

China RoHS

| | |
|--|--|
| Environment friendly use period (EFUP) | EFUP-E |
| | No hazardous substances above the limits |

EU REACH SVHC

| | |
|-------------------------------------|----------------------------|
| REACH candidate substance (CAS No.) | No substance above 0.1 wt% |
|-------------------------------------|----------------------------|

EF3.1 Climate Change

| | |
|---------|---------------|
| CO2e kg | 0.489 kg CO2e |
|---------|---------------|

Phoenix Contact 2026 © - all rights reserved
<https://www.phoenixcontact.com>

Phoenix Contact USA
586 Fulling Mill Road
Middletown, PA 17057, United States
(+717) 944-1300
info@phoenixcon.com