

TW 95/ 1-CL - Panel feed-through terminal block



1708752

<https://www.phoenixcontact.com/us/products/1708752>

Please be informed that the data shown in this PDF document is generated from our online catalog. Please find the complete data in the user documentation. Our general terms of use for downloads are valid.



The figure shows a 1-pos. version of the product

Panel feed-through terminal block, connection method: T-LOX knee lever connection, Cable lug connection, number of positions: 1, load current: 232 A, connection direction of the conductor to plug-in direction: 0 °, width: 45 mm, color: gray

Your advantages

- Lever actuation enables time-saving and smooth connection of large conductors
- Defined contact force ensures that contact remains stable over the long term
- 90° open clamping space allows the conductor to be conveniently swiveled
- Quick, tool-free mounting on the housing wall using a fixing wedge

Commercial data

| | |
|--------------------------------------|--------------------------------|
| Item number | 1708752 |
| Packing unit | 10 pc |
| Minimum order quantity | 10 pc |
| Note | Made to order (non-returnable) |
| Sales key | AA28 |
| Product key | AA1GFA |
| GTIN | 4055626020372 |
| Weight per piece (including packing) | 258.1 g |
| Weight per piece (excluding packing) | 258 g |
| Customs tariff number | 85369010 |
| Country of origin | PL |

TW 95/ 1-CL - Panel feed-through terminal block



1708752

<https://www.phoenixcontact.com/us/products/1708752>

Technical data

Product properties

| | |
|-----------------------|-----------------------------------|
| Product type | Panel feed-through terminal block |
| Product family | TW 95/...-CL |
| Number of positions | 1 |
| Pitch | 26 mm |
| Number of connections | 2 |
| Number of rows | 1 |
| Number of potentials | 1 |

Insulation characteristics

| | |
|----------------------|-----|
| Overvoltage category | III |
| Degree of pollution | 3 |

Electrical properties

Properties

| | |
|-----------------------------|--------|
| Nominal current I_N | 232 A |
| Nominal voltage U_N | 1000 V |
| Rated voltage (III/3) | 1000 V |
| Rated surge voltage (III/3) | 8 kV |
| Rated voltage (III/2) | 1000 V |
| Rated surge voltage (III/2) | 8 kV |
| Rated voltage (II/2) | 1000 V |
| Rated surge voltage (II/2) | 6 kV |

Connection data

Connection technology

| | |
|-----------------------|--------------------|
| Connector system | TW 95 |
| Nominal cross section | 95 mm ² |

Conductor connection exterior

| | |
|---|---|
| Connection method | T-LOX knee lever connection |
| Connection direction of the conductor to plug-in direction | 0 ° |
| Single-conductor/terminal point multi-stranded | 25 mm ² ... 95 mm ² |
| Conductor cross-section flexible | 25 mm ² ... 95 mm ² |
| Conductor cross-section, flexible, with ferrule, without plastic sleeve | 25 mm ² ... 95 mm ² |
| Conductor cross-section, flexible, with ferrule, with plastic sleeve | 25 mm ² ... 95 mm ² |
| Stripping length | 25 mm |

Conductor connection interior

| | |
|--|----------------------|
| Connection method | Cable lug connection |
| Connection direction of the conductor to plug-in direction | 0 ° |

TW 95/ 1-CL - Panel feed-through terminal block



1708752

<https://www.phoenixcontact.com/us/products/1708752>

Mounting

| | |
|-----------------|-------------|
| Panel thickness | 1 mm...5 mm |
|-----------------|-------------|

Material specifications

Material data - contact

| | |
|-------------------------|--|
| Note | WEEE/RoHS-compliant, free of whiskers according to IEC 60068-2-82/JEDEC JESD 201 |
| Contact material | Cu alloy |
| Surface characteristics | tin-plated |

Material data - housing

| | |
|---|-------------|
| Color (Housing) | gray (7042) |
| Insulating material | PA |
| Insulating material group | I |
| CTI according to IEC 60112 | 600 |
| Flammability rating according to UL 94 | V0 |
| Glow wire flammability index GWFI according to EN 60695-2-12 | 850 |
| Glow wire ignition temperature GWIT according to EN 60695-2-13 | 775 |
| Temperature for the ball pressure test according to EN 60695-10-2 | 125 °C |

Notes

Safety note

| | |
|-------------|---|
| Safety note | <ul style="list-style-type: none"> • Only electrically qualified personnel may install and operate the product. To recognize and prevent danger, the qualified personnel must be familiar with the basics of electrical engineering. • Observe the technical data provided here and refer to the documents listed under "Downloads". The download area contains important information, such as installation notes, technical drawings, and 3D data. • The cable entry funnel is not safe to touch. Never connect or disconnect the terminal when it is energized. Take appropriate steps to ensure touch protection. |
|-------------|---|

Dimensions

| | |
|---------------------|-------|
| Dimensional drawing | |
| Pitch | 25 mm |
| | 25 mm |
| Width [w] | 45 mm |

TW 95/ 1-CL - Panel feed-through terminal block



1708752

<https://www.phoenixcontact.com/us/products/1708752>

External dimensions

| | |
|-------------|---------|
| Height [h1] | 81.8 mm |
| Length [l1] | 50.9 mm |

Internal dimensions

| | |
|-------------|----------|
| Height [h2] | 65.6 mm |
| Length [l2] | 67.15 mm |

Mechanical tests

Test for conductor damage and slackening

| | |
|---------------|-----------------------|
| Specification | IEC 60947-7-1:2009-04 |
| Result | Test passed |

Pull-out test

| | |
|---|--|
| Specification | IEC 60947-7-1:2009-04 |
| Conductor cross-section/conductor type/tractive force setpoint/actual value | 25 mm ² / solid / > 135 N |
| | 25 mm ² / flexible / > 135 N |
| | 95 mm ² / solid / > 351 N |
| | 95 mm ² / flexible / > 351 N |
| | 25 mm ² / flexible with ferrule / > 135 N |
| | 95 mm ² / flexible with ferrule / > 351 N |

Electrical tests

Temperature-rise test

| | |
|-----------------------------------|-----------------------------------|
| Specification | IEC 60947-7-1:2009-04 (following) |
| Requirement temperature-rise test | Increase in temperature ≤ 45 K |

Short-time withstand current

| | |
|---------------|-----------------------|
| Specification | IEC 60947-7-1:2009-04 |
|---------------|-----------------------|

Air clearances and creepage distances | 1. Insulation coordination

| | |
|--|----------------------------------|
| Specification | IEC 60947-1:2007-06 + A1:2010-12 |
| Insulating material group | I |
| Comparative tracking index (IEC 60112) | CTI 600 |
| Rated insulation voltage (III/3) | 1000 V |
| Rated surge voltage (III/3) | 8 kV |
| minimum clearance value - non-homogenous field (III/3) | 8 mm |
| minimum creepage distance (III/3) | 12.5 mm |
| Rated insulation voltage (III/2) | 1000 V |
| Rated surge voltage (III/2) | 8 kV |
| minimum clearance value - non-homogenous field (III/2) | 8 mm |
| minimum creepage distance (III/2) | 8 mm |
| Rated insulation voltage (II/2) | 1000 V |
| Rated surge voltage (II/2) | 6 kV |

TW 95/ 1-CL - Panel feed-through terminal block



1708752

<https://www.phoenixcontact.com/us/products/1708752>

| | |
|---|--------|
| minimum clearance value - non-homogenous field (II/2) | 5.5 mm |
| minimum creepage distance (II/2) | 5.5 mm |

Environmental and real-life conditions

Vibration test

| | |
|------------------------|-----------------------------|
| Specification | IEC 60068-2-6:2007-12 |
| Frequency | 10 - 150 - 10 Hz |
| Sweep speed | 1 octave/min |
| Amplitude | 0.35 mm (10 Hz ... 60.1 Hz) |
| Acceleration | 5g (60.1 Hz ... 150 Hz) |
| Test duration per axis | 2.5 h |
| Test directions | X-, Y- and Z-axis |

Glow-wire test

| | |
|------------------|------------------------|
| Specification | IEC 60695-2-11:2014-02 |
| Temperature | 960 °C |
| Time of exposure | 30 s |

Ambient conditions

| | |
|---|---|
| Ambient temperature (storage/transport) | -40 °C ... 70 °C |
| Relative humidity (storage/transport) | 30 % ... 70 % |
| Ambient temperature (assembly) | -5 °C ... 100 °C |
| Ambient temperature (operation) | -40 °C ... 100 °C (Depending on the current carrying capacity/derating curve) |

Ambient conditions

| | |
|---|---|
| Ambient temperature (operation) | -40 °C ... 100 °C (Depending on the current carrying capacity/derating curve) |
| Ambient temperature (storage/transport) | -40 °C ... 70 °C |
| Relative humidity (storage/transport) | 30 % ... 70 % |
| Ambient temperature (assembly) | -5 °C ... 100 °C |

Packaging specifications

| | |
|-------------------|---------------------|
| Type of packaging | packed in cardboard |
|-------------------|---------------------|

TW 95/ 1-CL - Panel feed-through terminal block

1708752

<https://www.phoenixcontact.com/us/products/1708752>

Drawings

Dimensional drawing

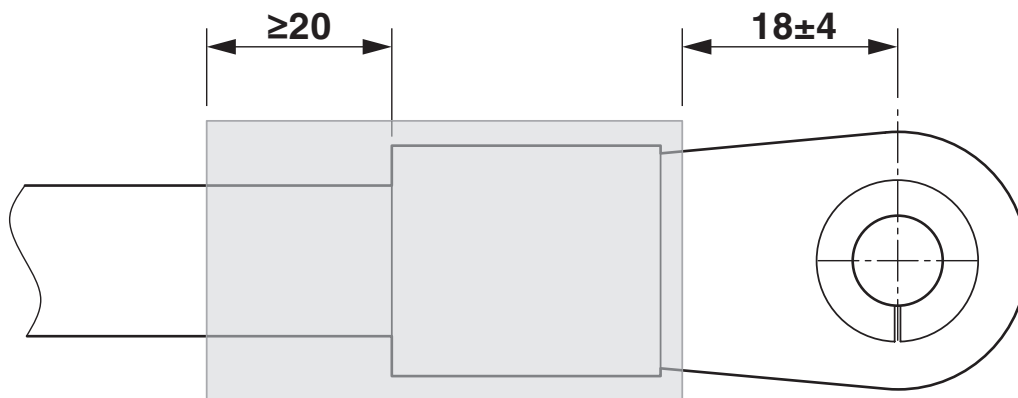

Electric strength > 19.7 kV/mm (IEC243), min. Wall thickness, fully shrunk ≥ 0.5 mm

Diagram

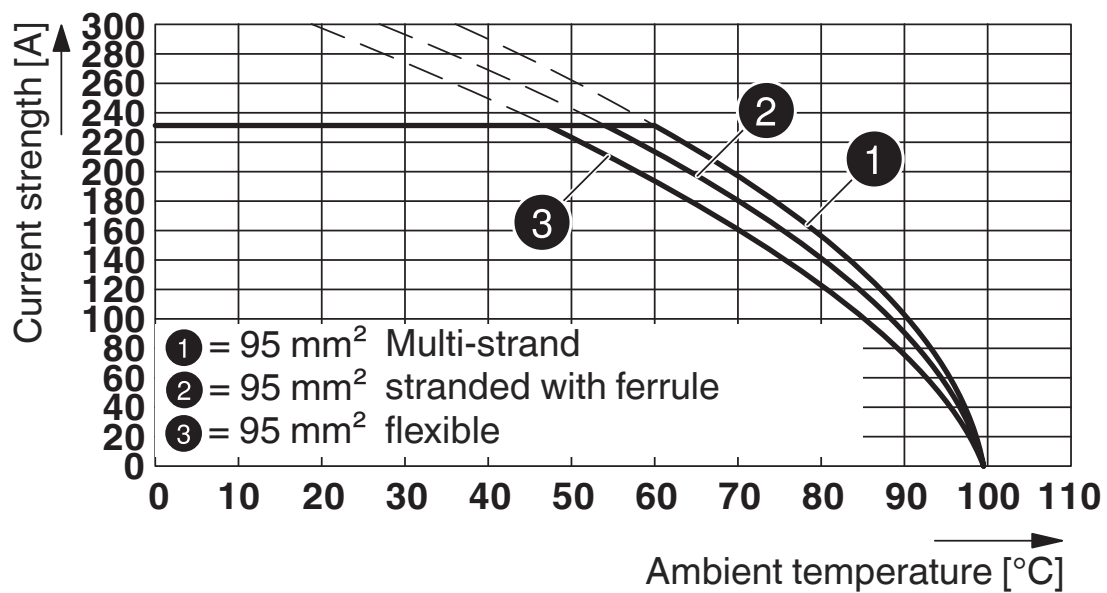

Type: TW 95/...-CL

TW 95/ 1-CL - Panel feed-through terminal block

1708752

<https://www.phoenixcontact.com/us/products/1708752>

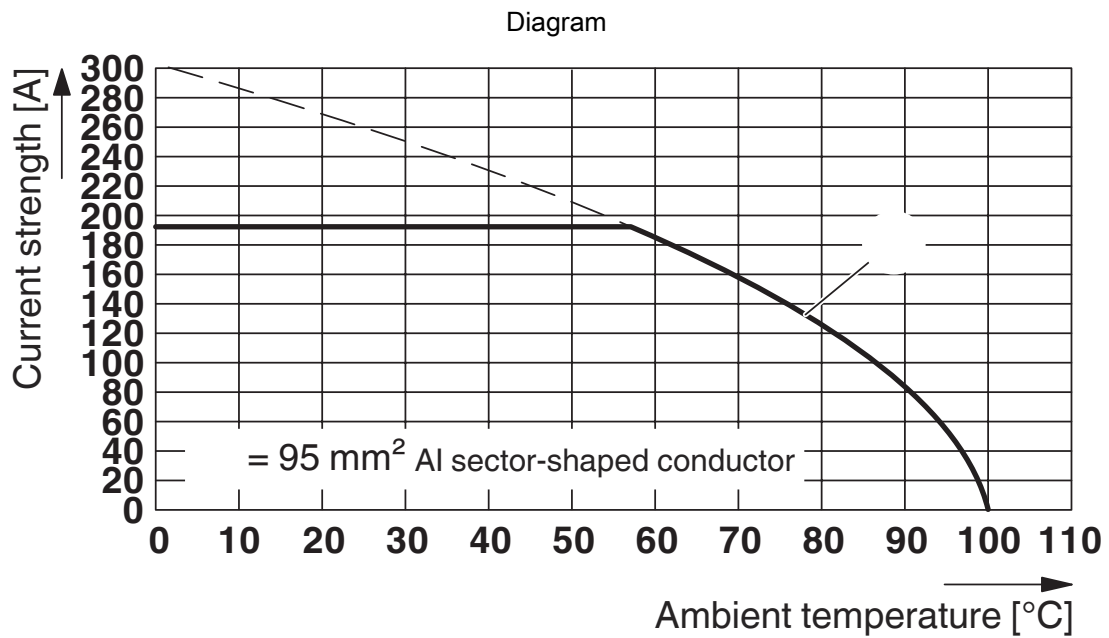

Type: TW 95/...-CL

Drilling plan/solder pad geometry

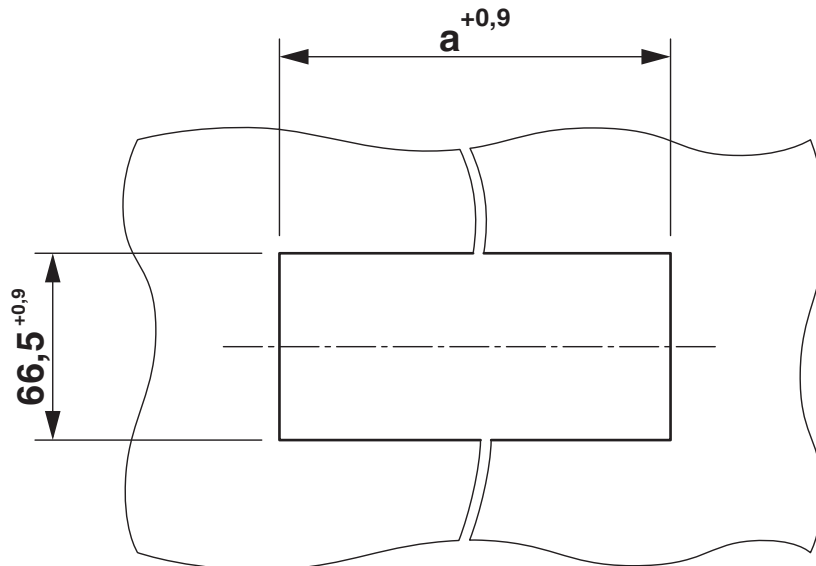

Dimension a = 35 mm

TW 95/ 1-CL - Panel feed-through terminal block



1708752

<https://www.phoenixcontact.com/us/products/1708752>

Approvals

To download certificates, visit the product detail page: <https://www.phoenixcontact.com/us/products/1708752>

|  cULus Recognized Approval ID: E60425-20160914 | | | | |
|---|-----------------------|-----------------------|-------------------|-----------------------------|
| | Nominal voltage U_N | Nominal current I_N | Cross section AWG | Cross section mm^2 |
| C | 600 V | 200 A | 4 - 3/0 | - |

|  VDE approval of drawings Approval ID: 40045667 | | | | |
|--|-----------------------|-----------------------|-------------------|-----------------------------|
| | Nominal voltage U_N | Nominal current I_N | Cross section AWG | Cross section mm^2 |
| keine | 1000 V | 232 A | - | 25 - 95 |

TW 95/ 1-CL - Panel feed-through terminal block



1708752

<https://www.phoenixcontact.com/us/products/1708752>

Classifications

ECLASS

| | |
|-------------|----------|
| ECLASS-13.0 | 27141134 |
| ECLASS-15.0 | 27141134 |

ETIM

| | |
|-----------|----------|
| ETIM 10.0 | EC001283 |
|-----------|----------|

UNSPSC

| | |
|-------------|----------|
| UNSPSC 21.0 | 39121400 |
|-------------|----------|

TW 95/ 1-CL - Panel feed-through terminal block



1708752

<https://www.phoenixcontact.com/us/products/1708752>

Environmental product compliance

EU RoHS

| | |
|---|--------------------|
| Fulfills EU RoHS substance requirements | Yes, No exemptions |
|---|--------------------|

China RoHS

| | |
|--|--|
| Environment friendly use period (EFUP) | EFUP-E |
| | No hazardous substances above the limits |

EU REACH SVHC

| | |
|-------------------------------------|----------------------------|
| REACH candidate substance (CAS No.) | No substance above 0.1 wt% |
|-------------------------------------|----------------------------|

Phoenix Contact 2026 © - all rights reserved
<https://www.phoenixcontact.com>

Phoenix Contact USA
586 Fulling Mill Road
Middletown, PA 17057, United States
(+717) 944-1300
info@phoenixcon.com