

# EV-GBM3SE12-1AC32A-2,0M6,0E10 - Infrastructure charging socket



1624387

<https://www.phoenixcontact.com/pc/products/1624387>

Please be informed that the data shown in this PDF document is generated from our online catalog. Please find the complete data in the user documentation. Our general terms of use for downloads are valid.



CHARX connect, GB/T, Infrastructure charging socket, 32 A , 250 V AC, length: 2 m, locking actuator: 12 V, 4-pos., Rear panel mounting, for charging electric vehicles with alternating current (AC), GB/T 20234.2-2015

## Product description

Infrastructure charging socket for charging electric vehicles (EV) with alternating current (AC), compatible with GB/T Infrastructure Plugs, for installation at charging stations for E-Mobility (EVSE)

## Your advantages

- Uniform, space-saving installation space of all Phoenix Contact Infrastructure Socket Outlets
- Silver-plated surface of the power and signal contacts
- Developed and produced in accordance with the IATF 16949 automotive standard and ISO 9001
- Manual emergency release of the locking actuator
- Material data available in the IMDS (International Material Data System of the automotive industry)
- Integrated interlock during charging

## Commercial data

|                                      |   |
|--------------------------------------|---|
| Item number                          | 1624387   |
| Packing unit                         | 1 pc  |
| Minimum order quantity               | 1 pc  |
| Product key                          | XWBADF  |
| GTIN                                 | 4055626275253   |
| Weight per piece (including packing) | 720 g   |
| Weight per piece (excluding packing) | 620 g   |
| Country of origin                    | Information on the country of origin is provided with the delivery. |

# EV-GBM3SE12-1AC32A-2,0M6,0E10 - Infrastructure charging socket



1624387

<https://www.phoenixcontact.com/pc/products/1624387>

## Technical data

### Product properties

|                     |                                |
|---------------------|--------------------------------|
| Product type        | Infrastructure charging socket |
| Product family      | CHARX connect                  |
| Charging standard   | GB/T                           |
| Charging mode       | Mode 3, Case B                 |
| Customer variations | On request                     |

### Electrical properties

|                               |  |
|-------------------------------|--|
| Type of signal transmission   | Pulse width modulation                   |
| Note on the connection method | Crimp connection, cannot be disconnected |

### Charging power and current (AC charging, 1-phase)

|                          |                   |
|--------------------------|-------------------|
| Type of charging current | AC single-phase   |
| Charging current         | 32 A AC (1-phase) |
| Charging power           | 8 kW              |
| Charging power rating    | 7.4 kW            |

### Pin assignment (Power contacts)

|               |               |
|---------------|---------------|
| Number        | 3 (L1, N, PE) |
| Rated voltage | 250 V AC      |
| Rated current | 32 A          |

### Pin assignment (Signal contacts)

|               |            |
|---------------|------------|
| Number        | 2 (CP, CC) |
| Rated voltage | 30 V AC    |
| Rated current | 2 A        |

### Locking actuator

|  |                     |
|--|---------------------|
| Locking actuator                         | 12 V, 4-pos.        |
|  | Top center position |
| Possible power supply range at the motor | 9 V ... 16 V        |
| Maximum voltage for locking detection    | 30 V                |
| Typical motor current for locking        | 0.2 A               |
| Reverse current of the motor             | max. 1 A            |
| Max. dwell time with reverse current     | 1000 ms             |
| Recommended adaptation time              | 600 ms              |
| Pause time after entry or exit path      | 3 s                 |
| Service life insertion cycles            | > 10000 load cycles |
| Lock recognition                         | available           |
| Mechanical emergency release             | available           |
| Ambient temperature (operation)          | -30 °C ... 50 °C    |
| Cable length                             | 0.5 m               |

# EV-GBM3SE12-1AC32A-2,0M6,0E10 - Infrastructure charging socket



1624387

<https://www.phoenixcontact.com/pc/products/1624387>

|                 |                         |
|-----------------|-------------------------|
| Cable structure | 4 x 0.5 mm <sup>2</sup> |
|-----------------|-------------------------|

## Cable/line

|                 |   |
|-----------------|---|
| Cable length    | 2 m (AC cables)                                   |
|                 | 0.5 m (Locking actuator cables)                   |
| Cable structure | 3 x 6.0 mm <sup>2</sup> + 2 x 0.5 mm <sup>2</sup> |

## Mechanical properties

### Mechanical data

|                             |         |
|-----------------------------|---------|
| Insertion/withdrawal cycles | > 10000 |
| Insertion force             | < 100 N |
| Withdrawal force            | < 100 N |

## Environmental and real-life conditions

### Ambient conditions

|   |                          |
|---|--------------------------|
| Ambient temperature (operation)         | -30 °C ... 50 °C         |
| Ambient temperature (storage/transport) | -40 °C ... 80 °C         |
| Altitude                                | 5000 m (above sea level) |

## Standards and regulations

### Standards

|                       |                   |
|-----------------------|-------------------|
| Standards/regulations | GB/T 20234.2-2015 |
|-----------------------|-------------------|

## Mounting

|  |   |
|--|---|
| Mounting type Infrastructure charging socket | Rear panel mounting (0 to 90 degree frontal inclination possible) |
| Mounting type Protective cover               | rear (available separately)                                       |
| Mounting hole diameter                       | 7.00 mm (ø)   |

# EV-GBM3SE12-1AC32A-2,0M6,0E10 - Infrastructure charging socket

1624387

<https://www.phoenixcontact.com/pc/products/1624387>

## Drawings

Dimensional drawing



Hole image

# EV-GBM3SE12-1AC32A-2,0M6,0E10 - Infrastructure charging socket

1624387

<https://www.phoenixcontact.com/pc/products/1624387>

Dimensional drawing

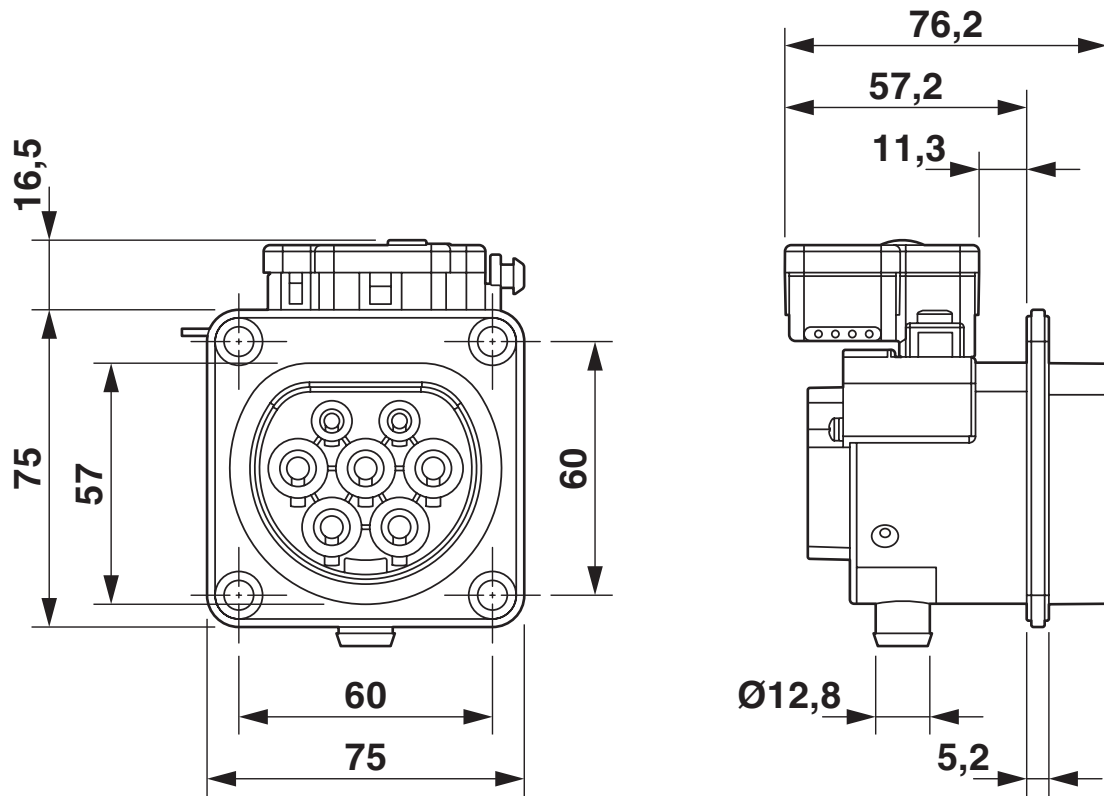

Dimensional drawing

# EV-GBM3SE12-1AC32A-2,0M6,0E10 - Infrastructure charging socket

1624387

<https://www.phoenixcontact.com/pc/products/1624387>

Connection diagram

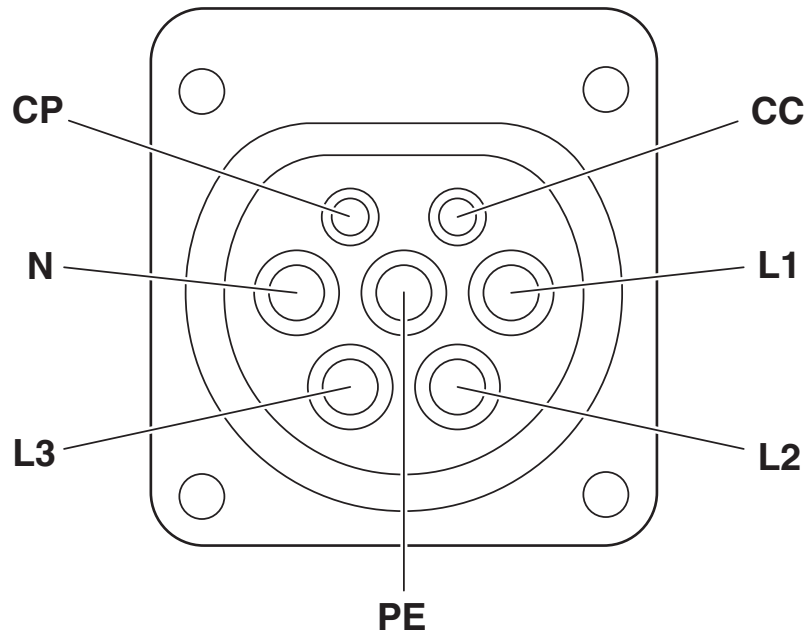

Pin assignment of infrastructure charging socket

Schematic diagram

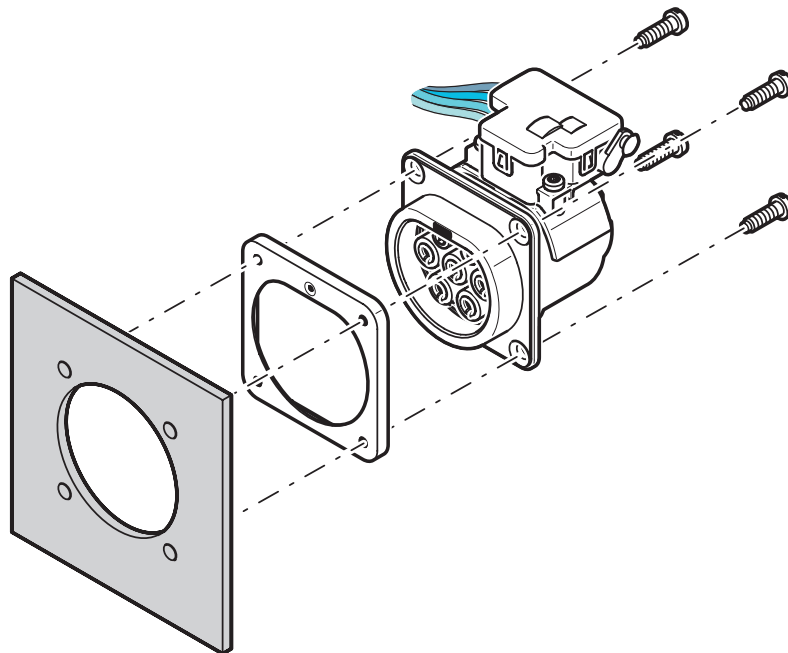

Rear mounting with locking actuator

# EV-GBM3SE12-1AC32A-2,0M6,0E10 - Infrastructure charging socket

1624387

<https://www.phoenixcontact.com/pc/products/1624387>

Schematic diagram

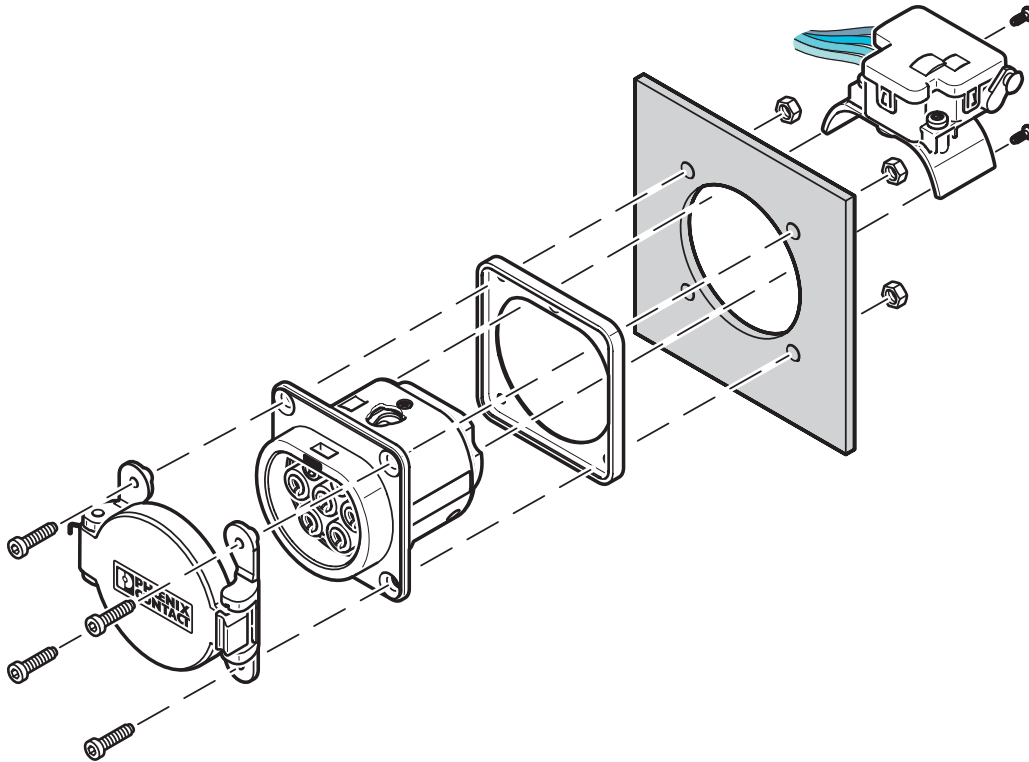

Front mounting with rear protective cover screw connection

Front mounting is only possible when the locking actuator is removed. The screw connection for a protective cover from the accessories range (EV-GBSC...) only supports rear mounting.

# EV-GBM3SE12-1AC32A-2,0M6,0E10 - Infrastructure charging socket

1624387

<https://www.phoenixcontact.com/pc/products/1624387>

## Schematic diagram

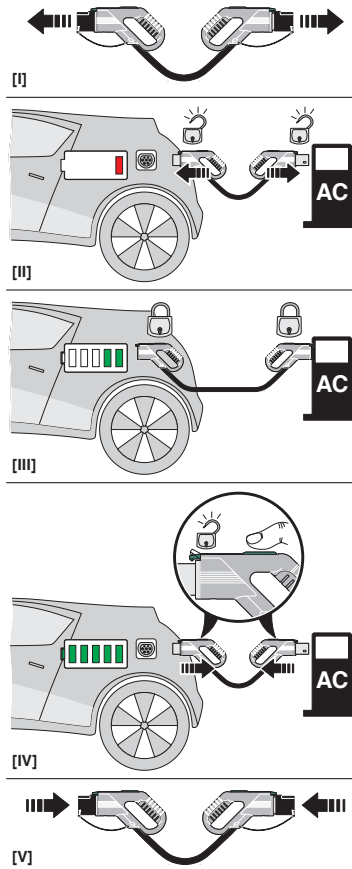

Operating instructions

# EV-GBM3SE12-1AC32A-2,0M6,0E10 - Infrastructure charging socket

1624387

<https://www.phoenixcontact.com/pc/products/1624387>

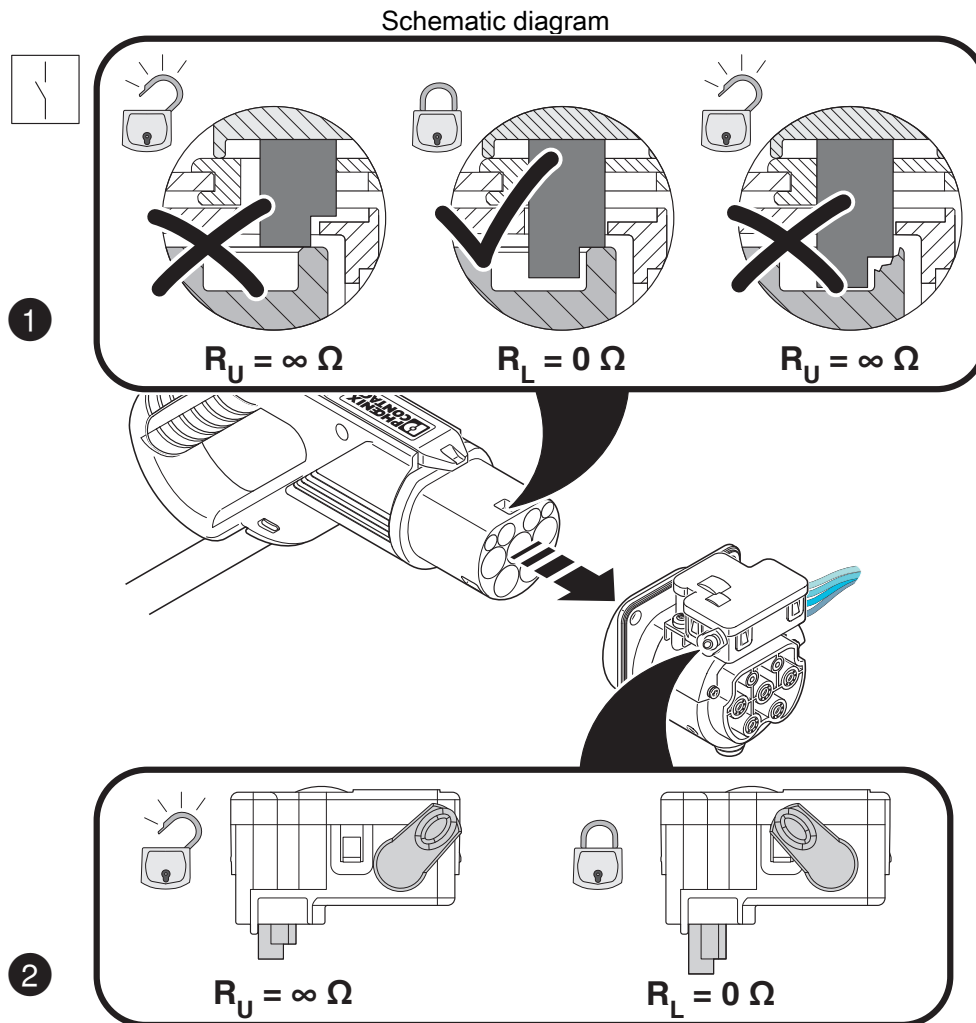

Detection of the Infrastructure Plug

Schematic diagram



Installation positions

# EV-GBM3SE12-1AC32A-2,0M6,0E10 - Infrastructure charging socket

1624387

<https://www.phoenixcontact.com/pc/products/1624387>

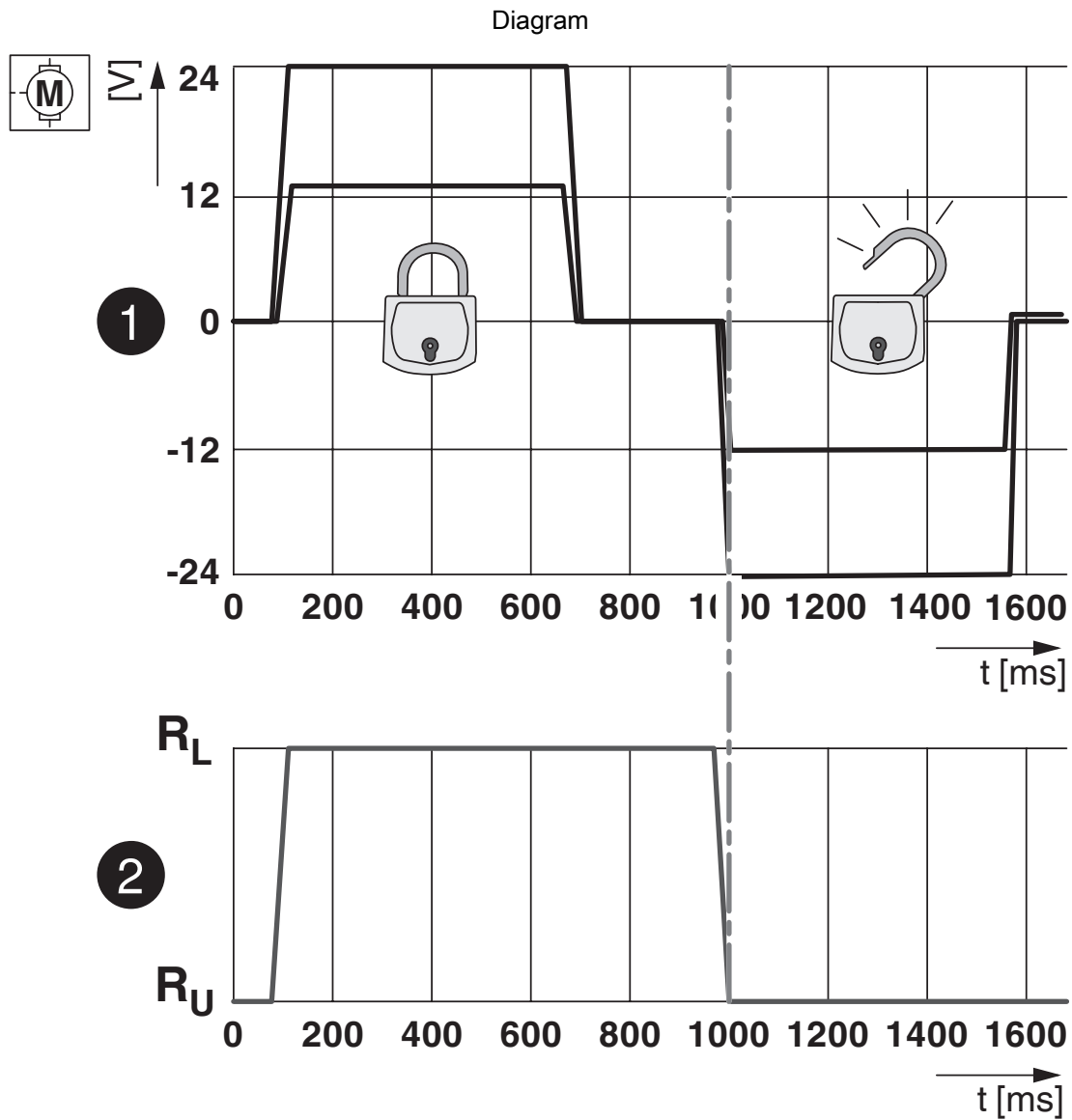

Locking states of the locking actuator

# EV-GBM3SE12-1AC32A-2,0M6,0E10 - Infrastructure charging socket

1624387

<https://www.phoenixcontact.com/pc/products/1624387>

Block diagram

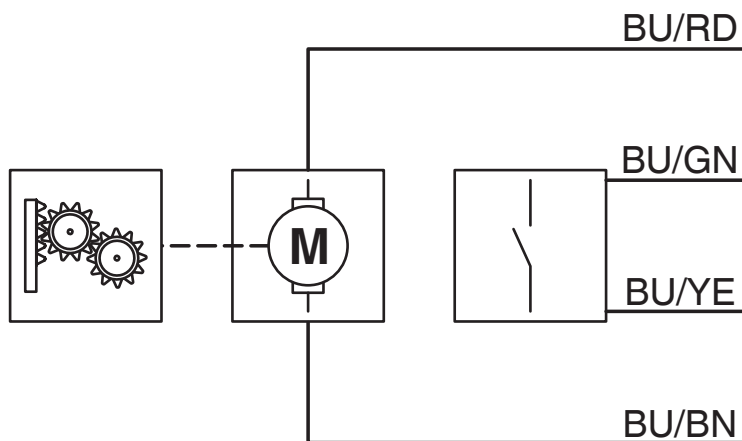

Block diagram of the locking actuator

# EV-GBM3SE12-1AC32A-2,0M6,0E10 - Infrastructure charging socket



1624387

<https://www.phoenixcontact.com/pc/products/1624387>

## Environmental product compliance

### China RoHS

|  |   |
|--|---|
| Environment friendly use period (EFUP) | EFUP-10   |
|  | An article-related China RoHS declaration table can be found in the download area for the respective article under "Manufacturer declaration". For all articles with EFUP-E, no China RoHS declaration table issued and required. |

### EU REACH SVHC

|                                     |                            |
|-------------------------------------|----------------------------|
| REACH candidate substance (CAS No.) | No substance above 0.1 wt% |
|-------------------------------------|----------------------------|

Phoenix Contact 2026 © - all rights reserved  
<https://www.phoenixcontact.com>

PHOENIX CONTACT GmbH & Co. KG  
Flachsmarktstraße 8  
D-32825 Blomberg  
+49 (0) 5235-3 00  
[info@phoenixcontact.com](mailto:info@phoenixcontact.com)