

# C-FCI 6/M8 - Fork-type cable lug

3240045

<https://www.phoenixcontact.com/gb/products/3240045>

Please be informed that the data shown in this PDF document is generated from our online catalog. Please find the complete data in the user documentation. Our general terms of use for downloads are valid.



Fork-type cable lug, yellow, 4 - 6 mm<sup>2</sup>, M8

## Your advantages

- The fork-type cable lugs without plastic sleeve feature a hard-soldered neck. In conjunction with the CRIMPFOX-RC ... and CRIMPFOX-RCI ... pliers they can be used to achieve maximum conductor pull-out forces
- The insulated versions are halogen-free and feature "EASY ENTRY" technology

## Commercial data

|                                      |               |
|--------------------------------------|---------------|
| Item number                          | 3240045       |
| Packing unit                         | 25 pc         |
| Minimum order quantity               | 100 pc        |
| Sales key                            | BH3441        |
| Product key                          | BH3441        |
| GTIN                                 | 4046356452625 |
| Weight per piece (including packing) | 2.4 g         |
| Weight per piece (excluding packing) | 2.327 g       |
| Customs tariff number                | 85369010      |
| Country of origin                    | CN            |

# C-FCI 6/M8 - Fork-type cable lug

3240045

<https://www.phoenixcontact.com/gb/products/3240045>

## Technical data

### Product properties

|                  |                          |
|------------------|--------------------------|
| Product type     | Connector                |
| Product property | With "Easy Entry" system |
|                  | Brazed                   |
|                  | PA-insulated             |

### Dimensions

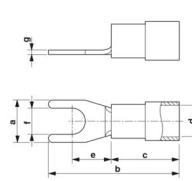
|  |  |
|--|--|
| Dimensional drawing  |  |
| Width  | 13.5 mm  |
| Sleeve length  | 32.6 mm  |
| Length of the insulating material sleeve                   | 14 mm  |
| Maximum stripping length                                   | 9 mm   |
| Distance from the center to the insulating material sleeve | 11.5 mm  |
| Min. material thickness                                    | 1 mm   |
| Inner dimensions of the insulating collar                  | 6.6 mm   |

### Internal dimensions

|                   |        |
|-------------------|--------|
| Internal diameter | 8.5 mm |
|-------------------|--------|

### Material specifications

|  |                   |
|--|-------------------|
| Color                                  | yellow (RAL 1018) |
| Material                               | Copper            |
| Flammability rating according to UL 94 | V2                |
| Coating                                | tin-plated        |
| Insulating material                    | PA                |
| Components                             | halogen-free      |

### Mechanical properties

#### Technical data

|               |         |
|---------------|---------|
| Sleeve length | 32.6 mm |
|---------------|---------|

# C-FCI 6/M8 - Fork-type cable lug

3240045

<https://www.phoenixcontact.com/gb/products/3240045>



## Drawings

Dimensional drawing

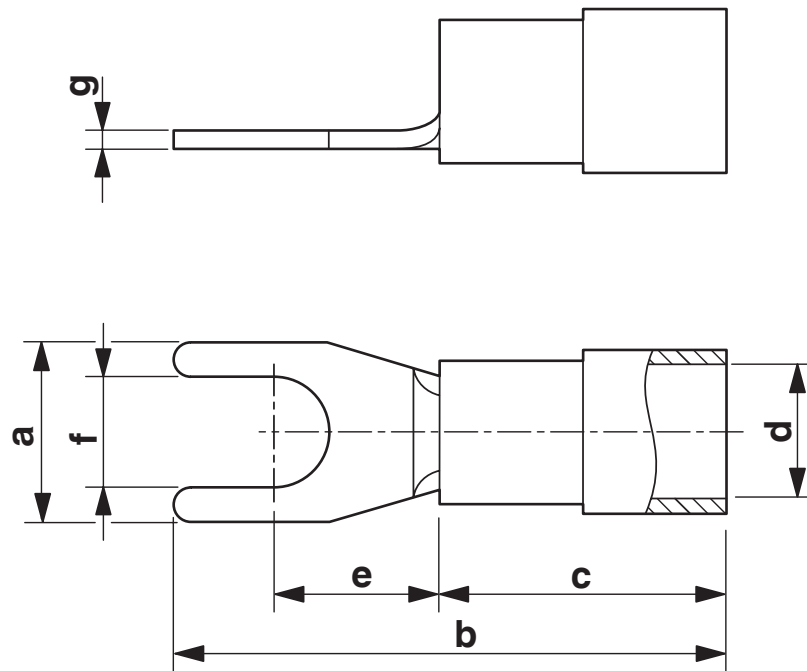

# C-FCI 6/M8 - Fork-type cable lug



3240045

<https://www.phoenixcontact.com/gb/products/3240045>

## Classifications

### ECLASS

|             |          |
|-------------|----------|
| ECLASS-13.0 | 27400204 |
| ECLASS-15.0 | 27400204 |

### ETIM

|           |          |
|-----------|----------|
| ETIM 10.0 | EC001052 |
|-----------|----------|

### UNSPSC

|             |          |
|-------------|----------|
| UNSPSC 21.0 | 27121700 |
|-------------|----------|

# C-FCI 6/M8 - Fork-type cable lug



3240045

<https://www.phoenixcontact.com/gb/products/3240045>

## Environmental product compliance

### EU RoHS

|   |                    |
|---|--------------------|
| Fulfills EU RoHS substance requirements | Yes, No exemptions |
|---|--------------------|

### China RoHS

|  |  |
|--|--|
| Environment friendly use period (EFUP) | EFUP-E                                   |
|  | No hazardous substances above the limits |

### EU REACH SVHC

|                                     |                            |
|-------------------------------------|----------------------------|
| REACH candidate substance (CAS No.) | No substance above 0.1 wt% |
|-------------------------------------|----------------------------|

### EF3.1 Climate Change

|         |               |
|---------|---------------|
| CO2e kg | 0.047 kg CO2e |
|---------|---------------|

Phoenix Contact 2026 © - all rights reserved  
<https://www.phoenixcontact.com>

PHOENIX CONTACT Ltd  
Halesfield 13, Telford  
Shropshire, TF7 4PG  
01952 681700  
[info@phoenixcontact.co.uk](mailto:info@phoenixcontact.co.uk)